

# Pella® Defender Series™



## Vinyl

Designed to weather the storm, engineered to protect what matters most.



- **Simplified storm protection**  
Give your customer peace of mind with simplified hurricane protection. Pella Defender Series window designs are ready for whenever the storm strikes. Engineered and tested to withstand hurricane conditions and increasingly stringent coastal requirements, they help protect your customer's home.
- **Reliable, everyday performance**  
With laminated glass, Pella Defender Series windows provide noise reduction, exceptional energy efficiency and protection from intruders. Laminated, insulating glass blocks nearly 100% of UV rays, helping protect carpet and window treatments from fading.
- **Impact and laminated glass**  
Laminated glass uses a strong polymer interlayer to help reinforce the window. The interlayer holds the glass together if it's shattered – helping prevent damage and injury that can be caused by wind, water and debris entering your home.
- **Intentional frame design**  
Our windows feature up to 18 insulating air chambers for exceptional energy efficiency and comfort, automatically locking hardware on single-hung, double-hung and sliding windows, and thick vinyl walls for added structural integrity.
- **Precise installation**  
Keep your project and inspections on schedule with the precise installation frame design of Pella Defender Series windows. Our products arrive with installation holes pre-drilled into the frame for quicker installation.
- **Endures harsh conditions**  
Our exclusive vinyl formula uses high-grade resins and additives for excellent weathering, durability and color retention.
- **Noise reduction**  
From the roar of the storm to barking dogs and traffic, Pella Defender Series windows reduce more sound than non-laminated single-pane windows.
- **Tested to endure with accelerated environmental testing**  
We test samples of our materials and components of our products by placing them in conditions to mimic the intensity of Florida's sun and above average humidity.
- **ENERGY STAR® certified**  
Pella offers energy-efficient options that will meet or exceed ENERGY STAR® guidelines in Florida and beyond.<sup>1</sup>
- **Backed by one of the strongest limited lifetime warranties**  
You can feel confident in your investment. That's why we stand behind all of our products with a limited lifetime warranty.<sup>2</sup>

Available in these window styles:



Special shape windows also available.

<sup>1,2</sup> See back cover for disclosures.

<sup>1</sup> Some Pella products may not meet ENERGY STAR® guidelines in Canada. For more information, contact your local Pella sales representative or go to [energystar.gc.ca](http://energystar.gc.ca).  
<sup>2</sup> See written limited warranties for complete details, including exceptions and limitations, at [pella.com/warranty](http://pella.com/warranty), or contact Pella Customer Service.  
<sup>3</sup> Annealed and tempered glass strengths available. Tempered in bottom sash available on single-hung windows only.  
<sup>4</sup> Warning: Screen will not stop child or pet from falling out of window or door. Keep child or pet away from open window or door.  
<sup>5</sup> Improved airflow is based on calculated screen cloth openness. Screen cloth transmittance was measured using an integrated sphere spectrophotometer.

## Product Specifications

Window Styles	Min. Width	Min. Height	Max. Width	Max. Height	Design Pressure	Performance Values			
						U-Factor	SHGC	HVHZ	FL #
Single-Hung	17.875"	24.75"	53.125"	76"	+/-35 - +/-58	.25-.54	.13-.61	No	17235, 17792
Double- Hung	17.875"	28.75"	53.125"	76"	+/-45 - +/-58	.31-.52	.12-.56	No	17822, 17234, 17791, 18148
Sliding	26.5"	18"	111"	72"	+/-38 - +/-58	No	No	No	17355, 17793
Direct Set	12"	12"	68"	96"	+/-46 - +/-58	No	No	No	17354, 17794
Special Shapes	8"	12"	68"	96"	+/-46 - +/-58	No	No	No	17354, 17794

Window sizes available in 1/8" increments

Special shapes available. For more information regarding performance, specific sizes, glazings tested and frame and installation types, visit pella.com.

## Grilles

Grilles are color-matched to the interior and exterior frame color.

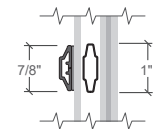

**7/8" Contour Exterior Applied Grille with 1" Contour Grilles-Between-the-Glass**

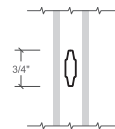

**3/4" or 1" Contour Grilles-Between-the-Glass**

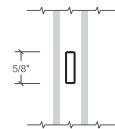

**5/8" Flat Grilles-Between-the-Glass**

## Window Hardware

### Sliding, Single-Hung & Double-Hung

Automatically locking hardware comes standard on your single-hung, double-hung and sliding windows. When you close the window, they automatically lock to help keep your customer's home more secure.

AutoLock



AutoLock

**Color-Matched Finishes:**

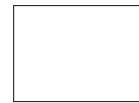

White



Bronze

## Colors

### Frame Colors

Create a signature look with solid-color and dual-color frames. Made with our performance-tested, exclusive vinyl formula, your customer won't have to paint, stain or refinish their windows.

**Solid Color Frame:**



White



Bronze

**Dual-Color Frame:**



White interior with Bronze exterior

## Glass

### Types<sup>3</sup>

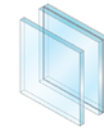

Non-impact laminated glass

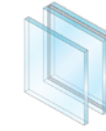

Impact-resistant, laminated glass

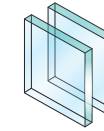

Dual-pane, non-laminated glass

### InsulShield® Low-E Glass

Advanced Low-E insulating standard, laminated or impact-resistant dual-pane glass with argon

Coastal Low-E insulating standard, laminated or impact-resistant dual-pane glass with argon

SunDefense™ Low-E insulating standard, laminated or impact-resistant dual-pane glass with argon

### Obscure Glass Styles

Frosted with Neat Low-E insulating dual-pane glass

Obscure with Neat Low-E dual-pane insulating glass

### Insulated Glass Options

Low-E insulated glass

Neat® Low-E insulated glass

Bronze insulated glass

Gray insulated glass

Blue insulated glass

## Screens<sup>4</sup>

### Flat

InView™ screens are clearer than conventional screens and come standard. InView screens let in 14% more light and are 8% more open for improved airflow compared to conventional screens.<sup>5</sup> Screen frame is color-matched to the window.