

**8300 PVC
PICTURE WINDOW
IMPACT**

| NO.: | DESCRIPTION: | BY: | DATE: |
|------|-----------------|-----|----------|
| A | 2014 FBC UPDATE | TEF | 03/31/15 |

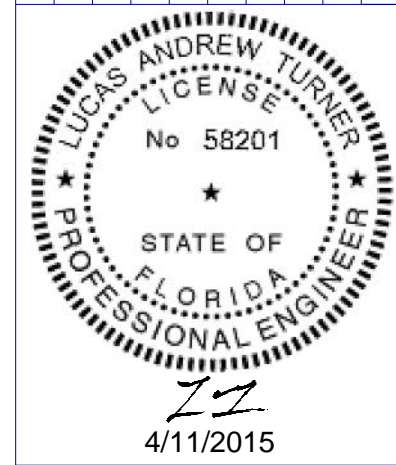

LUCAS A. TURNER, P.E.
FL PE # 58201
1239 JABARA AVE.
NORTH PORT, FL 34288
PH. 941-380-1574

SHEET DESCRIPTION:
**SECTION VIEWS AND
GLAZING DETAIL**

| | |
|-----------|----------|
| DRAWN BY: | DATE: |
| EMK | 10/07/14 |
| DWG #: | REV.: |
| CWS-1033 | A |
| SCALE: | SHEET |
| 1:1.33 | 3 OF 6 |

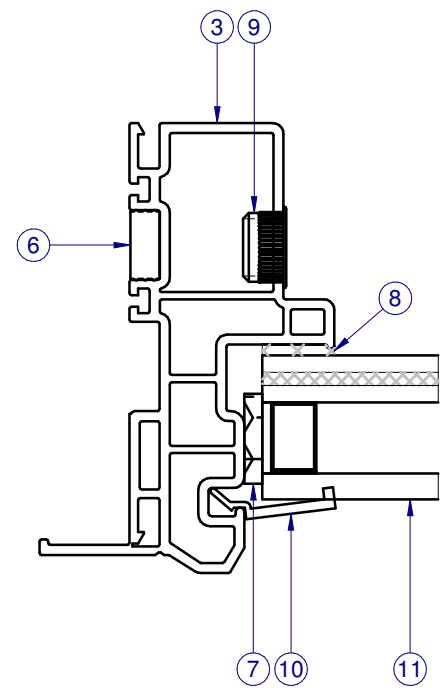

INTERIOR

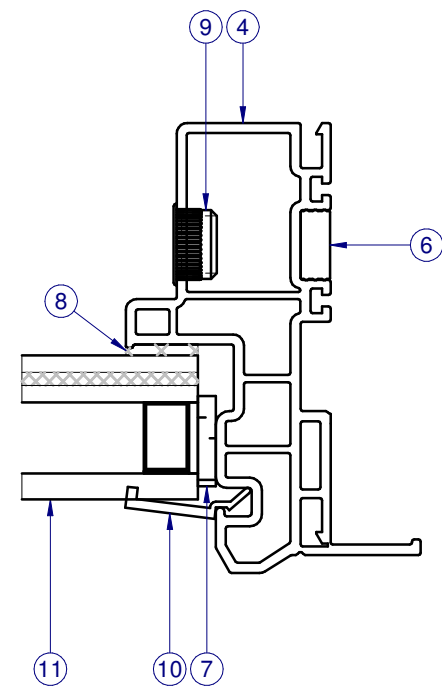

SECTION VIEW B-B

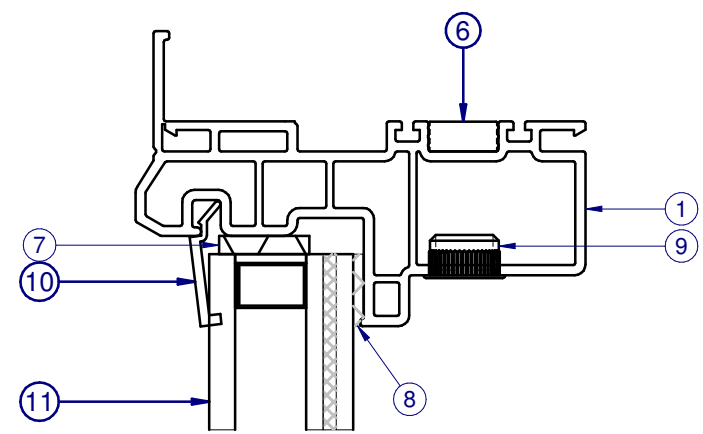

INTERIOR

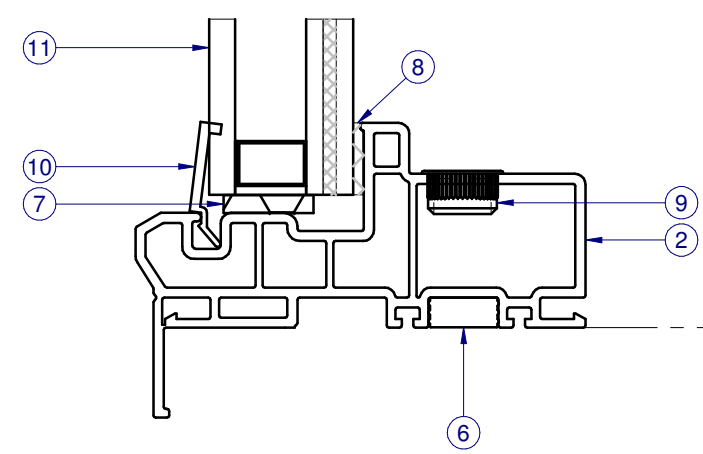

SECTION VIEW A-A

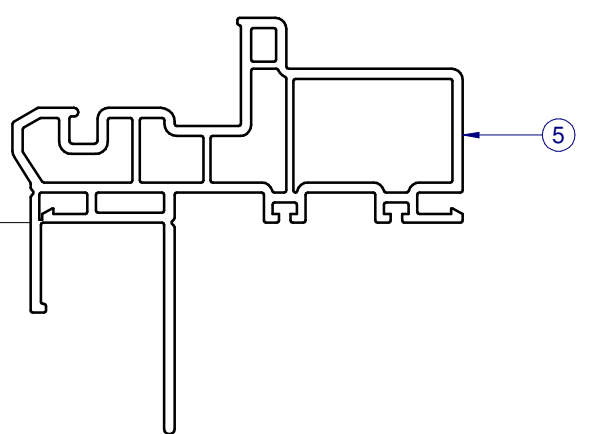

ALTERNATE FIN FRAME

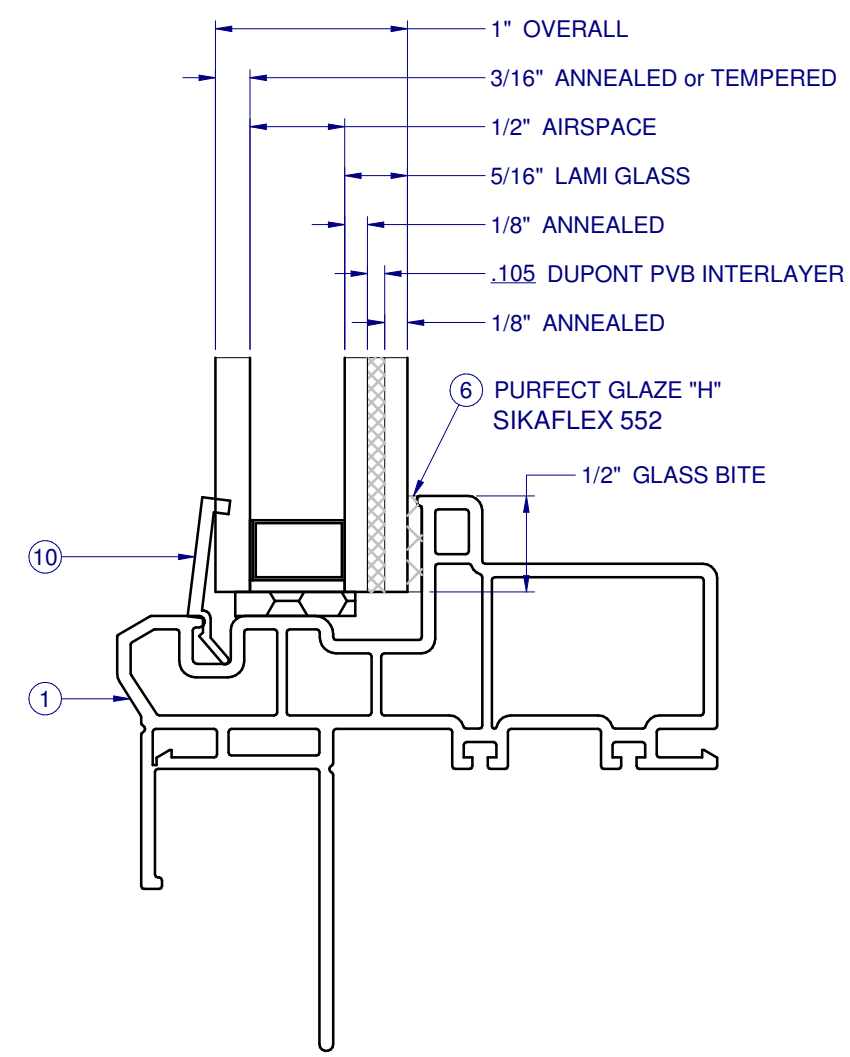

1:1

PARTS LIST

| ITEM | PART # | DESCRIPTION | VENDOR | MATERIAL |
|------|---------|--|---------------|----------|
| 1 | H-6006B | FRAME, PW, MAIN, HEAD | MIKRON | PVC |
| 2 | H-6006B | FRAME, PW, MAIN, SILL | MIKRON | PVC |
| 3 | H-6006B | FRAME, PW, MAIN, L. JAMB | MIKRON | PVC |
| 4 | H-6006B | FRAME, PW, MAIN, R. JAMB | MIKRON | PVC |
| 5 | H-6006A | FRAME, PW, MAIN, FIN | MIKRON | PVC |
| 6 | P-3113 | SCREW SUPPORT FOR PVC | TEAM PLASTIC | RUBBER |
| 7 | P-3352 | SET. BLK., 85 DUR., 1/8" x 5/8" x 2" LG. | FRANK LOWE | RUBBER |
| 8 | | PURFECT GLAZE "H", SIKAFLEX 552 | HENKEL / SIKA | SILICONE |
| 9 | P-3752 | CAP PLUG, 1/2" HOLE | M&M | SILICONE |
| 10 | S-6064 | GLZ. BE., FXD. (1" O.A. I.G.) | MIKRON | PVC |
| 11 | GLASS | SEE SHEET 3 | | |

FRAME CORNER CONSTRUCTION

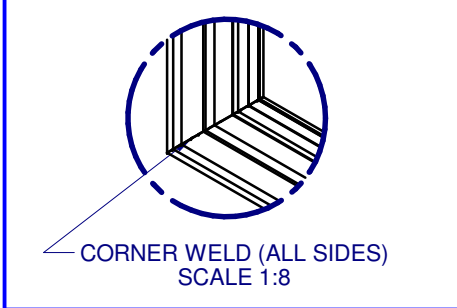

Custom
WINDOW SYSTEMS
1900 SW 44TH AVE.
OCALA, FLORIDA 34474
WWW.CWS.CC

**8300 PVC
PICTURE WINDOW
IMPACT**

| NO. | DESCRIPTION | BY | DATE |
|-----|-----------------|-----|----------|
| A | 2014 FBC UPDATE | TEF | 03/31/15 |

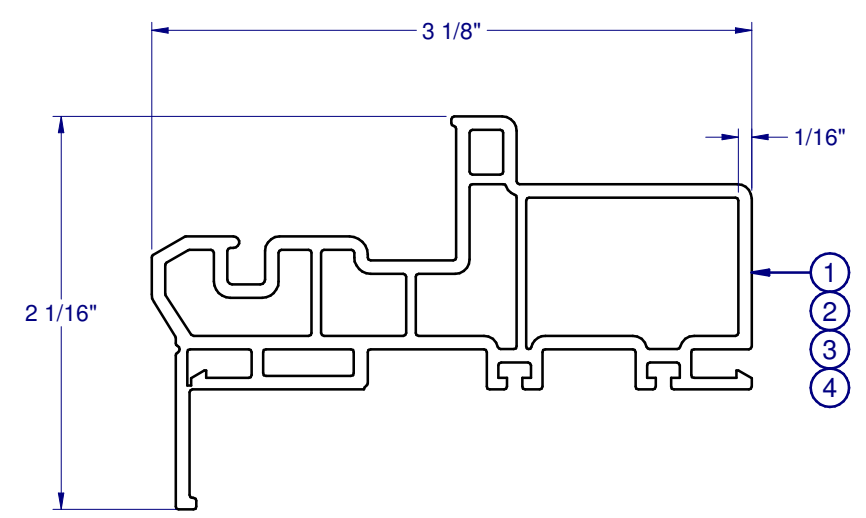

PVC FRAME FLANGE - H-6006B

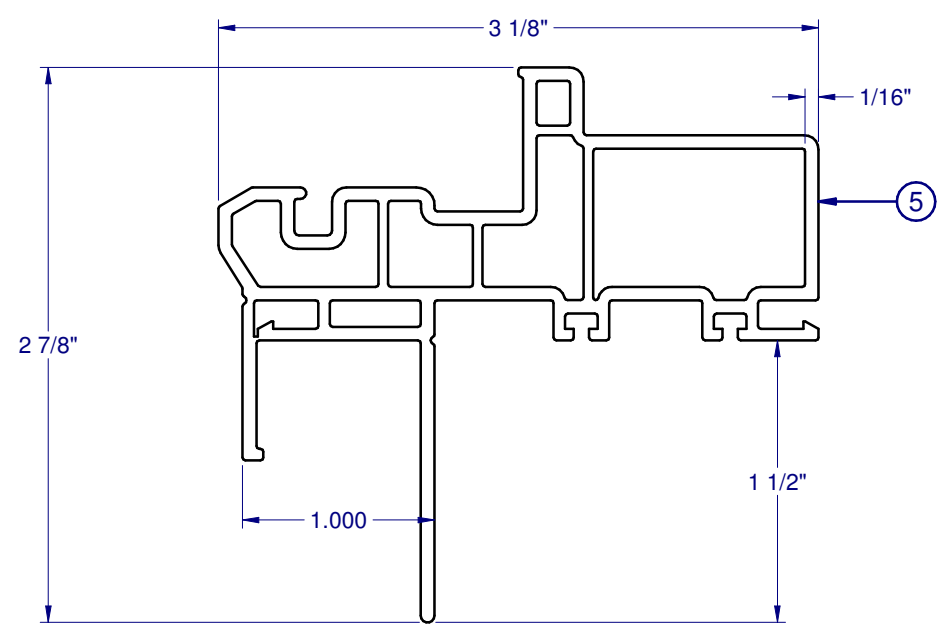

PVC FRAME FIN - H-6006A

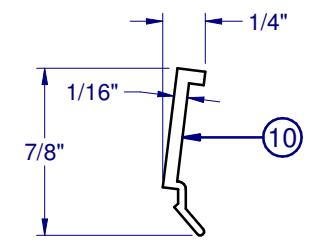

PVC GLAZE BEAD - S-6064

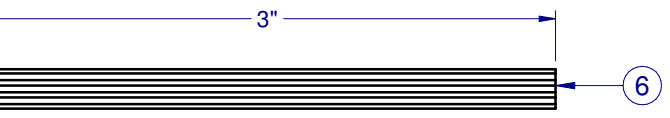
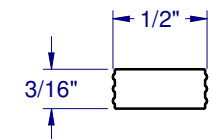

SCREW SUPPORT - P-3113

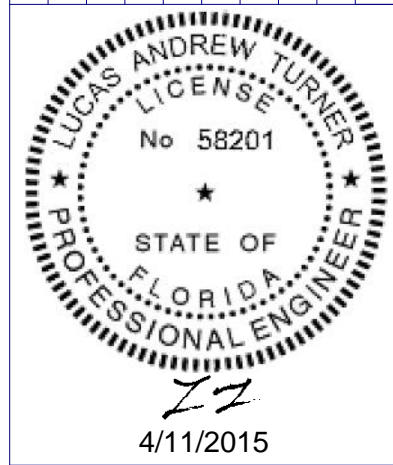

LUCAS A. TURNER, P.E.
FL PE # 58201
1239 JABARA AVE.
NORTH PORT, FL 34288
PH. 941-380-1574

SHEET DESCRIPTION:
BOM AND EXTRUSIONS

| | |
|-----------|----------|
| DRAWN BY: | DATE: |
| EMK | 10/07/14 |
| DWG #: | REV.: |
| CWS-1033 | A |
| SCALE: | SHEET |
| 1:1 | 4 OF 6 |

**8300 PVC
PICTURE WINDOW
IMPACT**

| NO. | DESCRIPTION | BY | DATE |
|-----|-----------------|-----|----------|
| A | 2014 FBC UPDATE | TEF | 03/31/15 |

REVISIONS



LUCAS A. TURNER, P.E.
FL PE # 58201
1239 JABARA AVE.
NORTH PORT, FL 34288
PH. 941-380-1574

SHEET DESCRIPTION:

INSTALLATION DETAILS

| | |
|-----------|----------|
| DRAWN BY: | DATE: |
| EMK | 10/07/14 |
| DWG #: | REV.: |
| CWS-1033 | A |
| SCALE: | SHEET |
| 1:2 | 6 OF 6 |

TYPICAL HEAD ANCHORAGE

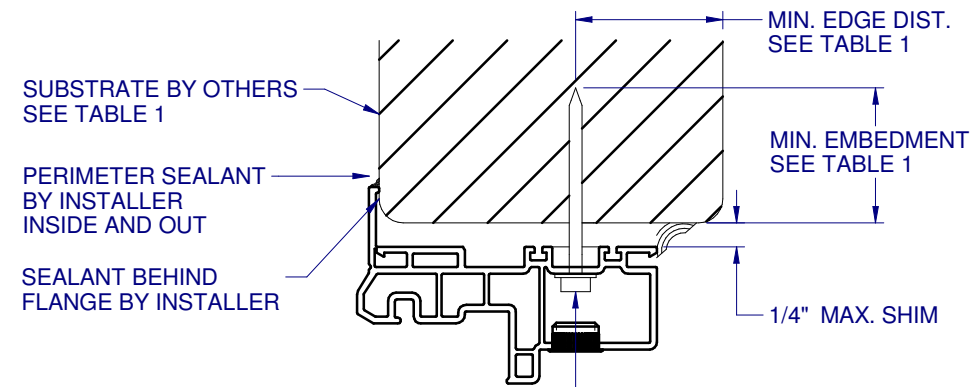

INSTALLATION ANCHOR
SEE TABLE 1

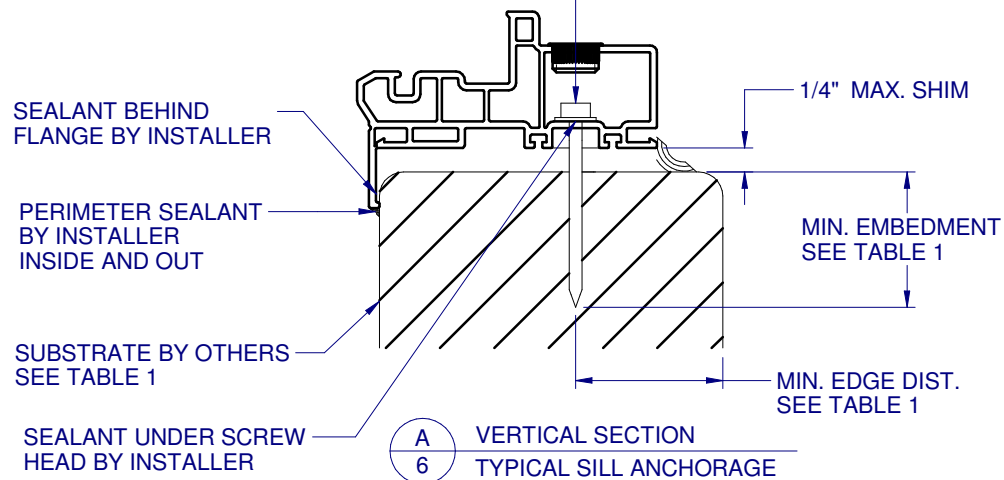

A
6 VERTICAL SECTION
TYPICAL SILL ANCHORAGE

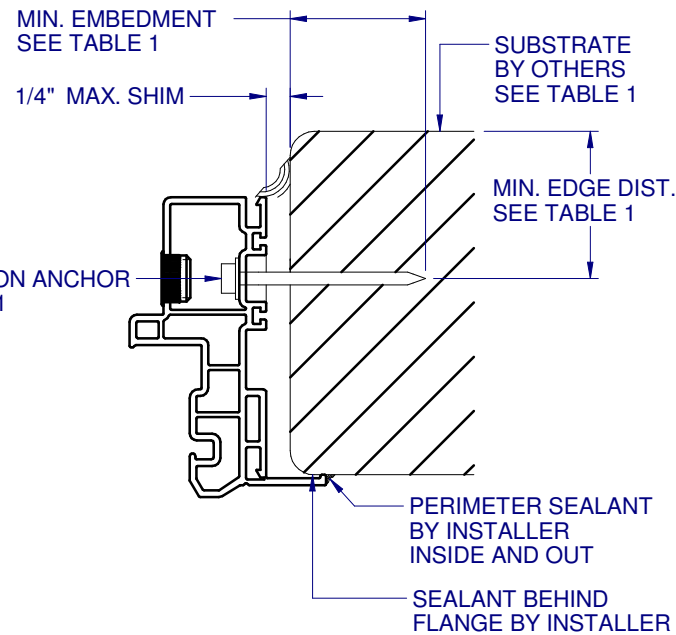

B
6 HORIZONTAL SECTION
TYPICAL JAMB ANCHORAGE

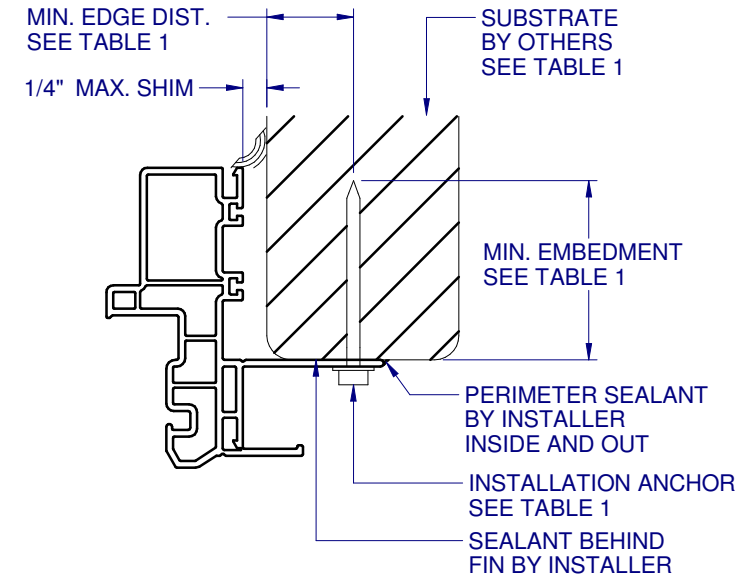

C
6 HORIZONTAL SECTION
TYPICAL FIN ANCHORAGE
HEAD AND SILL SIMILAR FOR FIN INSTALLATION

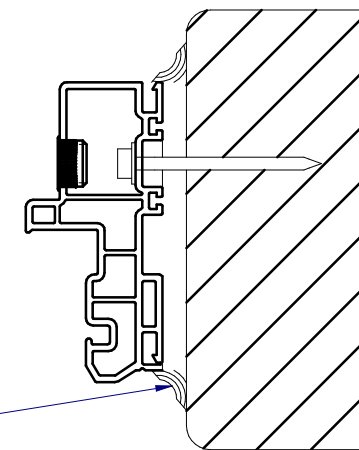

D
6 HORIZONTAL SECTION
BOX FRAME INSTALLATION
HEAD AND SILL SIMILAR FOR BOX INSTALLATION

FLANGE REMOVAL NOTE: PARTIALLY OR FULLY REMOVING THE FLANGE, UP TO AND INCLUDING A BOX-FRAME APPLICATION IS ACCEPTABLE PROVIDED:

- MIN. 1/4" FILLET OF CONSTRUCTION-GRADE ADHESIVE CAULK IS APPLIED INSIDE AND OUT, FULL PERIMETER, BY INSTALLER.
- PRODUCT ANCHORAGE IS IN ACCORDANCE WITH REQUIREMENTS AS SHOWN FOR FLANGE WINDOWS.

TABLE 1: APPROVED INSTALLATION FASTENERS

| FRAME TYPE | SUBSTRATE TYPE | ANCHOR TYPE | MIN. EMBEDMENT | MIN. EDGE DIST. |
|------------|---|--|-------------------------|-----------------|
| FLANGE | CONCRETE (2.0 KSI MIN.) | 3/16" ITW TAPCON | 1-1/2" | 1-1/8" |
| FLANGE | HOLLOW OR GROUT-FILLED CMU (117 PCF MIN.) | 3/16" ITW TAPCON | 1" | 2" |
| FLANGE | CONCRETE (2.85 KSI MIN.) | 3/16" ELCO ULTRACON | 1" | 1" |
| FLANGE | GROUT-FILLED CMU (ASTM C-90) | 3/16" ELCO ULTRACON | 1-1/4" | 2-1/2" |
| FLANGE | 2X MIN. SOUTHERN PINE (G=0.55) | 3/16" ITW TAPCON OR ELCO ULTRACON | 1-3/8" | 7/8" |
| FLANGE | 2X MIN. SOUTHERN PINE (G=0.55) | #10 WOOD SCREW | 1-3/8" | 7/8" |
| FLANGE | 16 GAUGE (0.060") MIN. STEEL STUD (33 KSI YIELD MIN) | #10-16 HILTI KWIK-FLEX OR ITW TEKS SELF-DRILLING SCREW | FULL THREAD THRU 0.060" | 7/16" |
| FLANGE | 1/8" ALUM. (6063-T5 MIN.) OR 1/8" STEEL (33 KSI MIN.) | #10 GRADE 5 SELF-TAPPING / DRILLING SCREW | FULL THREAD THRU 0.125" | 7/16" |
| FIN | 2X MIN. SOUTHERN PINE (G=0.55) | #8 WOOD SCREW | 1-1/2" | 7/16" |