

# HORIZONTAL SLIDER - NON-IMPACT

(SHOWN W/ DIFFERENT OPTIONS)

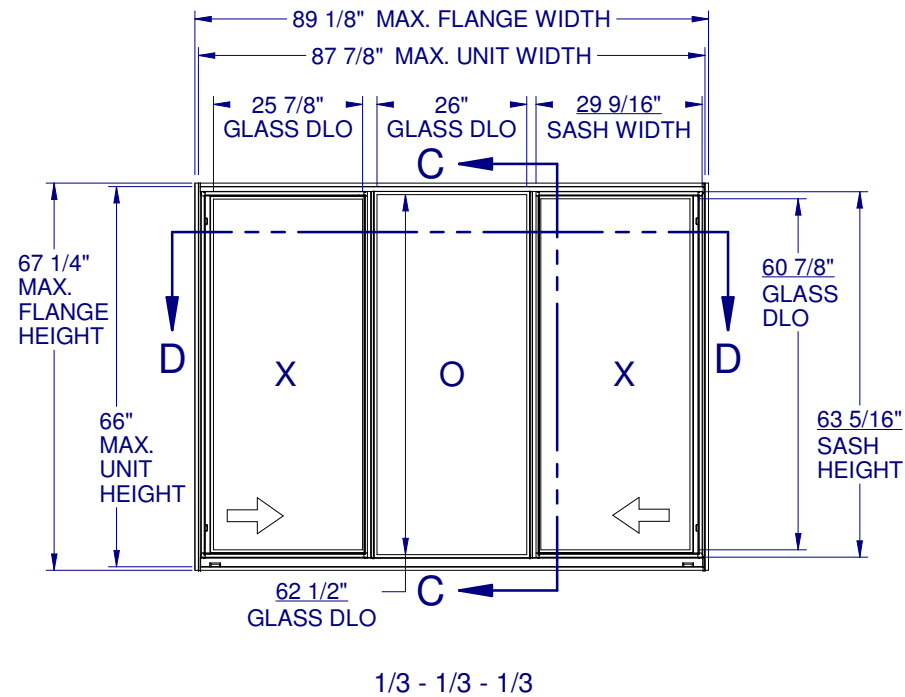
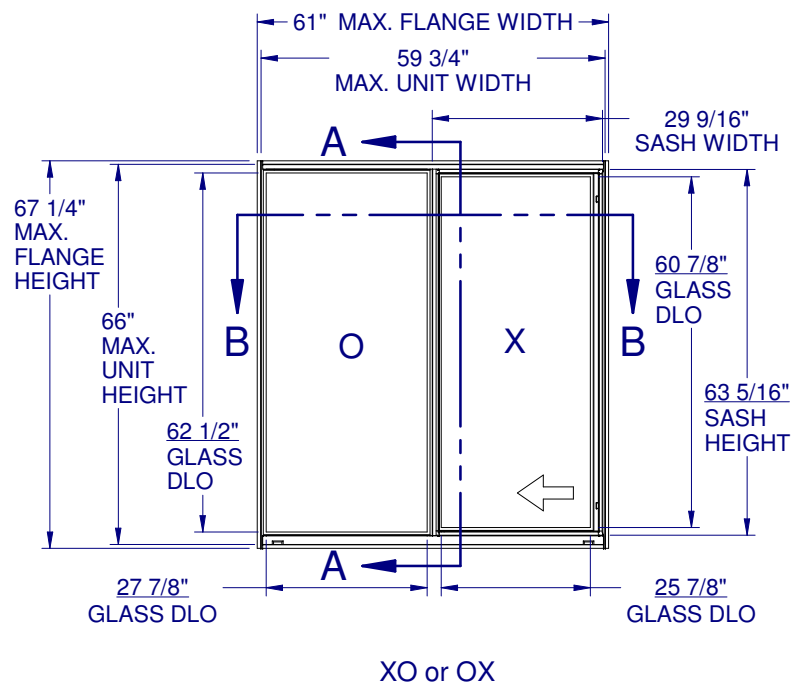
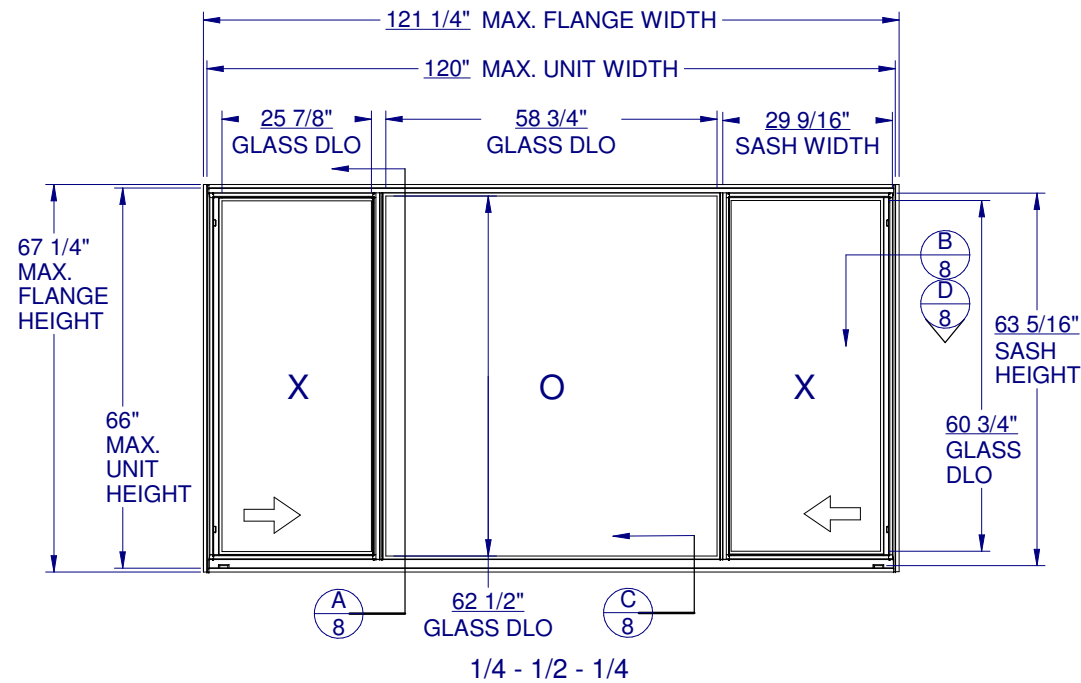
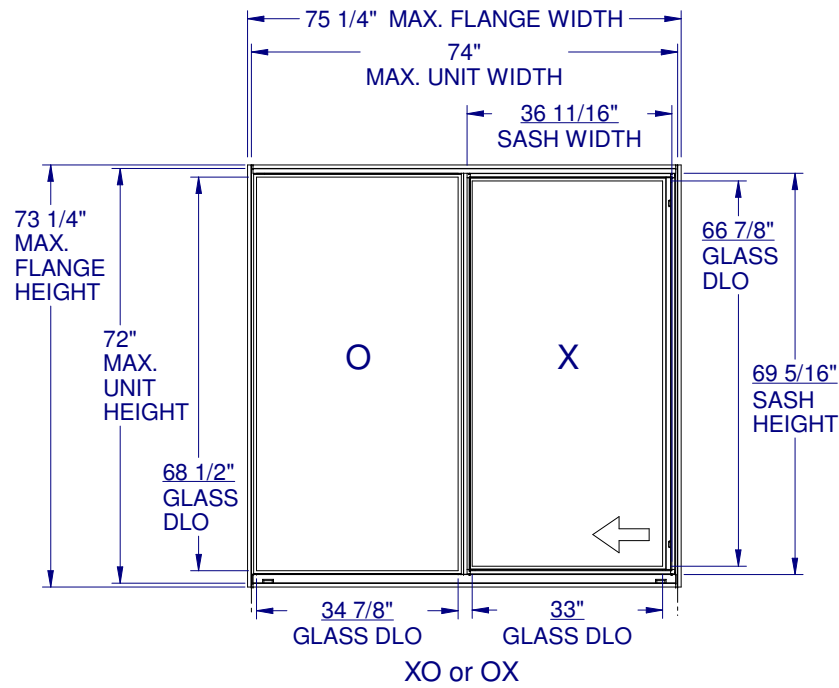

## GENERAL NOTES:

1. THE PRODUCT SHOWN HEREIN IS DESIGNED AND MANUFACTURED TO COMPLY WITH THE FLORIDA BUILDING CODE (FBC), CURRENT EDITION.
2. GLAZING OPTIONS: (SEE SHEET 2)
3. CONFIGURATIONS: "OX", "XO", "XOX".
4. DESIGN PRESSURE RATING:  
-NEGATIVE DESIGN LOADS BASED ON TESTED PRESSURE AND GLASS TABLES ASTM E-1300-04.  
-POSITIVE DESIGN LOADS BASED ON TESTED PRESSURE, WATER INFILTRATION TEST PRESSURE AND GLASS TABLES ASTM E-1300-04.
5. ANCHORAGE: THE 33 1/3% STRESS INCREASE HAS NOT BEEN USED IN THE DESIGN OF THIS PRODUCT. SEE SHEET 8 FOR INSTALLATION DETAILS.
6. NOT APPROVED FOR IMPACT RESISTANCE. IMPACT PROTECTIVE SYSTEM IS REQUIRED IN WIND BORNE DEBRIS REGION.
7. ALL FRAMES AND VENTS SCREWED TOGETHER. SMALL JOINT SEAM SEALANT USE AT ALL FRAME JOINTS.
8. SERIES / MODEL DESIGNATION HS-7000.
9. THE DESIGNATION X AND O STAND FOR THE FOLLOWING:  
X = OPERABLE SASH, O = FIXED SASH.
10. SECTION CALLOUTS FROM ELEVATIONS APPLY TO ALL ELEVATIONS IN A SIMILAR LOCATION.
11. WEEP SLOTS = 1/4" X 1" LOCATED 3-1/2" FROM BOTH ENDS.



1900 SW 44TH AVE.  
OCALA, FLORIDA 34474  
WWW.CWS.CC

## 7000 ALUM. HORZ. SLIDER NON-IMPACT

NO.:	DESCRIPTION:	BY:	DATE:
C	UPDATED PER 2014 FBC	EMK	03/11/15
B	ADDED DP 35 OX	EMK	08/06/14
A	UPDATED PER 2010 FBC	BAT	10/14/11

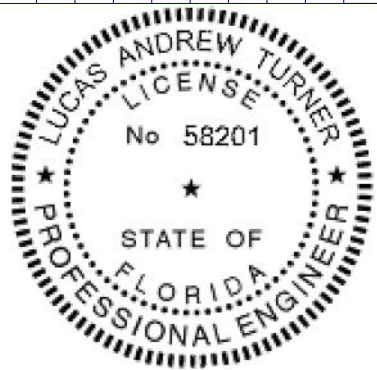

12  
4/3/2015

LUCAS A. TURNER, P.E.  
FL PE # 58201  
1239 JABARA AVE.  
NORTH PORT, FL 34288  
PH. 941-380-1574

SHEET DESCRIPTION:

GENERAL NOTES AND ELEVATIONS

DRAWN BY: ADE	DATE: 09/24/09
DWG #: CWS-516	REV.: C
SCALE: 1:33.33	SHEET 1 OF 8

### TABLE OF CONTENTS

GENERAL NOTES & ELEVATIONS.....	1
GLAZING DETAILS.....	2
SECTION VIEWS "OX" / "XO".....	3
SECTION VIEWS "XOX".....	4
BOM & EXTRUSIONS.....	5
ANCHOR SCHEDULE & NOTES.....	6-7
INSTALLATION DETAILS.....	8

CONFIG.	MAX. UNIT SIZE	DESIGN PRESSURE RATING	IMPACT RATING
XO	74" x 72"	+/- 25 PSF	NONE
XO	59-3/4" x 66"	+/- 35 PSF	NONE
XOX 1/3 1/3 1/3	87-7/8" x 66"	+/- 35 PSF	NONE
XOX 1/4 1/2 1/4	120" x 66"	+/- 35 PSF	NONE

**7000 ALUM.  
HORZ. SLIDER  
NON-IMPACT**

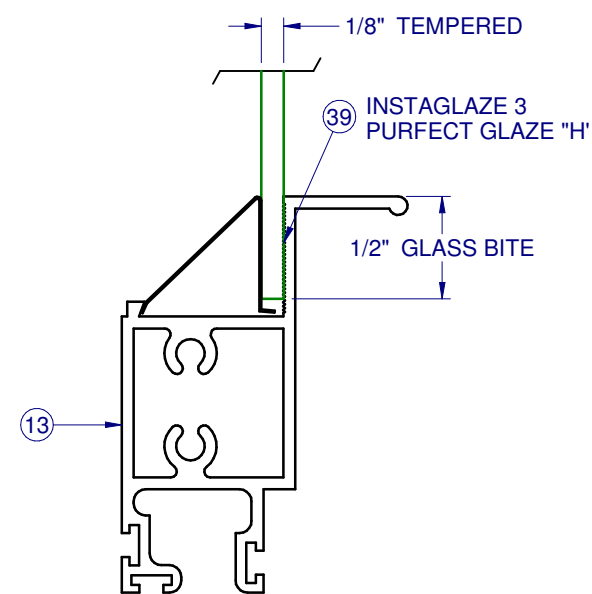

GLASS TYPE A

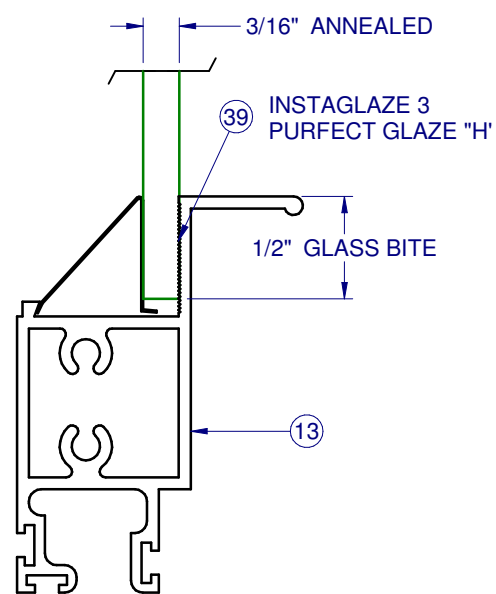

GLASS TYPE B

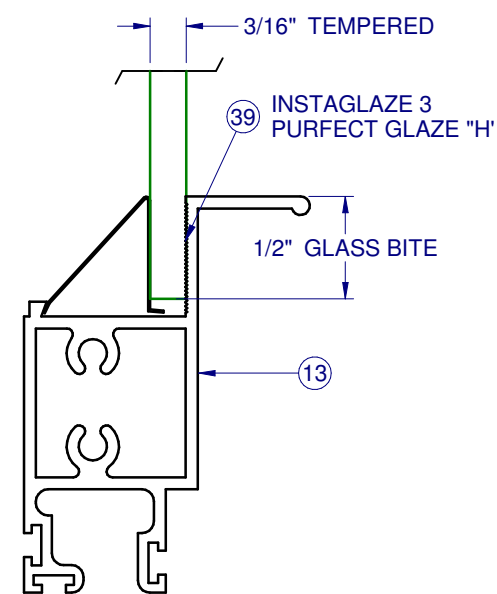

GLASS TYPE C

**NOTE:** GLASS TYPES A AND B ARE NOT AVAILABLE FOR USE IN THE FIXED SECTION OF XOX 1/4-1/2-1/4 UNITS.

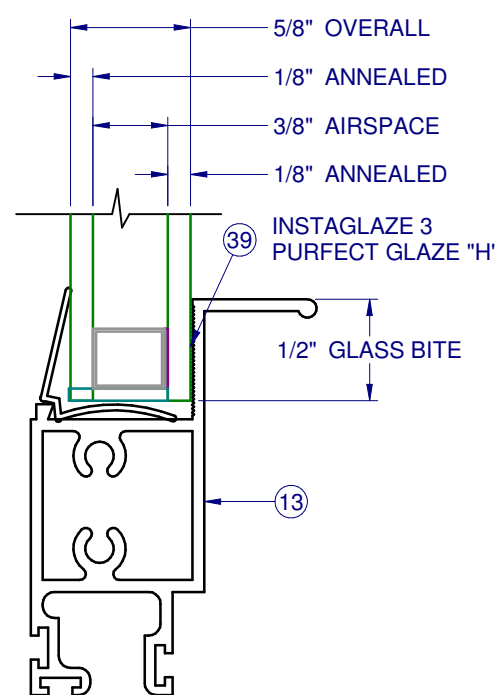

GLASS TYPE D

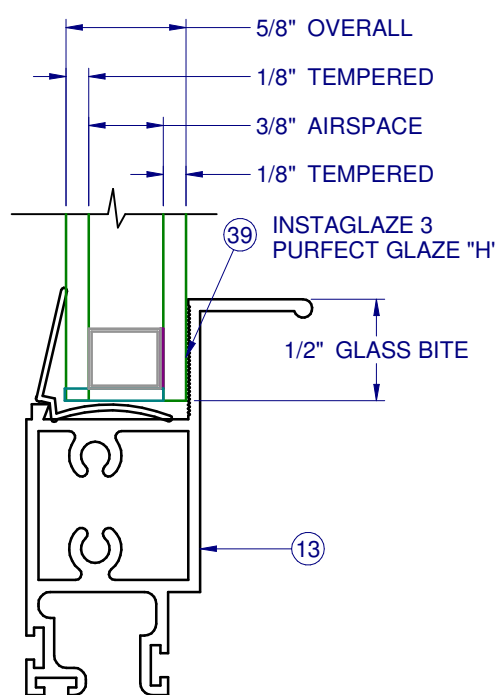

GLASS TYPE E

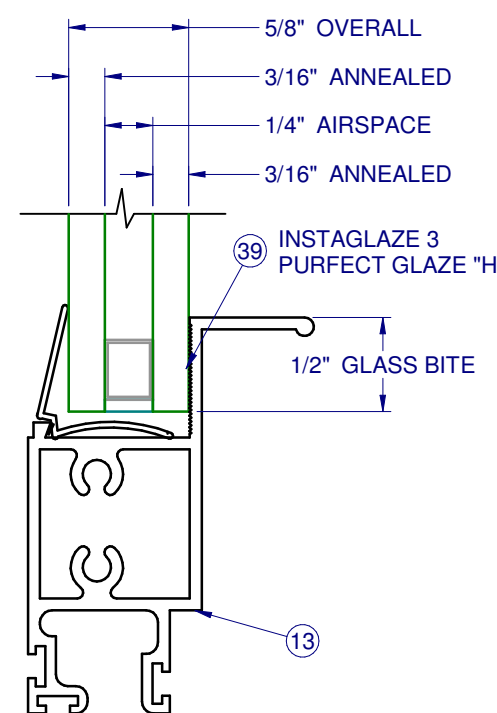

GLASS TYPE F

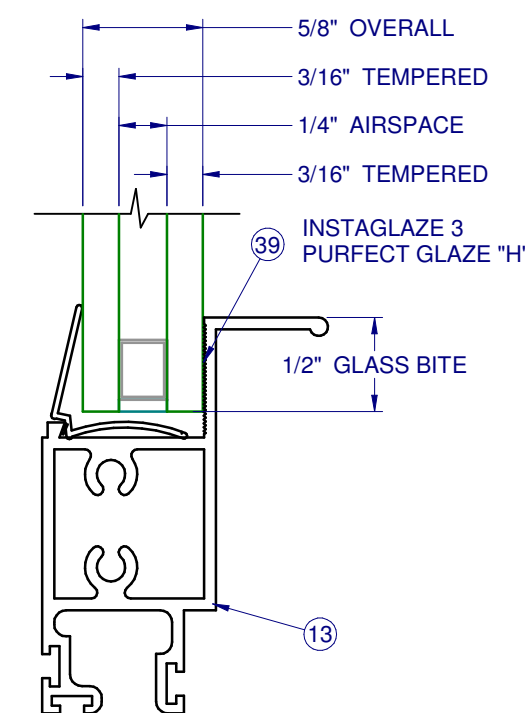

GLASS TYPE G

**NOTE:** GLASS TYPE D IS NOT AVAILABLE FOR USE IN THE FIXED SECTION OF XOX 1/4-1/2-1/4 UNITS.

NO.:	DESCRIPTION:	BY:	DATE:
C	UPDATED PER 2014 FBC	EMK	03/11/15
B	ADDED DP 35 OX	EMK	08/06/14
A	UPDATED PER 2010 FBC	BAT	10/14/11

REVISIONS

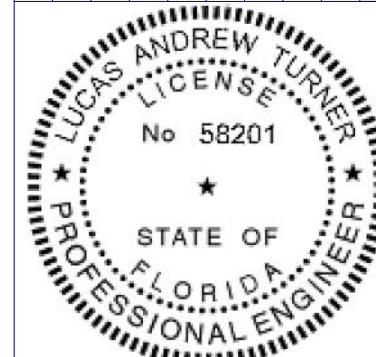

ZZ  
4/3/2015

LUCAS A. TURNER, P.E.  
FL PE # 58201  
1239 JABARA AVE.  
NORTH PORT, FL 34288  
PH. 941-380-1574

SHEET DESCRIPTION:

**GLAZING DETAILS**

DRAWN BY:	DATE:
ADE	09/24/09
DWG #:	REV.:
CWS-516	C
SCALE:	SHEET
1:1	2 OF 8

**7000 ALUM.  
HORZ. SLIDER  
NON-IMPACT**

NO.:	DESCRIPTION:	BY:	DATE:
C	UPDATED PER 2014 FBC	EMK	03/11/15
B	ADDED DP 35 OX	EMK	08/06/14
A	UPDATED PER 2010 FBC	BAT	10/14/11

REVISIONS

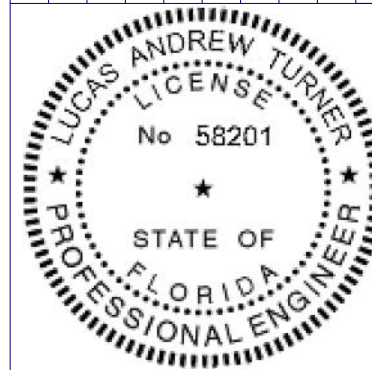

12  
4/3/2015

LUCAS A. TURNER, P.E.  
FL PE # 58201  
1239 JABARA AVE.  
NORTH PORT, FL 34288  
PH. 941-380-1574

SHEET DESCRIPTION:

SECTION VIEWS  
OX

DRAWN BY: ADE	DATE: 09/24/09
DWG #: CWS-516	REV.: C
SCALE: 1:1.33	SHEET 3 OF 8

INTERIOR

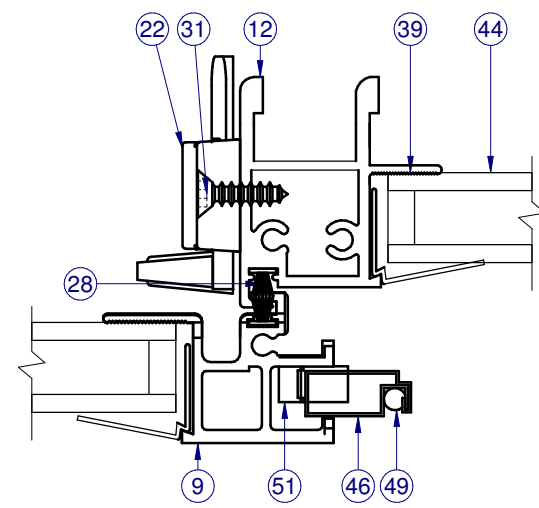

SECTION VIEW B-B

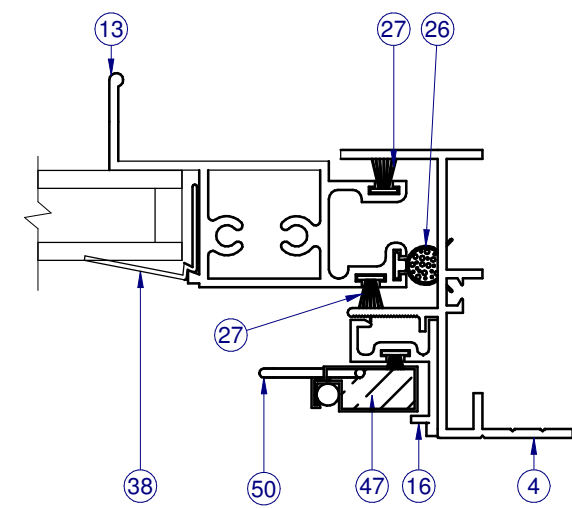

INTERIOR

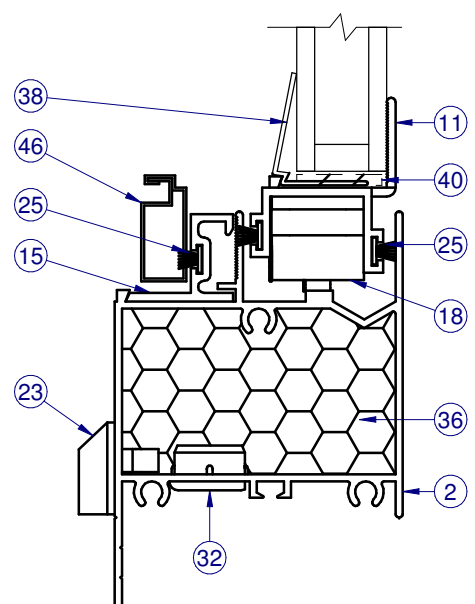

SECTION VIEW A-A

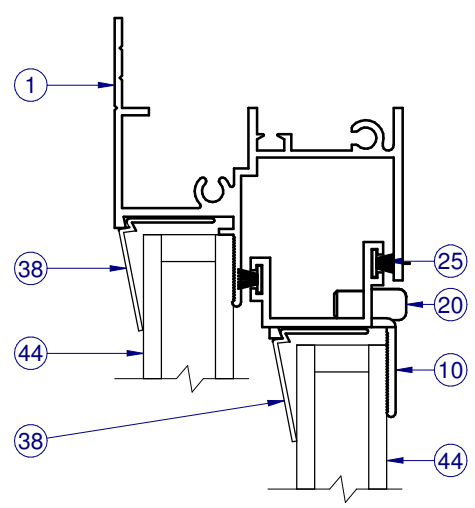

ITEMS USED BUT NOT SHOWN FOR CLARITY:  
5, 7, 14, 17, 19, 21, 29, 30, 33-35, 37, 41-43, 48

**7000 ALUM.  
HORZ. SLIDER  
NON-IMPACT**

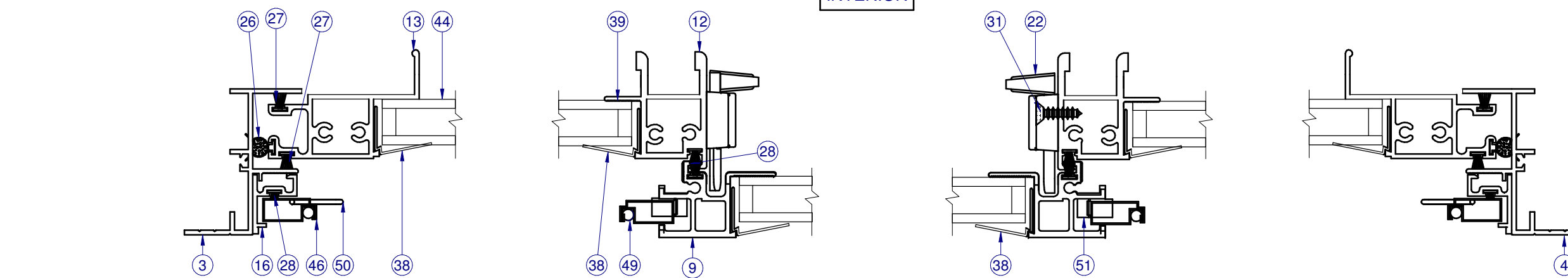

SECTION VIEW D-D

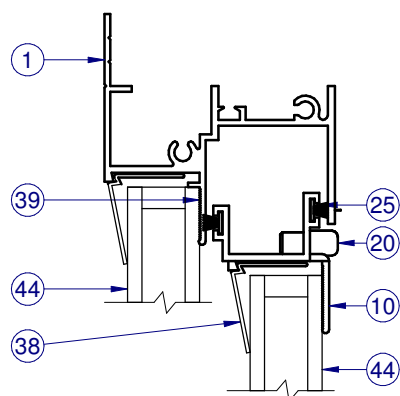

SECTION VIEW C-C

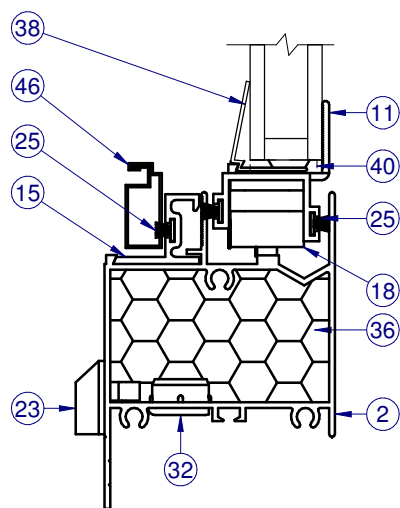

SECTION VIEW C-C

ITEMS USED BUT NOT SHOWN FOR CLARITY:  
5, 7, 14, 17, 19, 21, 29, 30, 33-35, 37, 41-43, 48

NO.	DESCRIPTION:	BY:	DATE:
C	UPDATED PER 2014 FBC	EMK	03/11/15
B	ADDED DP 35 OX	EMK	08/06/14
A	UPDATED PER 2010 FBC	BAT	10/14/11

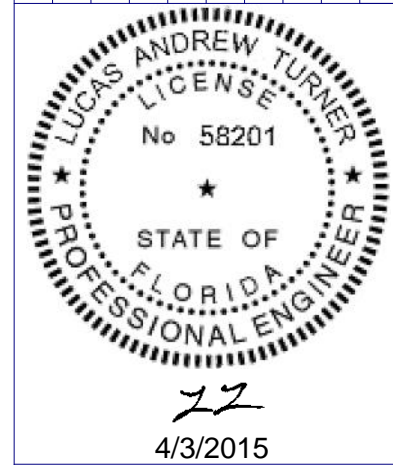

LUCAS A. TURNER, P.E.  
FL PE # 58201  
1239 JABARA AVE.  
NORTH PORT, FL 34288  
PH. 941-380-1574

SHEET DESCRIPTION:  
**SECTION VIEWS  
XOX**

DRAWN BY: <b>ADE</b>	DATE: <b>09/24/09</b>
DWG #: <b>CWS-516</b>	REV.: <b>C</b>
SCALE: <b>1:16.67</b>	SHEET <b>4 OF 8</b>

PARTS LIST				
ITEM	PART #	DESCRIPTION	VENDOR	MATERIAL
1	S-1077	Fr. Head, Flg.	Keymark	Alum
2	H-1140	Fr. Sill, HS-7000	Keymark	Alum
3	S-1043	Fr. Jamb, HS-7000, L. Jb.	Keymark	Alum
4	S-1043	Fr. Jamb, HS-7000, R. Jb.	Keymark	Alum
6	H-1569	HD Fixed Mtg Rail	Keymark	Alum
9	S-1563	Fxd. Mtg. Rail	Keymark	Alum
10	S-1073	Sash Top Rail	Keymark	Alum
11	S-1073	Sash Btm Rail	Keymark	Alum
12	H-1138	Sash Meet. Rail	Keymark	Alum
13	H-1181	Sash Bot./Pull Rail	Keymark	Alum
15	S-1074	Scrn. Adapt., w/o leg, Horiz.	Keymark	Alum
16	S-1075	Scrn. Adapt., w/ leg, Vert.	Keymark	Alum
17	S-1465	Install Clip	Keymark	Alum
18	P-3804	Roller Assm., Tandem	M&M	Nylon
19	P-3042	Sash End Cap	M&M	Nylon
20	P-3044	Anti-Lift Stop	M&M	Nylon
21	P-3043	Sash Stop	TeamPlastics	Rubber
22	P-3038	Sweep Lock,	Lawrence	Plastic
23	P-3100	Weep Cover, open	M&M	Nylon
25	P-3309	Wstp., 0.210 x .187 back FinSeal, Black, SoftTouch	Ultrafab	
26	P-3011	Wstp., 0.350 x .187 back, foam filled bulb w/wands	Ultrafab	
27	P-3305	Wstp., 0.270 x .187 back FinSeal, Black, SoftTouch	Ultrafab	
28	P-3303	Wstp., 0.190 x .187 back FinSeal, Gray, SoftTouch	Ultrafab	
29	P-3612	#8 x 1.000 w/ 1/4" lead Quad PH Type A SMS	Fastenal	Steel
30	P-3635	#8 x 0.750 Quad PH Type A SMS	Fastenal	Steel
31	P-3515	#8 x 0.625 Ph FH Type A SMS	Fastenal	Steel
32	P-3034	Plug, HS-7000, at FMR	M&M	Nylon
33	P-3342	Seam Sealer, SM-5504	Schnee	Silicone
34	P-3257	Gasket, Hd. & Sill at Jb., SH-3500	HOP	Closed Cell
35	P-3048	Gasket, Sill, HS-7000	HOP	Closed Cell
36	P-3397	Open Cell Foam Pad	HOP	Open Cell
37	P-3003	Shipping Clip	M&M	Nylon
38	P-3022	Glaz. Bd.	TeamPlastics	PVC
39	P-3433	InstaGlaze 3, Purfect Glaze "H"	Dow, Henkel	
40	P-3352	Set. Blk., 85 Dur., 1/8" x 5/8" x 2" Lg.	FrankLowe	Rubber
41	P-3643	HS-7000 Gold Cert. Label, NFRC Tab		
42	P-3881	Temporary Lbl. (NFRC/DP)		
43	P-3613	CWS Lbl. (logo)		
44	GLASS	SEE SHEET 2		
46	P-3218	Screen Frame	Allmetal	RollForm
47	P-3321	Screen Frame Corner Key	Allmetal	RollForm
48	P-3581	Screen Cloth, 18 x 16 Fiberglass	Phifer	
49	P-3228	Screen Spline, .155 Dia., Blk.	Dapa	
50	P-3029	Screen Pull Tab	Hurley	
51	P-3033	Screen Spring, SS	FlaSpring	

LINE ITEMS NOT USED:  
5, 7, 8, 14, 24, & 45

NOTE: ALL ALUMINUM EXTRUSIONS ARE 6063-T6 UNLESS OTHERWISE NOTED.

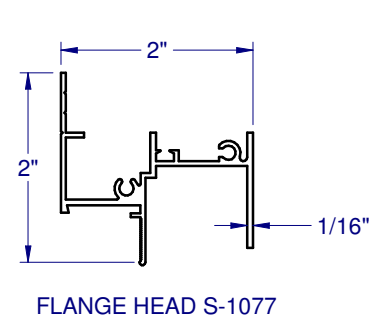

FLANGE HEAD S-1077

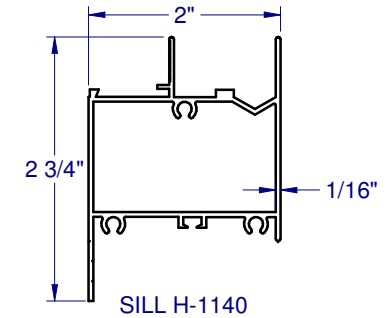

SILL H-1140

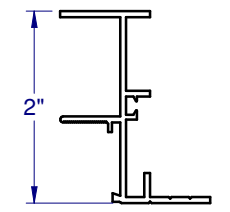

FLANGE JAMB S-1043

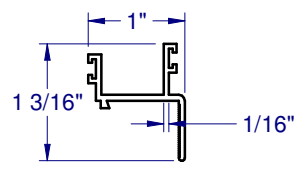

SASH TOP/BOT RAIL S-1073

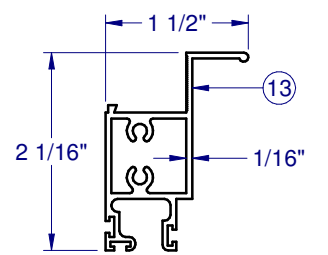

LIFT RAIL H-1181

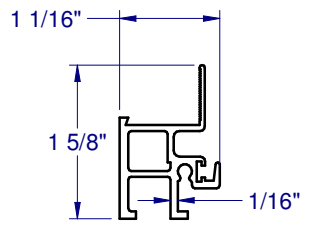

FIXED RAIL H-1563

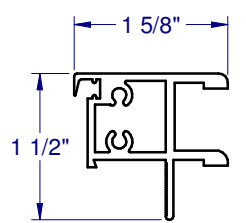

PULL RAIL H-1138

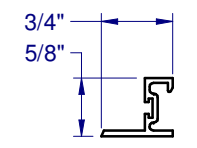

SCREEN CATCH S-1074

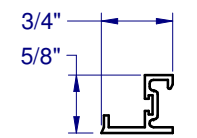

SCREEN CATCH S-1075

FRAME CORNER CONSTRUCTION

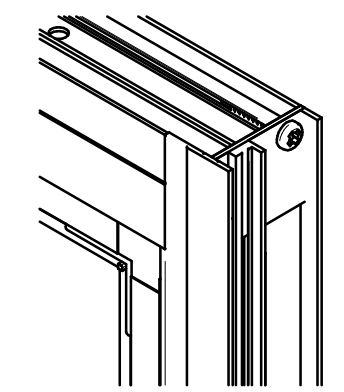

SASH CORNER CONSTRUCTION

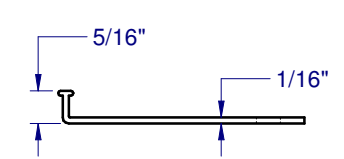
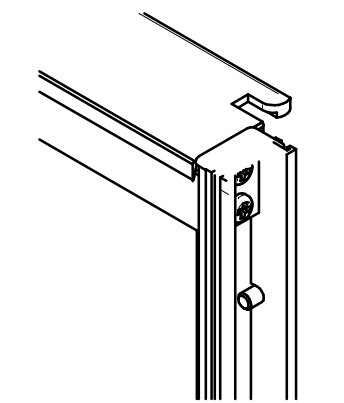

ANCHOR CLIP - 1465

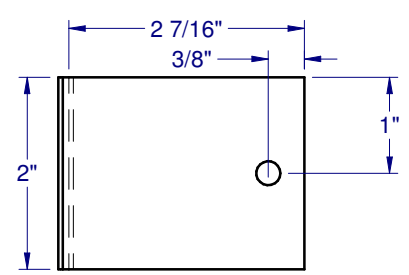

PLAN VIEW

**Custom**  
WINDOW SYSTEMS

1900 SW 44TH AVE.  
OCALA, FLORIDA 34474  
WWW.CWS.CC

**7000 ALUM.  
HORZ. SLIDER  
NON-IMPACT**

NO.:	DESCRIPTION:	BY:	DATE:
C	UPDATED PER 2014 FBC	EMK	03/11/15
B	ADDED DP 35 OX	EMK	08/06/14
A	UPDATED PER 2010 FBC	BAT	10/14/11



LUCAS A. TURNER, P.E.  
FL PE # 58201  
1239 JABARA AVE.  
NORTH PORT, FL 34288  
PH. 941-380-1574

SHEET DESCRIPTION:	
<b>BOM AND EXTRUSIONS</b>	
DRAWN BY:	DATE:
ADE	09/24/09
DWG #:	REV.:
CWS-516	C
SCALE:	SHEET
1:2	5 OF 8

REVISIONS

# .045" WALL 6063-T5 ALUMINUM SUBSTRATE



1900 SW 44TH AVE.  
OCALA, FLORIDA 34474  
WWW.CWS.CC

## 7000 ALUM. HORZ. SLIDER NON-IMPACT

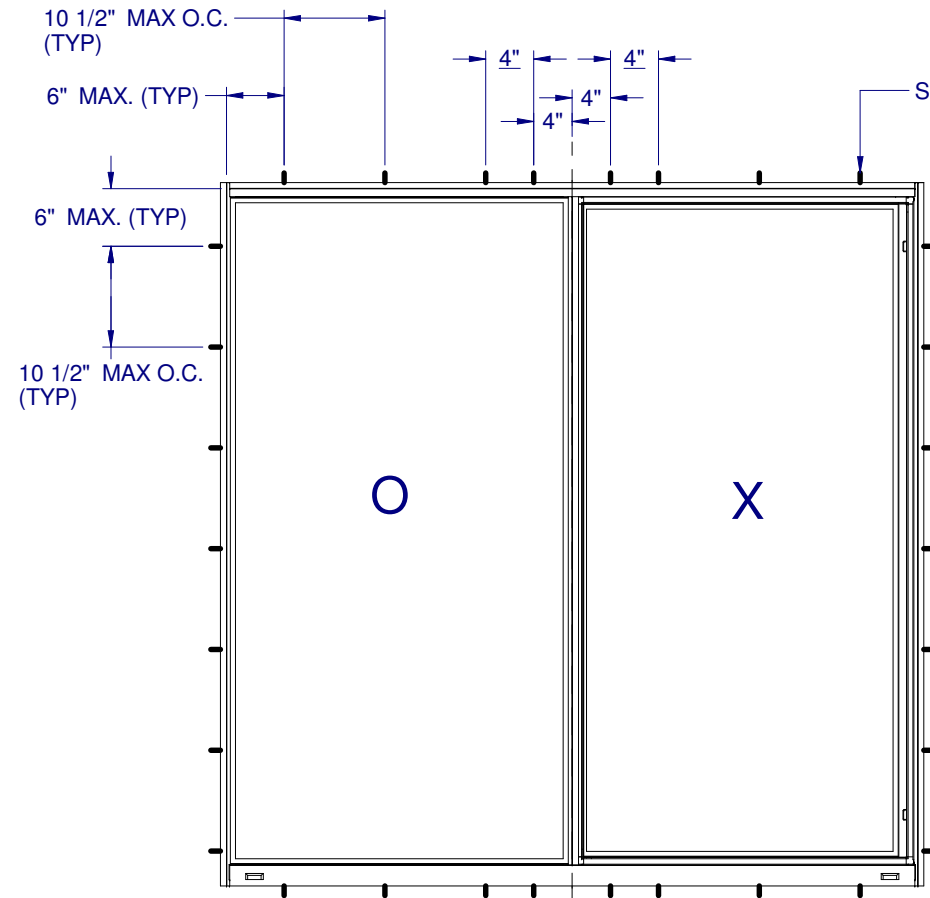

**ANCHOR LAYOUT - OX AND XO**  
THRU FLANGE & FRAME

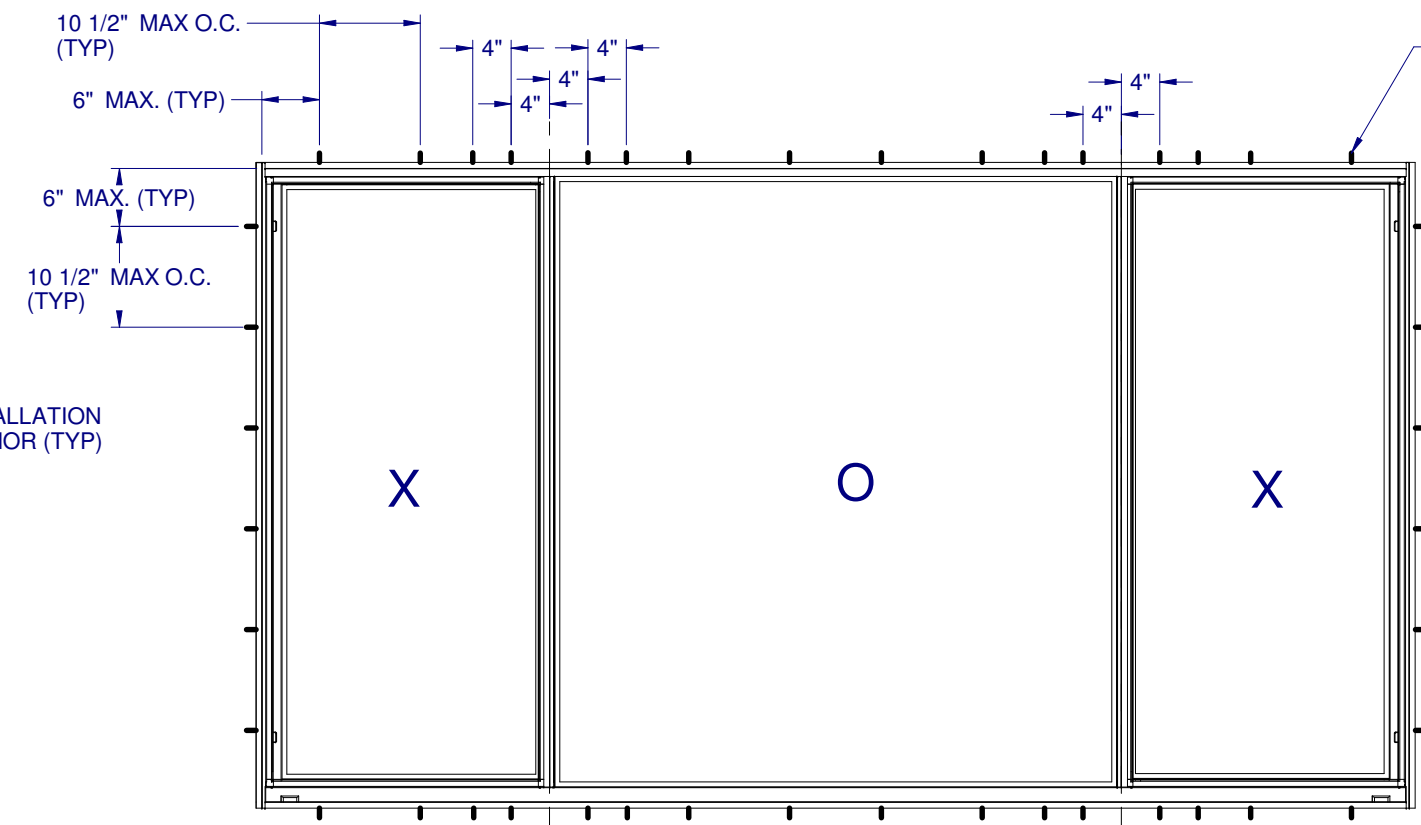

**ANCHOR LAYOUT - XOX**  
THRU FLANGE & FRAME

- NOTES:**
1. INSTALL ONE PAIR OF ANCHORS AT EACH LOCATION CONSISTING OF ONE ANCHOR THRU THE WINDOW FLANGE AND ONE ANCHOR THRU THE WINDOW FRAME. SILL ANCHOR SPACING SAME AS HEAD.
  2. SHIM AS REQ AT EACH INSTALLATION ANCHOR USING LOAD BEARING SHIMS. MAX. ALLOWABLE SHIM STACK TO BE 1/4". USE SHIMS WHERE SPACE GREATER THAN 1/16" IS PRESENT. LOAD BEARING SHIMS SHALL BE CONSTRUCTED OF HIGH DENSITY PLASTIC OR BETTER. WOOD SHIMS ARE NOT ALLOWED.
  3. ANCHOR TYPE, SIZE, SPACING AND EMBEDMENT SHALL BE AS SPECIFIED IN THESE DRAWINGS, SEE TABLE 1, SHEET 8.
  4. ALL INSTALLATION ANCHORS MUST BE MADE OF OR PROTECTED WITH A CORROSION RESISTANT MATERIAL OR COATING. DISSIMILAR METALS OR MATERIALS IN CONTACT WITH PRESSURE TREATED WOOD MUST BE PROTECTED TO PREVENT REACTION.
  5. INSTALLATION ANCHORS SHALL BE IN ACCORDANCE WITH ANCHOR MANUFACTURER'S INSTALLATION INSTRUCTIONS, AND ANCHORS SHALL NOT BE USED IN SUBSTRATES WITH STRENGTHS LESS THAN THE MINIMUM SPECIFIED IN TABLE 1, SHEET 8.
  6. ANCHOR EMBEDMENT TO SUBSTRATE SHALL BE BEYOND WALL DRESSING OR STUCCO.
  7. A MINIMUM 1" CENTER-TO-CENTER SPACING SHALL BE MAINTAINED BETWEEN ALL METAL FASTENERS.
  8. PORCH ENCLOSURE SHALL BE PROPERLY DESIGNED BY THE ARCHITECT OR ENGINEER OF RECORD AND INSTALLED TO TRANSFER WIND LOADS TO THE STRUCTURE. SUBSTRATES SHALL MEET THE MINIMUM STRENGTH REQUIREMENTS AS SHOWN IN TABLE 1, SHEET 8.
  9. SEALING AND FLASHING STRATEGIES FOR OVERALL WATER RESISTANCE OF INSTALLATION SHALL BE DONE BY OTHERS FOLLOWING THE CURRENT VERSION OF THE REFERENCE DOCUMENTS: FMA/AAMA 100(FIN WINDOWS), FMA/AAMA 200(FLANGE WINDOWS), FMA/WDMA 250(BOX WINDOWS), FMA/AAMA/WDMA 300(EXTERIOR DOORS)

NO.	DESCRIPTION:	BY:	DATE:	
C	UPDATED PER 2014 FBC	EMK	03/11/15	REVISIONS
B	ADDED DP 35 OX	EMK	08/06/14	
A	UPDATED PER 2010 FBC	BAT	10/14/11	

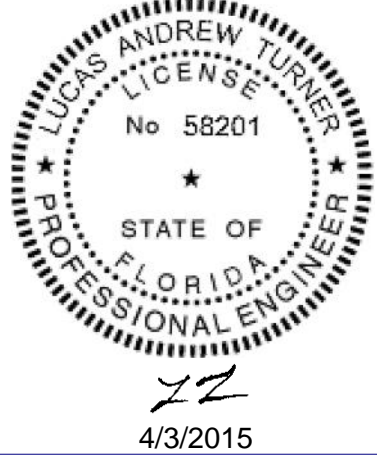

LUCAS A. TURNER, P.E.  
FL PE # 58201  
1239 JABARA AVE.  
NORTH PORT, FL 34288  
PH. 941-380-1574

SHEET DESCRIPTION: <b>ANCHOR SECHEDULE AND NOTES - 0.045" 6063-T5 ALUM.</b>	
DRAWN BY: <b>ADE</b>	DATE: <b>09/24/09</b>
DWG #: <b>CWS-516</b>	REV.: <b>C</b>
SCALE: <b>1:20</b>	<b>SHEET 6 OF 8</b>

# .125" WALL 6063-T5 ALUMINUM SUBSTRATE



1900 SW 44TH AVE.  
OCALA, FLORIDA 34474  
WWW.CWS.CC

## 7000 ALUM. HORZ. SLIDER NON-IMPACT

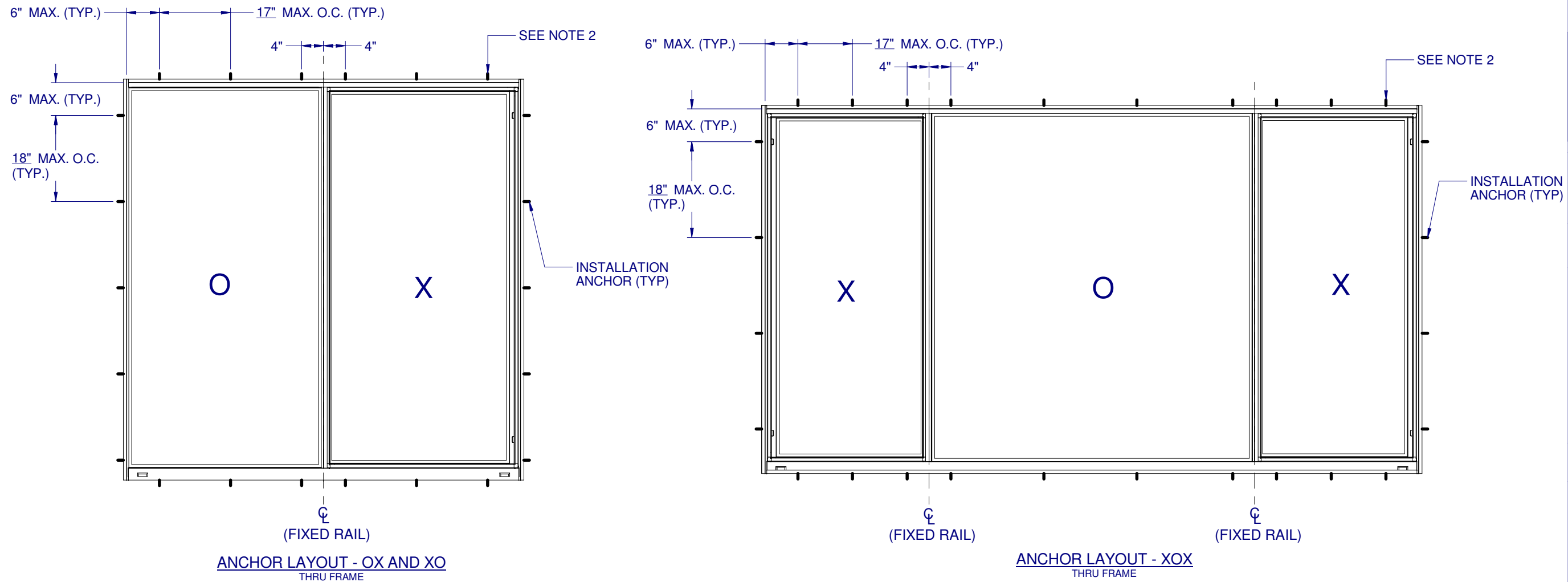

**NOTES:**

1. INSTALL ONE ANCHOR AT EACH LOCATION. SILL ANCHOR SPACING SAME AS HEAD.
2. SHIM AS REQ AT EACH INSTALLATION ANCHOR USING LOAD BEARING SHIMS. MAX. ALLOWABLE SHIM STACK TO BE 1/4". USE SHIMS WHERE SPACE GREATER THAN 1/16" IS PRESENT. LOAD BEARING SHIMS SHALL BE CONSTRUCTED OF HIGH DENSITY PLASTIC OR BETTER. WOOD SHIMS ARE NOT ALLOWED.
3. ANCHOR TYPE, SIZE, SPACING AND EMBEDMENT SHALL BE AS SPECIFIED IN THESE DRAWINGS, SEE TABLE 1, SHEET 8.
4. ALL INSTALLATION ANCHORS MUST BE MADE OF OR PROTECTED WITH A CORROSION RESISTANT MATERIAL OR COATING. DISSIMILAR METALS OR MATERIALS IN CONTACT WITH PRESSURE TREATED WOOD MUST BE PROTECTED TO PREVENT REACTION.
5. INSTALLATION ANCHORS SHALL BE IN ACCORDANCE WITH ANCHOR MANUFACTURER'S INSTALLATION INSTRUCTIONS, AND ANCHORS SHALL NOT BE USED IN SUBSTRATES WITH STRENGTHS LESS THAN THE MINIMUM SPECIFIED IN TABLE 1, SHEET 8.
6. ANCHOR EMBEDMENT TO SUBSTRATE SHALL BE BEYOND WALL DRESSING OR STUCCO.
7. A MINIMUM 1" CENTER-TO-CENTER SPACING SHALL BE MAINTAINED BETWEEN ALL METAL FASTENERS.
8. PORCH ENCLOSURE SHALL BE PROPERLY DESIGNED BY THE ARCHITECT OR ENGINEER OF RECORD AND INSTALLED TO TRANSFER WIND LOADS TO THE STRUCTURE. SUBSTRATES SHALL MEET THE MINIMUM STRENGTH REQUIREMENTS AS SHOWN IN TABLE 1, SHEET 8.
9. SEALING AND FLASHING STRATEGIES FOR OVERALL WATER RESISTANCE OF INSTALLATION SHALL BE DONE BY OTHERS FOLLOWING THE CURRENT VERSION OF THE REFERENCE DOCUMENTS: FMA/AAMA 100(FIN WINDOWS), FMA/AAMA 200(FLANGE WINDOWS), FMA/WDMA 250(BOX WINDOWS), FMA/AAMA/WDMA 300(EXTERIOR DOORS)

NO.:	DESCRIPTION:	BY:	DATE:						
		EMK	03/11/15						
		EMK	08/06/14						
		BAT	10/14/11						



LUCAS A. TURNER, P.E.  
FL PE # 58201  
1239 JABARA AVE.  
NORTH PORT, FL 34288  
PH. 941-380-1574

SHEET DESCRIPTION:  
**ANCHOR SCHEDULE AND NOTES -**  
**0.125" 6063-T5 ALUM.**

DRAWN BY: <b>ADE</b>	DATE: <b>09/24/09</b>
DWG #: <b>CWS-516</b>	REV.: <b>C</b>
SCALE: <b>1:20</b>	<b>SHEET 7 OF 8</b>

**7000 ALUM.  
HORZ. SLIDER  
NON-IMPACT**

				EMK	03/11/15	REVISIONS
				EMK	08/06/14	
				BAT	10/14/11	
				NO.:	DESCRIPTION:	DATE:
				C	UPDATED PER 2014 FBC	
				B	ADDED DP 35 OX	
				A	UPDATED PER 2010 FBC	

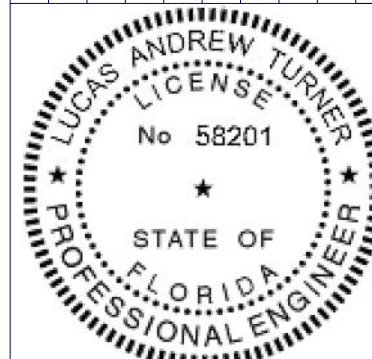

22  
4/3/2015

LUCAS A. TURNER, P.E.  
FL PE # 58201  
1239 JABARA AVE.  
NORTH PORT, FL 34288  
PH. 941-380-1574

SHEET DESCRIPTION:

**INSTALLATION DETAILS**

DRAWN BY:	DATE:
ADE	09/24/09
DWG #:	REV.:
CWS-516	C
SCALE:	SHEET
1:2	8 OF 8

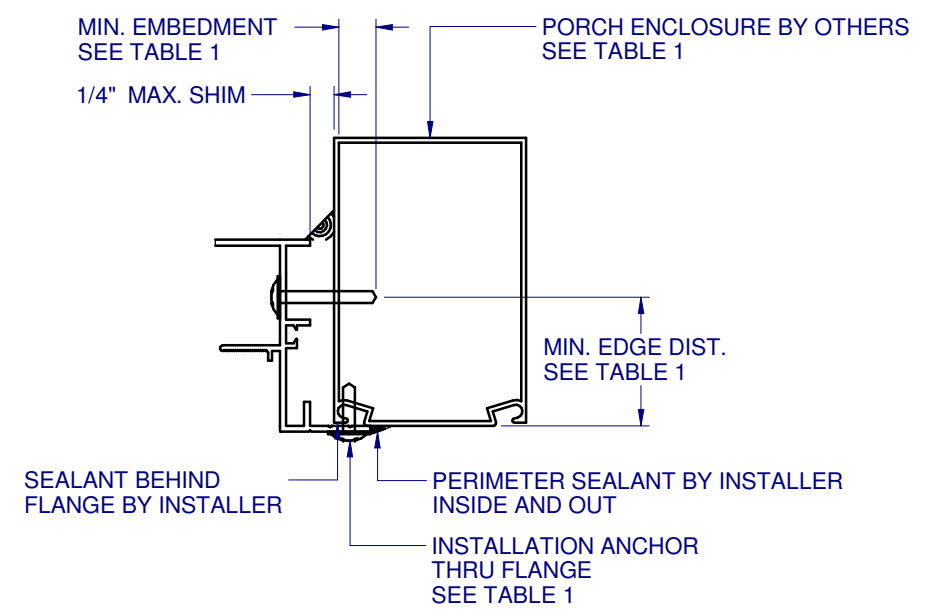
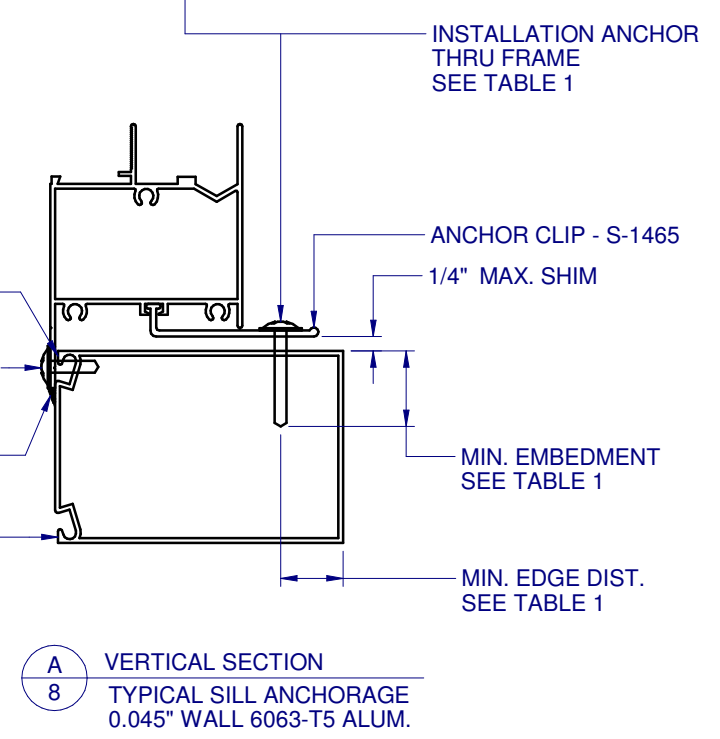
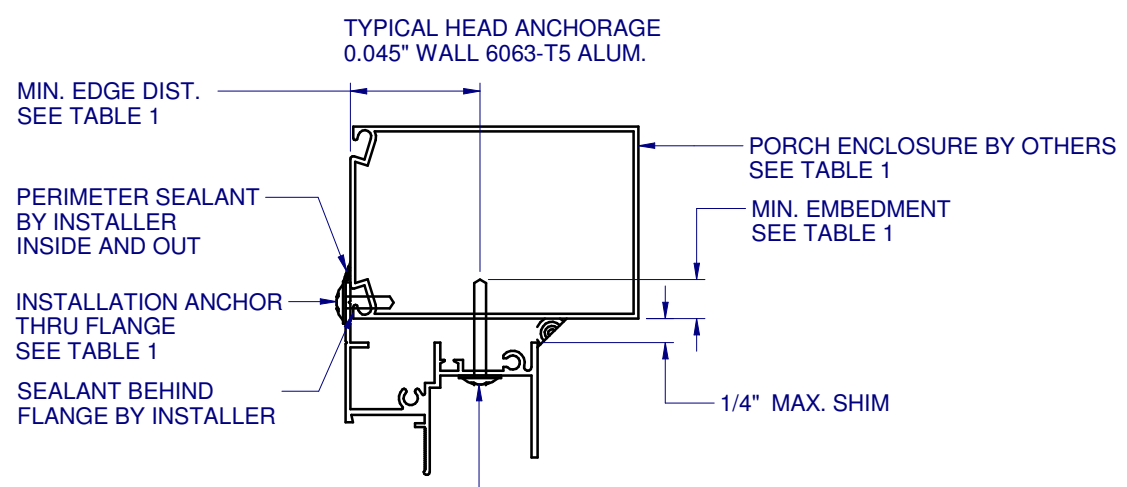

**B**  
**8** HORIZONTAL SECTION  
TYPICAL JAMB ANCHORAGE  
0.045" WALL 6063-T5 ALUM.

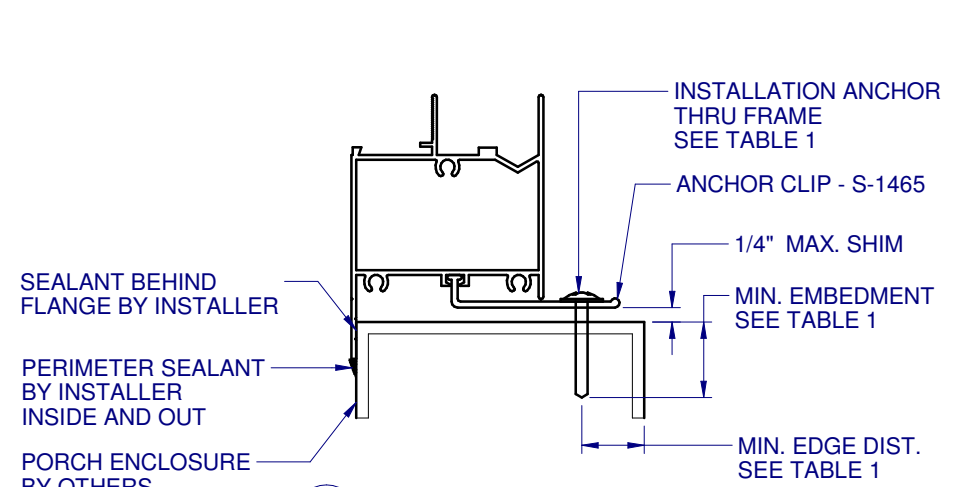

**C**  
**8** VERTICAL SECTION  
TYPICAL SILL ANCHORAGE  
0.125" WALL 6063-T5 ALUM.

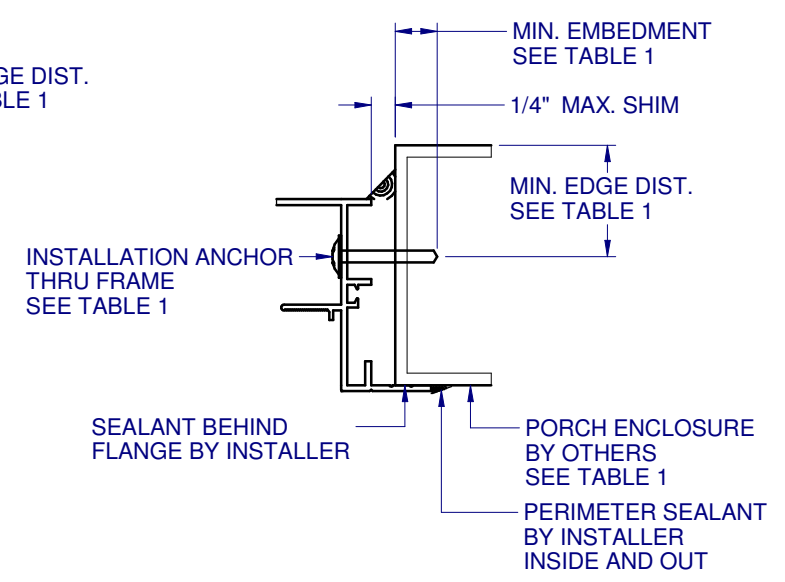

**D**  
**8** HORIZONTAL SECTION  
TYPICAL JAMB ANCHORAGE  
0.125" WALL 6063-T5 ALUM.  
HEAD SIMILAR FOR 1/8" INSTALLATION

**TABLE 1: APPROVED INSTALLATION FASTENERS**

LOCATION	SUBSTRATE TYPE	ANCHOR TYPE	MIN. EMBEDMENT	MIN. EDGE DIST.
THRU FRAME	0.045" ALUM. (6063-T5 MIN.)	#10 GRADE 5 SELF-TAPPING / DRILLING SCREW	FULL THREAD THRU 0.045"	1/2"
THRU FLANGE	0.045" ALUM. (6063-T5 MIN.)	#8 GRADE 5 SELF-TAPPING / DRILLING SCREW	FULL THREAD THRU 0.045"	-
THRU FRAME	1/8" ALUM. (6063-T5 MIN.) OR 1/8" STEEL (33 KSI MIN.)	#10 GRADE 5 SELF-TAPPING / DRILLING SCREW	FULL THREAD THRU 0.125"	1/2"