

SINGLE HUNG - NON-IMPACT

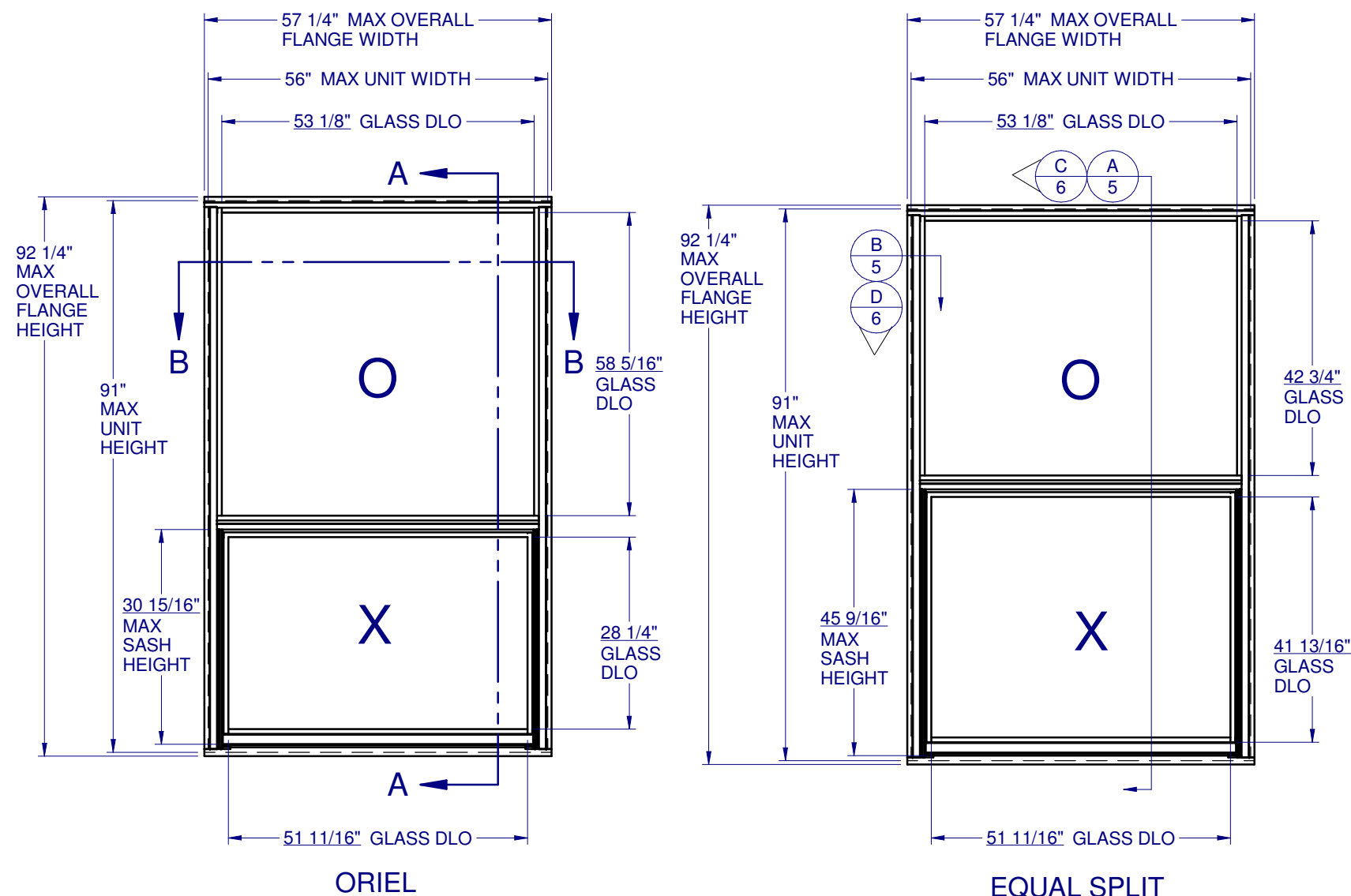

GENERAL NOTES:

1. THE PRODUCT SHOWN HEREIN IS DESIGNED AND MANUFACTURED TO COMPLY WITH THE FLORIDA BUILDING CODE (FBC), CURRENT EDITION.
2. GLAZING OPTIONS: (SEE SHEET 2)
3. CONFIGURATIONS: "O/X".
4. DESIGN PRESSURE RATING:
 -NEGATIVE DESIGN LOADS BASED ON TESTED PRESSURE AND GLASS TABLES ASTM E-1300-04.
 -POSITIVE DESIGN LOADS BASED ON TESTED PRESSURE, WATER INFILTRATION TEST PRESSURE AND GLASS TABLES ASTM E-1300-04.
5. ANCHORAGE: THE 33 1/3% STRESS INCREASE HAS NOT BEEN USED IN THE DESIGN OF THIS PRODUCT. SEE SHEETS 5-6 FOR INSTALLATION DETAILS.
6. NOT APPROVED FOR IMPACT RESISTANCE. IMPACT PROTECTIVE SYSTEM IS REQUIRED IN WIND BORNE DEBRIS REGION.
7. ALL FRAMES SCREWED TOGETHER. SMALL JOINT SEAM SEALANT USE AT ALL FRAME JOINTS.
8. SERIES / MODEL DESIGNATION SH-3500.
9. SOLID CONCRETE STRUCTURE IS RESPONSIBILITY OF ARCHITECT OR ENGINEER OF RECORD.
10. THE DESIGNATION X AND O STAND FOR THE FOLLOWING:
 X = OPERABLE SASH, O = FIXED SASH.
11. SECTION CALLOUTS FROM ELEVATIONS APPLY TO ALL ELEVATIONS IN A SIMILAR LOCATION.
12. WEEP SLOTS = 1/4" X 1 1/4" LOCATED 4" FROM BOTH ENDS.



1900 SW 44TH AVE.
 OCALA, FLORIDA 34474
 WWW.CWS.CC

3500 ALUM. SINGLE HUNG NON-IMPACT

NO.	DESCRIPTION	DATE	BY
A	UPDATED PER 2014	02/24/15	EMK
REVISIONS			

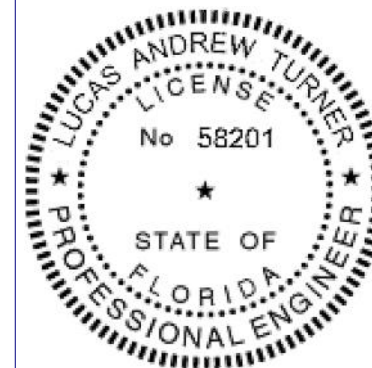

LT
 4/3/2015

LUCAS A. TURNER, P.E.
 FL PE # 58201
 1239 JABARA AVE.
 NORTH PORT, FL 34288
 PH. 941-380-1574

SHEET DESCRIPTION:
 GENERAL NOTES AND ELEVATIONS

DRAWN BY: ADE	DATE: 12/22/13
DWG #: CWS-880	REV.: A
SCALE: 1:25	SHEET 1 OF 6

TABLE OF CONTENTS

GENERAL NOTES & ELEVATIONS.....1
 SECTION VIEWS & GLAZING DETAIL.....2
 EXTRUSIONS & B.O.M.....3
 ANCHOR SCHEDULE & NOTES.....4
 INSTALLATION DETAIL.....5-6

CONFIG.	MAX. UNIT SIZE	DESIGN PRESSURE RATING	IMPACT RATING
EQUAL SPLIT	56" x 91"	+/-30 PSF	NONE
ORIEL			

**3500 ALUM.
SINGLE HUNG
NON-IMPACT**

						02/24/15	DATE:
					EMK		BY:
					A	UPDATED PER 2014	NO.:
							DESCRIPTION:
							REVISIONS

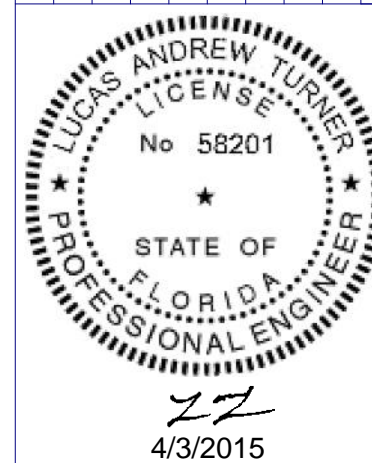

LUCAS A. TURNER, P.E.
FL PE # 58201
1239 JABARA AVE.
NORTH PORT, FL 34288
PH. 941-380-1574

SHEET DESCRIPTION:
**SECTION VIEWS AND
GLAZING DETAILS**

DRAWN BY: ADE	DATE: 12/22/13
DWG #: CWS-880	REV.: A
SCALE: 1:2	SHEET 2 OF 6

INTERIOR

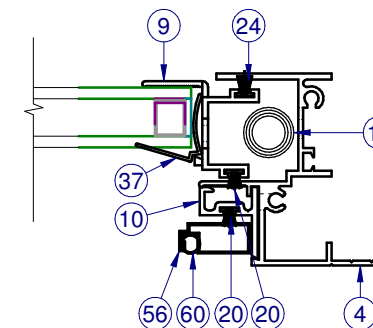
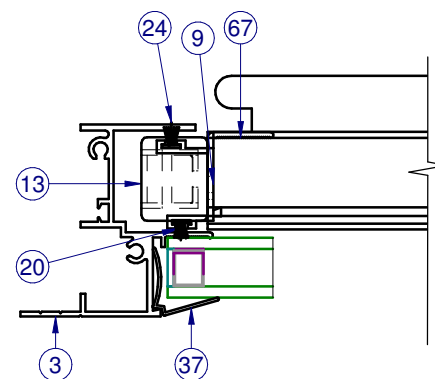

SECTION B-B

NOTE: LEFT SIDE SHOWS FIXED SECTION VIEW,
RIGHT SIDE SHOWS SASH SECTION VIEW

INTERIOR

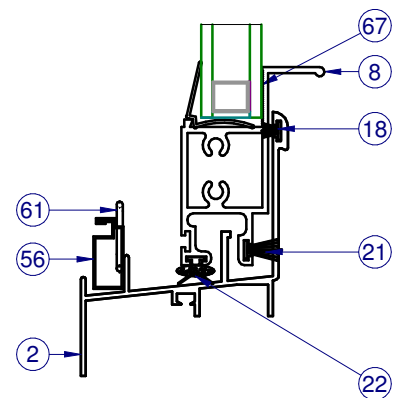
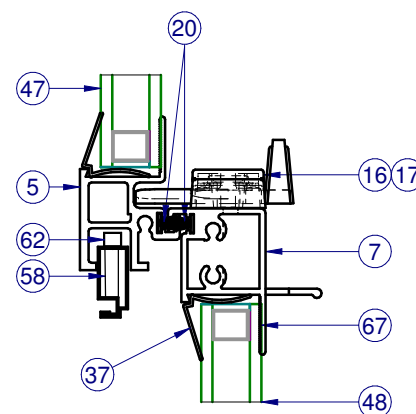

SECTION A-A

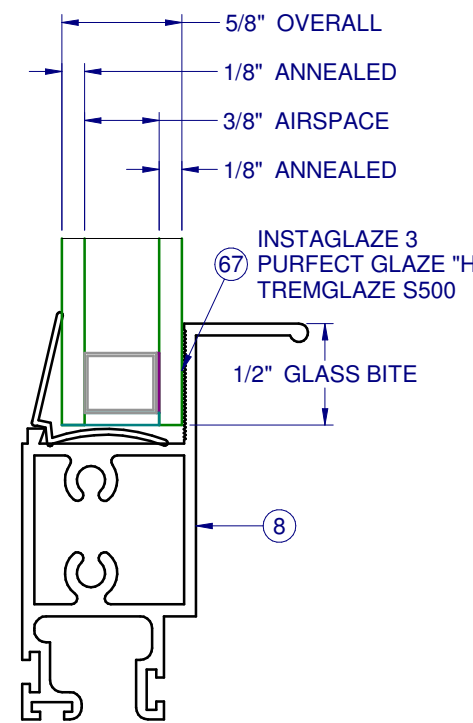

GLASS TYPE A
1:1

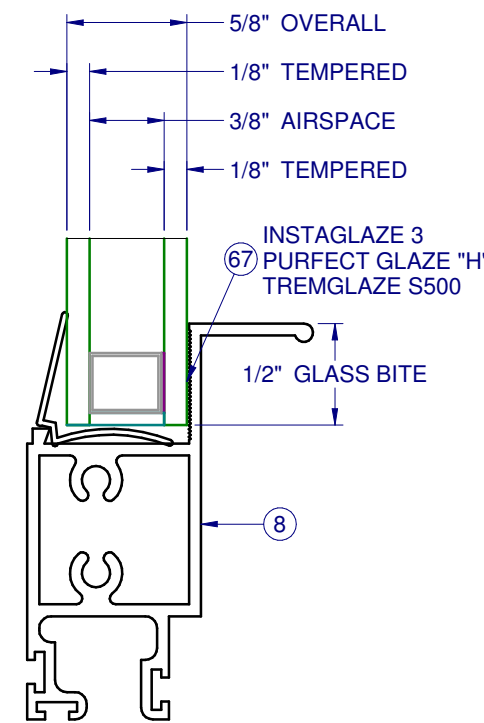

GLASS TYPE B
1:1

NOTE: ITEMS NOT SHOWN FOR CLARITY:
11, 14, 23, 26-32, 34, 35, 42, 43-46, 59, 63, 65, 66

PARTS LIST				
Item	Part #	Description	Vendor	Material
1	S-1326	Fr. Head, Flg., Head	Keymark	Aluminum
2	S-1182	Fr. Sill, Flg., Sill	Keymark	Aluminum
3	S-1077	Fr. Jamb, Flg., L. Jb.	Keymark	Aluminum
4	S-1077	Fr. Jamb, Flg., R. Jb.	Keymark	Aluminum
5	H-1563	Fxd. Mtg. Rail	Keymark	Aluminum
7	H-1072	Sash Meet. Rail	Keymark	Aluminum
8	H-1181	Sash Bot./Pull Rail	Keymark	Aluminum
9	S-1073	Sash Side/Top Rail	Keymark	Aluminum
10	S-1074	Scrn. Adapt., w/o leg, Vert.	Keymark	Aluminum
11	S-2020	Install Clip	Keymark	Aluminum
12	P-3340	Balance	Caldwell	
13	P-3040	Sash Cam	M&M	
14	P-3046	Take Out Clip		
15	P-3043	Sash Stop	TeamPlas	
16	P-3037	Sweep Lock, RH	Lawrence	Nylon
17	P-3038	Sweep Lock, LH	Lawrence	Nylon
18	P-3305	Wstp., 0.270 x .187 back FinSeal, Black, SoftTouch	Ultrafab	Nylon
20	P-3303	Wstp., 0.190 x .187 back FinSeal, Gray, SoftTouch	Ultrafab	Nylon
21	P-3305	Wstp., 0.270 x .187 back FinSeal, Black, SoftTouch	Ultrafab	Nylon
22	P-3011	Wstp., 0.350 x .187 back, foam filled bulb w/wands	Ultrafab	Nylon
23	P-3303	Wstp., 0.190 x .187 back FinSeal, Gray, SoftTouch	Ultrafab	Nylon
24	P-3309	Wstp., 0.210 x .187 back FinSeal, Black, SoftTouch	Ultrafab	Nylon
26	P-3612	#8 x 1.000 w/ 1/4" lead Quad PH Type A SMS	Fastenal	Steel
28	P-3635	#8 x 0.750 Quad PH Type A SMS	Fastenal	Steel
29	P-3515	#8 x 0.625 Ph FH Type A SMS	Fastenal	Steel
30	P-3264	Gasket, Hd. & Sill at Jb., SH-3500	HO Prod	Closed Cel
33	P-3342	Seam Sealer, SM-5504	Schnee	
34	P-3373	Pad, Sill, SH-3500	Visor	Open Cell
36	P-3022	Glazing Bead, Single Glazed	Fla Scrn	Metal
37	P-3020	Glazing Bead, Insulated glass	TeamPlas	PVC
42	P-3352	Set. Blk., 85 Dur., 1/8" x 5/8" x 2" Lg.	Frank Lowe	
43	P-3641	SH-3500 Gold Cert. Label		
45	P-3881	Temporary Lbl. (NFRC/DP)		
46	P-3613	CWS Lbl. (logo)		
47		Glass, Fixed		
48		Glass, Sash		
56	P-3218	Screen Frame	Allmetal	Alum
58	P-3321	Screen Frame Corner Key	Allmetal	Alum
59	P-3581	Screen Cloth, 18 x 16 Fiberglass	Phifer	
60	P-3228	Screen Spline, .155 Dia., Blk.	Dapa	Nylon
61	P-3029	Screen Pull Tab	Summit	Steel
62	P-3033	Screen Spring, SS	FlaScrn	SS
63	S-1465	Install Clip	Keymark	Aluminum
66	S-1112	Fr. Head, Flange Archtop	Keymark	Aluminum
67		Instaglaze 3, Purfect Glaze "H", TremglazeS500	Dow, Henkel, Tremco	

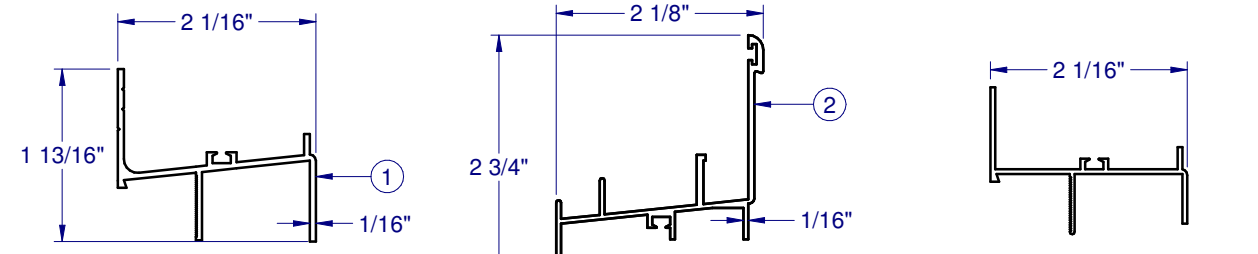

HEAD S-1326 HEAD, ARCHTOP S-1112

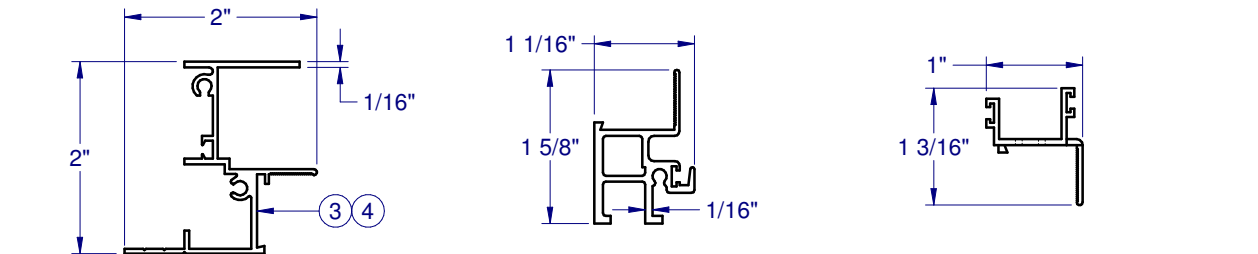

JAMB S-1077 FIXED RAIL H-1563 SASH SIDE RAIL S-1073

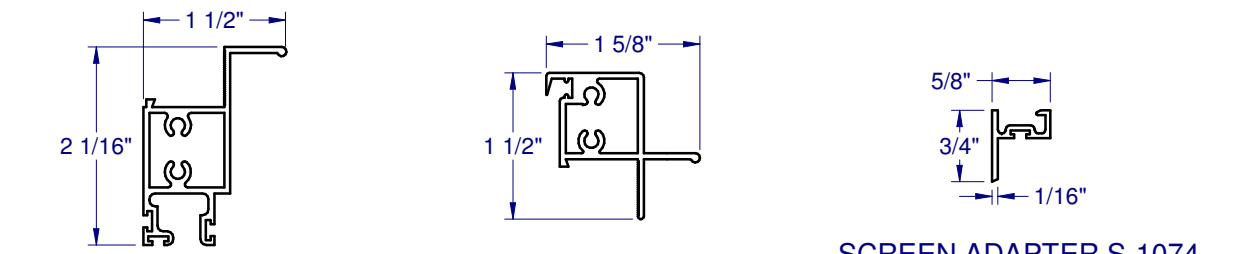

SASH BOTTOM RAIL H-1181 SASH TOP RAIL H-1072 SCREEN ADAPTER S-1074

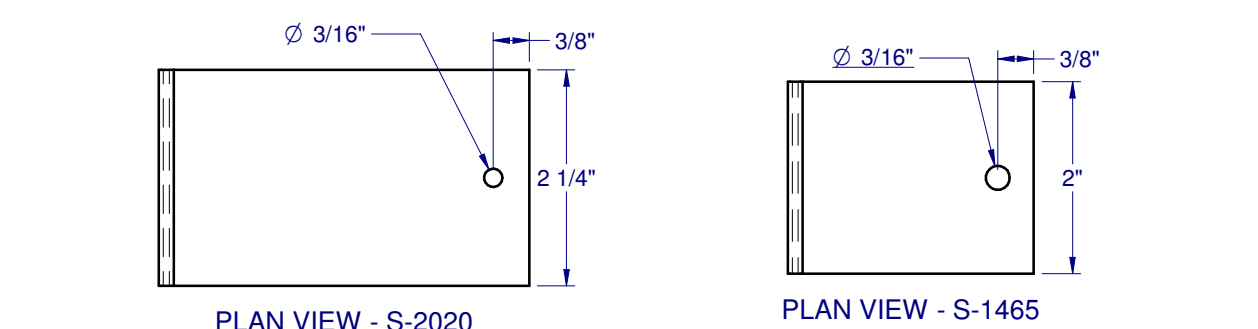

PLAN VIEW - S-2020 PLAN VIEW - S-1465

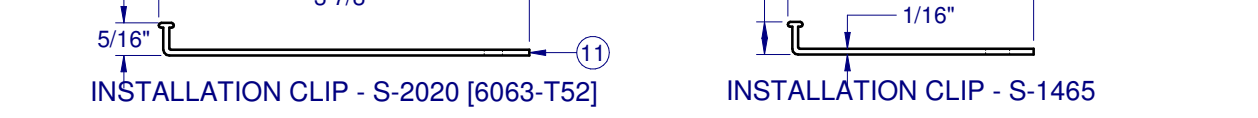

INSTALLATION CLIP - S-2020 [6063-T52] INSTALLATION CLIP - S-1465

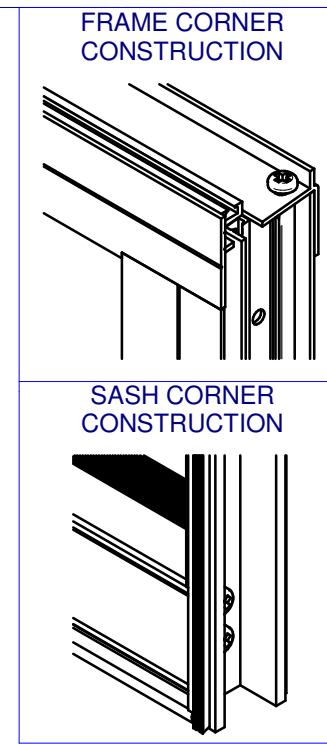

Custom WINDOW SYSTEMS
 1900 SW 44TH AVE.
 OCALA, FLORIDA 34474
 WWW.CWS.CC

3500 ALUM. SINGLE HUNG NON-IMPACT

NO:	DESCRIPTION:	REVISIONS
A	UPDATED PER 2014	EMK
		BY:
		DATE:
		02/24/15

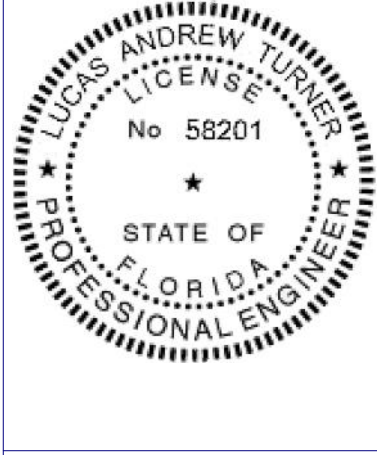

LUCAS A. TURNER, P.E.
 FL PE # 58201
 1239 JABARA AVE.
 NORTH PORT, FL 34288
 PH. 941-380-1574

SHEET DESCRIPTION:
BOM AND EXTRUSIONS

DRAWN BY:	DATE:
ADE	12/22/13
DWG #:	REV.:
CWS-880	A
SCALE:	SHEET
1:2	3 OF 6

LINE ITEMS NOT USED:
 6, 19, 25, 27, 31, 32, 35, 37-41, 44, 49-55, 57, 64, 65

NOTE: ALL ALUMINUM EXTRUSION ARE 6063-T6 UNLESS OTHERWISE NOTED.

**3500 ALUM.
SINGLE HUNG
NON-IMPACT**

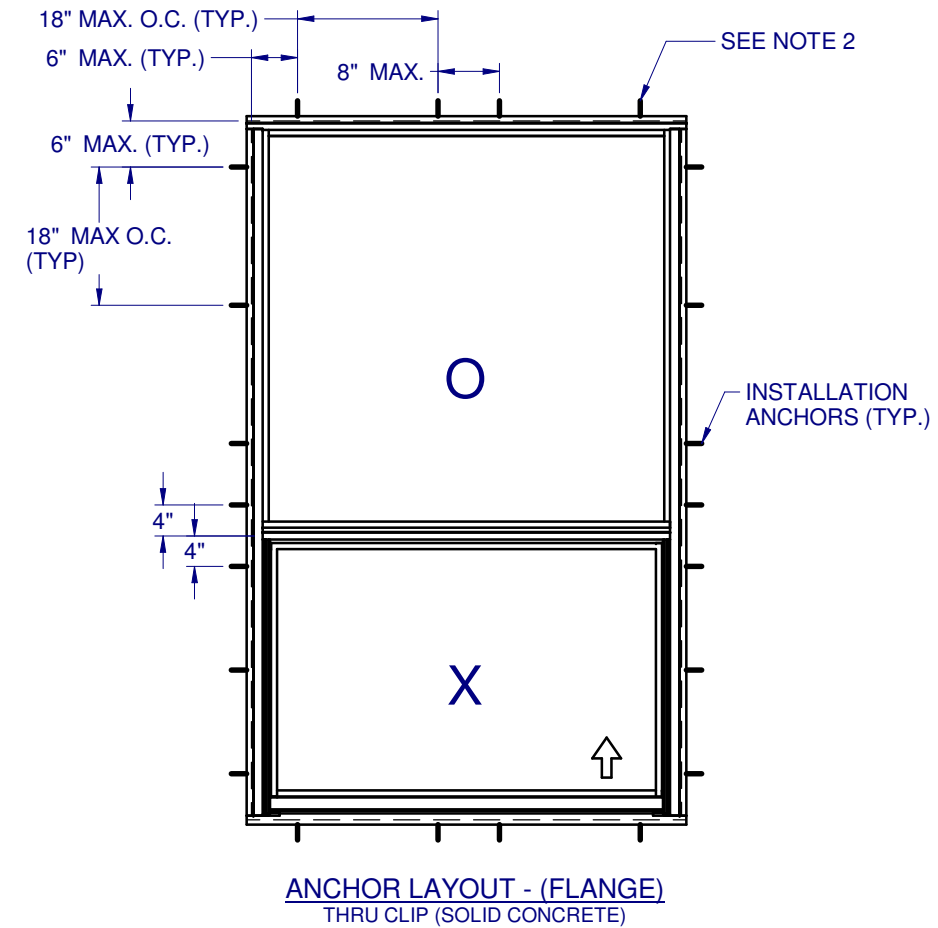
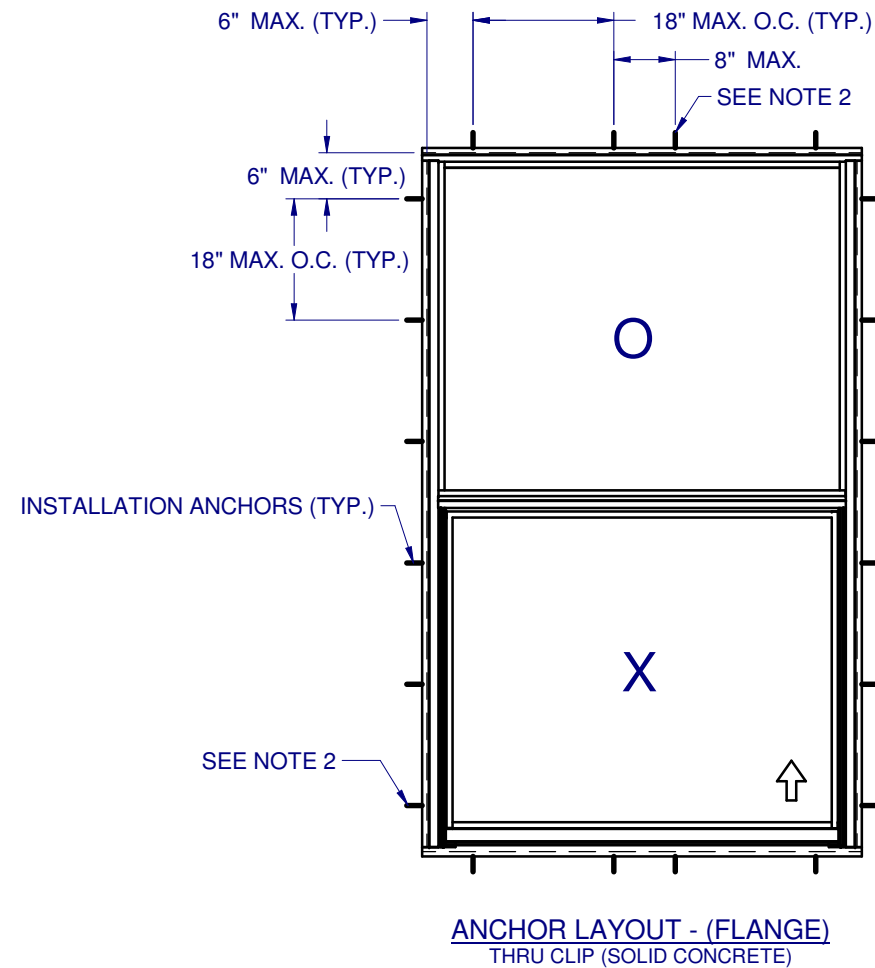

NOTES:

1. INSTALL ONE ANCHOR AT EACH LOCATION. SILL ANCHOR SPACING SAME AS HEAD.
2. SHIM AS REQ'D AT EACH SET OF INSTALLATION ANCHORS USING LOAD BEARING SHIMS. MAX. ALLOWABLE SHIM STACK TO BE 1/4". USE SHIMS WHERE SPACE GREATER THAN 1/16" IS PRESENT. LOAD BEARING SHIMS SHALL BE CONSTRUCTED OF HIGH DENSITY PLASTIC OR BETTER. WOOD SHIMS ARE NOT ALLOWED.
3. ANCHOR TYPE, SIZE, SPACING AND EMBEDMENT SHALL BE SPECIFIED IN THESE DRAWINGS, SEE TABLE 1, SHEET 5.
4. ALL INSTALLATION ANCHORS MUST BE MADE OF OR COATED WITH A CORROSION RESISTANT MATERIAL. DISSIMILAR MATERIALS OR MATERIALS IN CONTACT WITH PRESSURE TREATED WOOD MUST BE PROTECTED TO PREVENT REACTION.
5. INSTALLATION ANCHORS SHALL BE IN ACCORDANCE WITH ANCHOR MANUFACTURER'S INSTALLATION INSTRUCTIONS, AND ANCHORS SHALL NOT BE USED IN SUBSTRATES WITH STRENGTHS LESS THAN THE MINIMUM SPECIFIED IN TABLE 1, SHEET 5.
6. ANCHOR EMBEDMENT TO SUBSTRATE SHALL BE BEYOND WALL DRESSING OR STUCCO. FOR CONCRETE OPENINGS, EMBEDMENT SHALL BE BEYOND WOOD BUCKS, IF USED, AND INTO SUBSTRATE - 1X BUCKS ARE OPTIONAL.
7. A MINIMUM 4" CENTER-TO-CENTER SPACING SHALL BE MAINTAINED BETWEEN ALL MASONRY FASTENERS. A MINIMUM 1" CENTER-TO-CENTER SPACING SHALL BE MAINTAINED BETWEEN ALL WOOD AND METAL FASTENERS.
8. WOOD OR MASONRY OPENINGS, BUCKS AND BUCK FASTENERS SHALL BE PROPERLY DESIGNED BY THE ARCHITECT OR ENGINEER OF RECORD AND INSTALLED TO TRANSFER WIND LOADS TO THE STRUCTURE. SUBSTRATES SHALL MEET THE MINIMUM STRENGTH REQUIREMENTS AS SHOWN IN TABLE 1, SHEET 5. CONCRETE AND MASONRY SUBSTRATES SHALL NOT BE CRACKED.
9. SEALING AND FLASHING STRATEGIES FOR OVERALL WATER RESISTANCE OF INSTALLATION SHALL BE DONE BY OTHERS FOLLOWING THE CURRENT VERSION OF THE REFERENCE DOCUMENTS:
FMA/AAMA 100(FIN WINDOWS), FMA/AAMA 200(FLANGE WINDOWS),
FMA/WDMA 250(BOX WINDOWS), FMA/AAMA/WDMA 300(EXTERIOR DOORS).

NO.	DESCRIPTION	BY	DATE
A	UPDATED PER 2014	EMK	02/24/15



LUCAS A. TURNER, P.E.
FL PE # 58201
1239 JABARA AVE.
NORTH PORT, FL 34288
PH. 941-380-1574

SHEET DESCRIPTION:
ANCHOR SCHEDULE AND NOTES

DRAWN BY: ADE	DATE: 12/22/13
DWG #: CWS-880	REV.: A
SCALE: 1:1	SHEET 4 OF 6

**3500 ALUM.
SINGLE HUNG
NON-IMPACT**

											02/24/15	DATE:
											EMK	BY:
											UPDATED PER 2014	NO.:
												DESCRIPTION:
												REVISIONS

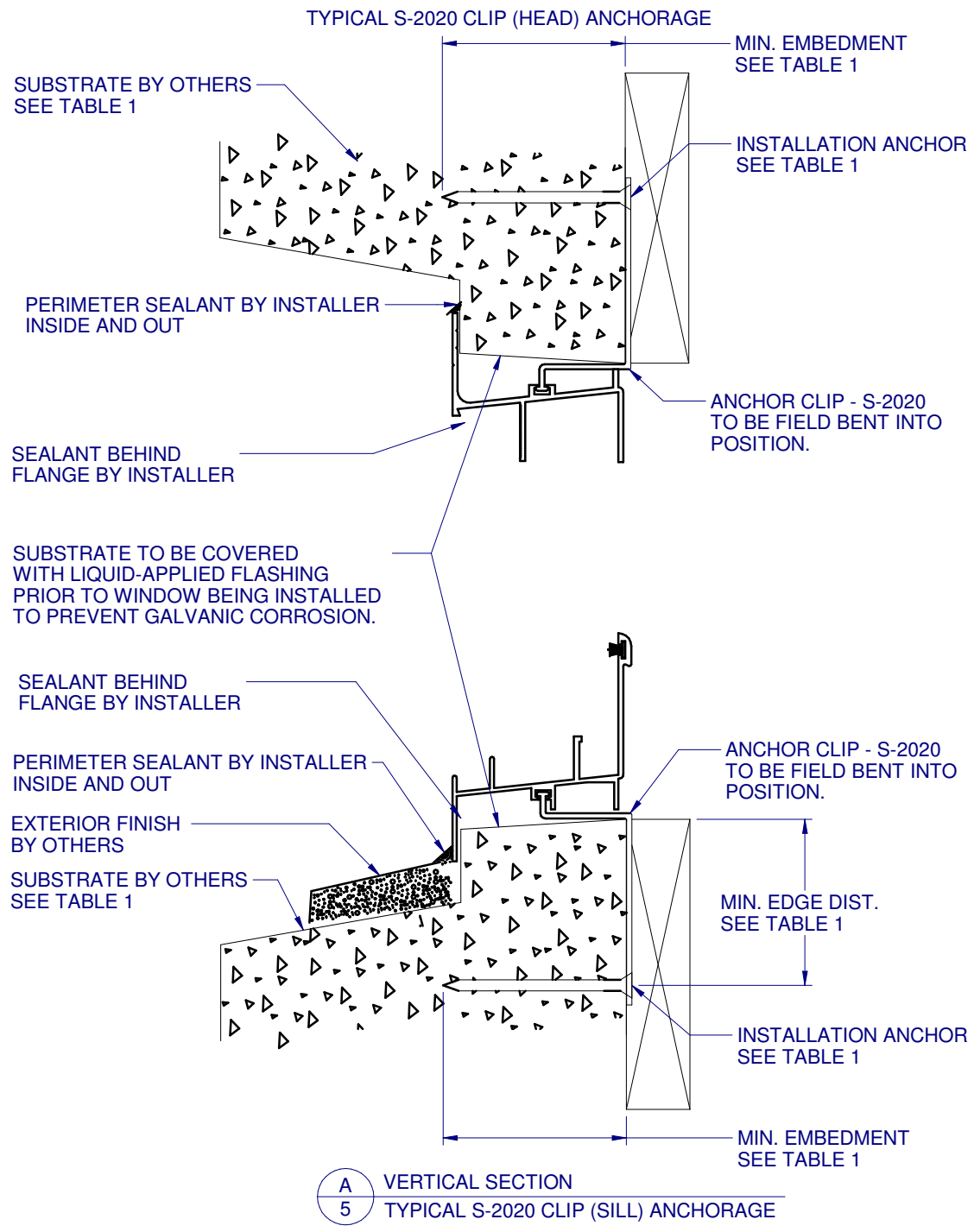

A VERTICAL SECTION
5 TYPICAL S-2020 CLIP (SILL) ANCHORAGE

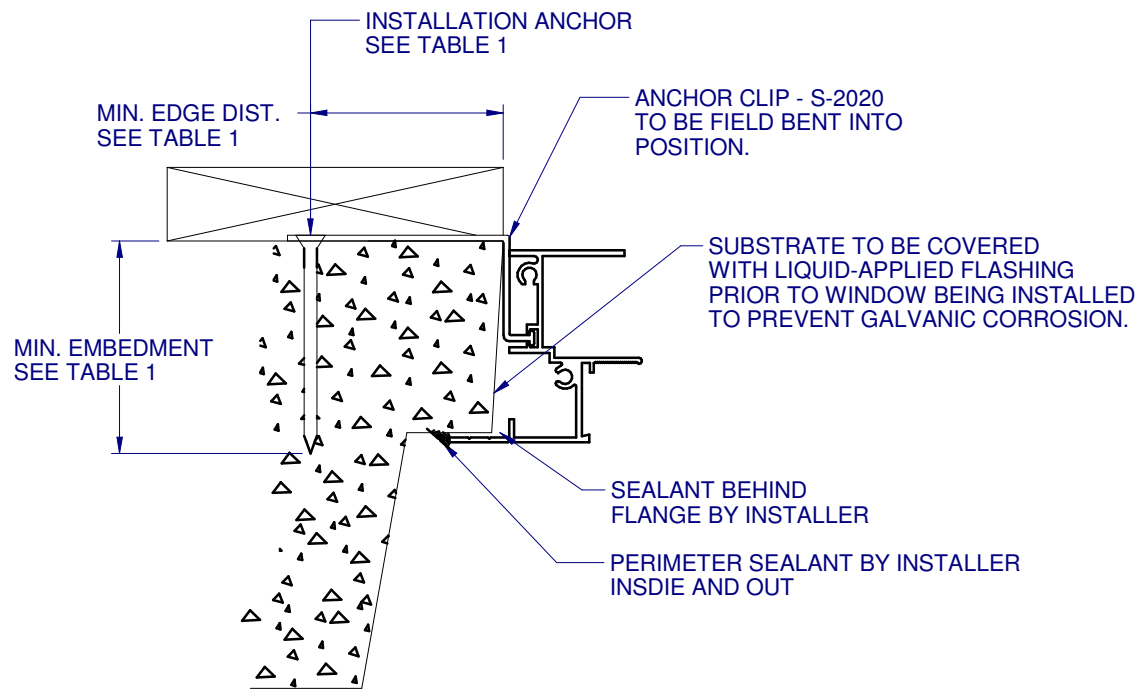

B HORIZONTAL SECTION
5 TYPICAL S-2020 (JAMB) ANCHORAGE

4/3/2015

LUCAS A. TURNER, P.E.
FL PE # 58201
1239 JABARA AVE.
NORTH PORT, FL 34288
PH. 941-380-1574

SUBSTRATE TYPE	ANCHOR TYPE	MIN. EMBEDMENT	MIN. EDGE DIST.
CONCRETE (2.0 KSI MIN.)	3/16" ITW TAPCON	1-3/4"	2"
CONCRETE (2.85 KSI MIN.)	3/16" ELCO ULTRACON	1-3/4"	2"
2x MIN. SPRUCE-PINE-FIR WOOD (G=0.42 MIN.)	3/16" ITW TAPCON OR ELCO ULTRACON	1-1/2"	7/8"
2x MIN. SPRUCE-PINE-FIR WOOD (G=0.42 MIN.)	#10 WOOD SCREW	1-1/2"	7/8"

SHEET DESCRIPTION: INSTALLATION DETAIL - 1x WITH CLIPS	
DRAWN BY: ADE	DATE: 12/22/13
DWG #: CWS-880	REV.: A
SCALE: 1:2	SHEET 5 OF 6

**3500 ALUM.
SINGLE HUNG
NON-IMPACT**

										02/24/15	DATE:
										EMK	BY:
										UPDATED PER 2014	NO.:
											DESCRIPTION:
											REVISIONS



LT
4/3/2015

LUCAS A. TURNER, P.E.
FL PE # 58201
1239 JABARA AVE.
NORTH PORT, FL 34288
PH. 941-380-1574

SHEET DESCRIPTION:
**INSTALLATION DETAIL -
2x WITH CLIPS**

DRAWN BY: ADE	DATE: 12/22/13
DWG #: CWS-880	REV.: A
SCALE: 1:2	SHEET 6 OF 6

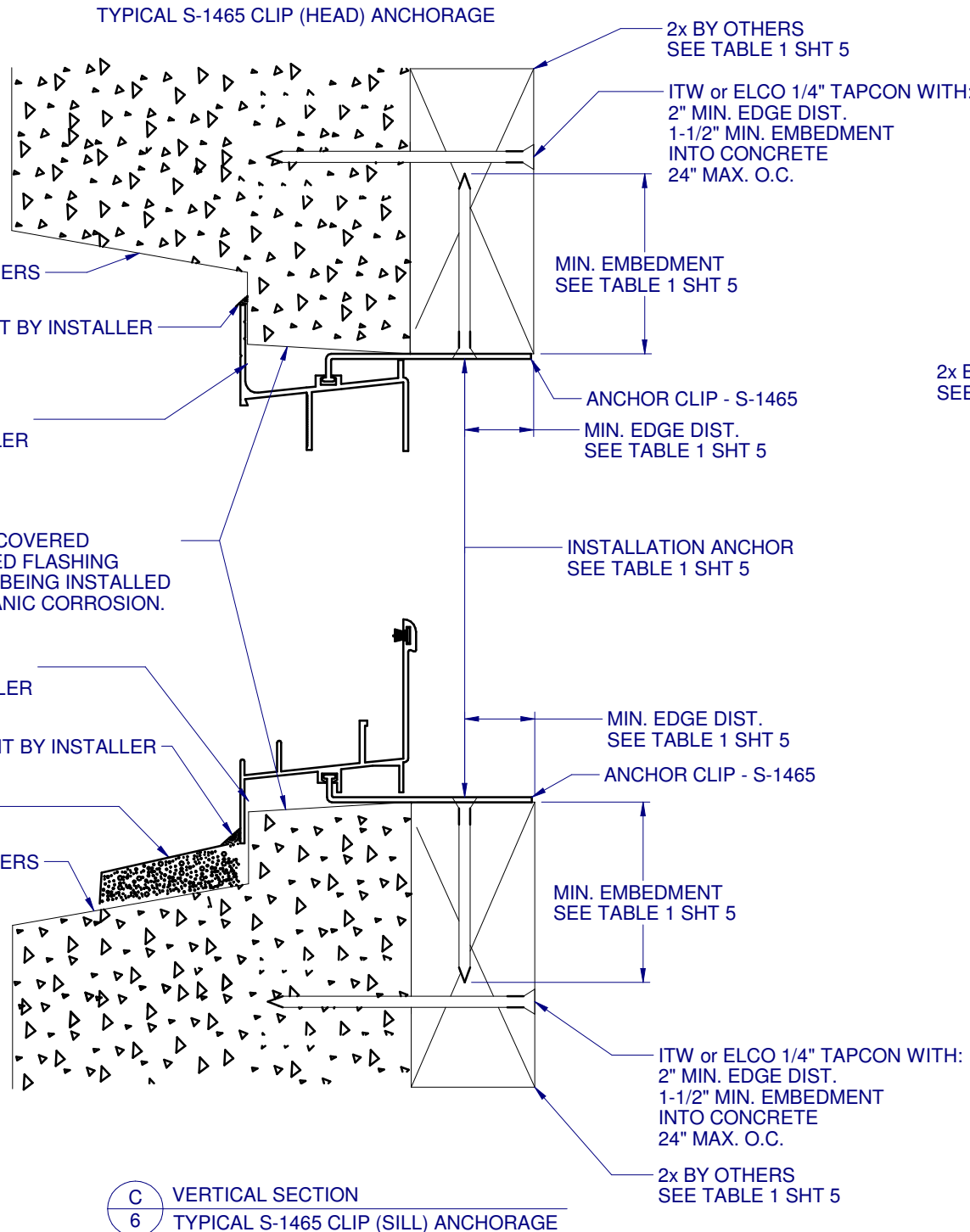

C VERTICAL SECTION
6 TYPICAL S-1465 CLIP (SILL) ANCHORAGE

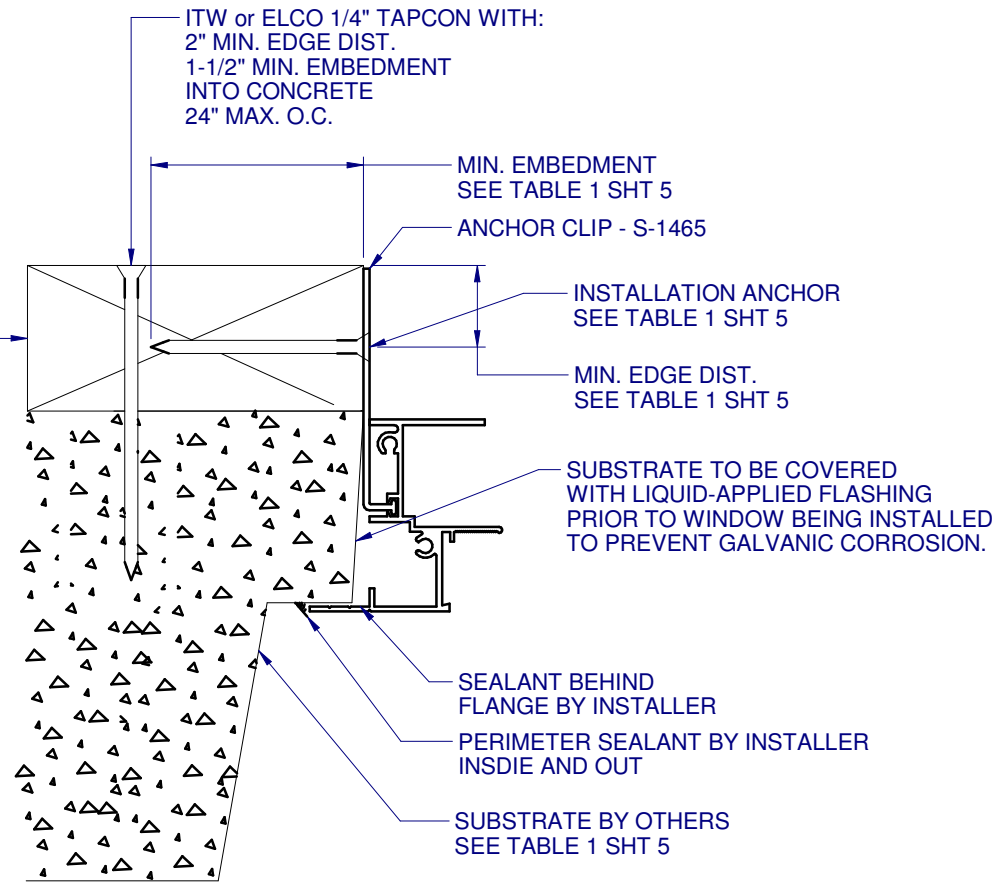

D HORIZONTAL SECTION
6 TYPICAL S-1465 (JAMB) ANCHORAGE