



MANDALAY BAY[®]
RESORT AND CASINO, LAS VEGAS

CAPACITIES GUIDE

YOU HAVE TO BE HERE



MGM RESORTS

HERE, MEETINGS ARE PRODUCTIVE AND PICTURESQUE

As the fifth largest convention center in the U.S. with 2.1 million square feet of meeting space, the newly refreshed Mandalay Bay Convention Center is equipped with flexible space and technology designed for your next event.

Our resort has a full team of Certified Meeting Professionals on staff, eager to bring any convention or special gathering to life.



YOU HAVE TO BE HERE

MANDALAY BAY CAMPUS MAP - BEACH LEVEL

- Convention Center
- Rest & Relaxation
- Dining
- Retail
- Entertainment

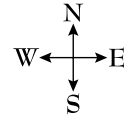

Take a Tour



SOUTH CONVENTION CENTER





MANDALAY BAY
RESORT AND CASINO, LAS VEGAS





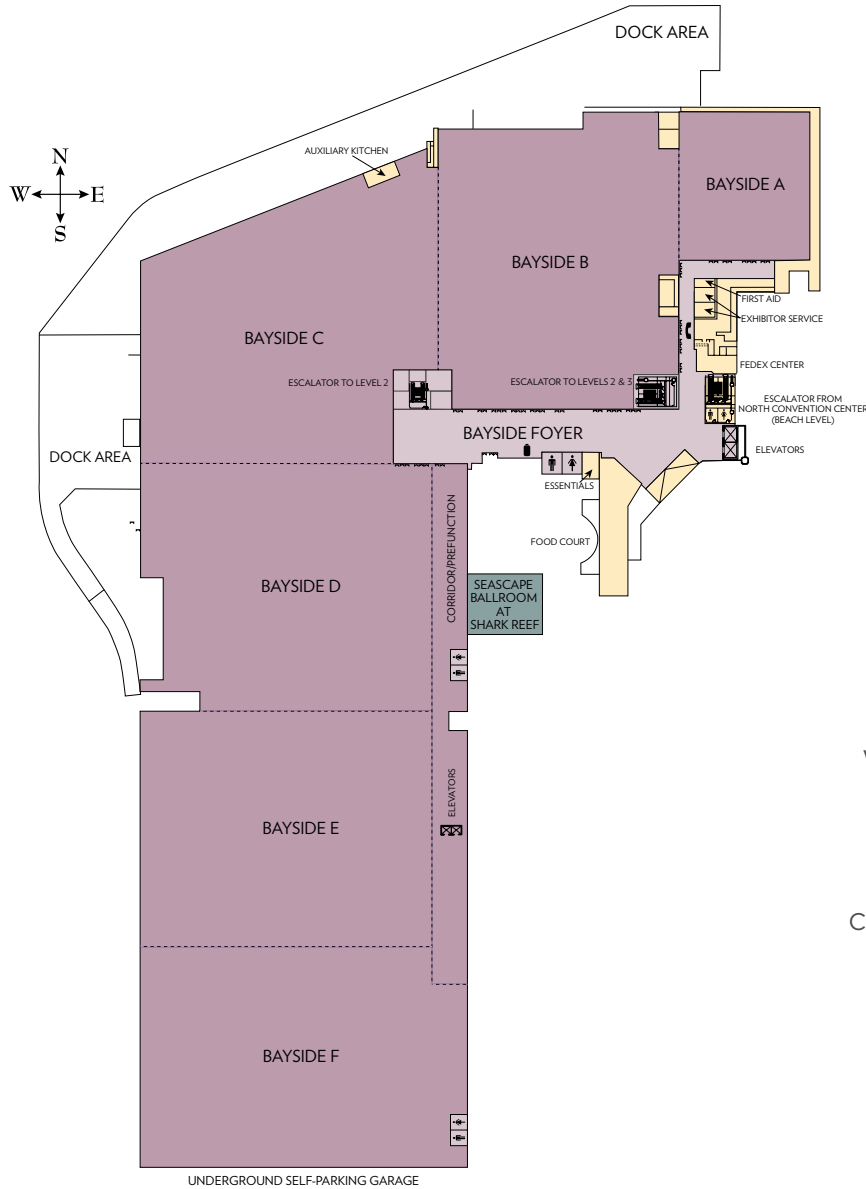

MGM RESORTS

YOU HAVE TO BE HERE

SOUTH CONVENTION CENTER – LEVEL 1



Map Legend

- Men's Room 
- Women's Room 
- Telephones 
- Charging Station 

	Square Feet	Dimensions (LxW)	Ceiling Height	10x10	Load Limit	Columns Centers
Bayside Exhibition Halls	861,231		30'	4,067	350 lbs	60' centers N/S
Bayside A	48,722	237' x 206'	30'	244	350 lbs	60' centers E/W
Bayside B	169,587	386' x 447'	30'	826	350 lbs	60' centers E/W
Bayside C	177,929	454' x 397'	30'	939	350 lbs	60' centers E/W
Bayside D	170,052	450' x 400'	30'	869	350 lbs	60' centers E/W
Bayside E	146,979	396' x 372'	30'	770	250 lbs	108' centers E/W
Bayside F	147,961	336' x 441'	30'	725	250 lbs	108' centers E/W
Bayside Foyer	57,636					
Bayside D Prefunction	9,666					
Bayside E/F Prefunction	25,780					

	Square Feet	Dimensions (LxW)	Ceiling Height	Theatre	Classroom	Rounds of 10	Reception	Conference
Seascape Ballroom at Shark Reef	2,000*	28' x 50'	8'9"	167	67	80	98	30

Length = North to South. Width = East to West.

*Includes outdoor patio.

SOUTH CONVENTION CENTER - LEVEL 2

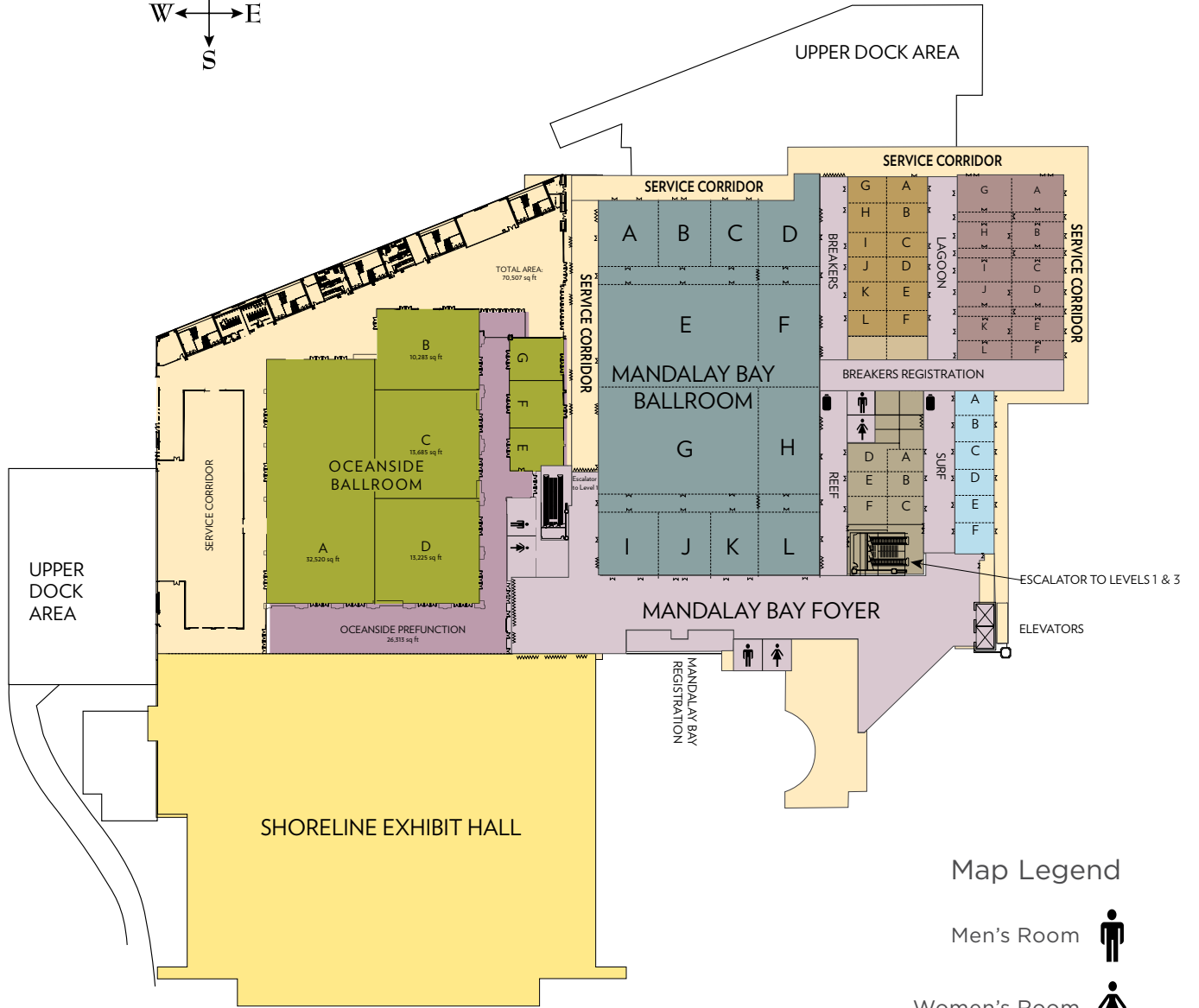
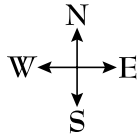

SOUTH CONVENTION CENTER – LEVEL 2

	Square Feet	Dimensions (LxW)	Ceiling Height	10x10		Load Limit	Columns Centers		
Shoreline Exhibit Hall	181,800	450' x 404'	30'	910		350 lbs	120' centers N/S		
	Square Feet	Dimensions (LxW)	Ceiling Height	Theatre	Classroom	Rounds of 10	Reception	Conference	Hollow Square
Mandalay Bay Ballroom	95,388	226' x 406'	30'	9,408	5,740	4,200	6,667	N/A	N/A
Corridor 1	3,391	166'6" x 20'	30'	N/A	N/A	N/A	N/A	N/A	N/A
Corridor 2	1,259	59'6" x 20'	30'	N/A	N/A	N/A	N/A	N/A	N/A
Corridor 3	3,399	166'6" x 20'	30'	N/A	N/A	N/A	N/A	N/A	N/A
Corridor 4	1,259	59'6" x 20'	30'	N/A	N/A	N/A	N/A	N/A	N/A
Mandalay Bay A	4,401	59'6" x 65'6"	30'	354	228	200	316	60	82
Mandalay Bay AB	8,126	115'6" x 65'6"	30'	728	424	350	588	N/A	N/A
Mandalay Bay ABC	11,524	166'6" x 65'6"	30'	1,108	622	550	837	N/A	N/A
Mandalay Bay ABCD	15,868	226' x 65'6"	30'	1,534	908	750	1,153	N/A	N/A
Mandalay Bay ABCDEF	47,223	226' x 200'6"	30'	4,116	2,542	1,950	3,286	N/A	N/A
Mandalay Bay ABCDEFGH	75,361	226' x 320'6"	30'	6,958	4,428	3,300	5,182	N/A	N/A
Mandalay Bay ABCE	34,420	166'6" x 200'6"	30'	2,940	1,860	1,560	2,385	N/A	N/A
Mandalay Bay ABCEG	54,909	166'6" x 320'6"	30'	4,970	3,120	2,640	3,761	N/A	N/A
Mandalay Bay ABCEGIJK	69,465	166'6" x 406'	30'	6,580	4,140	3,480	4,832	N/A	N/A
Mandalay Bay B	3,725	56' x 65'6"	30'	364	230	180	272	60	82
Mandalay Bay BC	7,123	107' x 65'6"	30'	636	380	350	520	N/A	N/A
Mandalay Bay BCD	11,467	166'6" x 65'6"	30'	960	644	550	837	N/A	N/A
Mandalay Bay C	3,398	51' x 65'6"	30'	336	210	180	248	60	76
Mandalay Bay CD	7,742	110'6" x 65'6"	30'	650	380	350	564	N/A	N/A
Mandalay Bay D	4,344	59'6" x 65'6"	30'	354	250	200	316	60	80
Mandalay Bay E	19,505	166'6" x 115'	30'	1,628	1,008	800	1,318	N/A	N/A
Mandalay Bay EF	26,705	226' x 115'	30'	2,376	1,512	1,120	1,817	N/A	N/A
Mandalay Bay EFGH	54,843	226' x 235'	30'	5,390	3,034	2,250	3,713	N/A	N/A
Mandalay Bay EFGHIJKL	74,870	226' x 320'6"	30'	7,546	4,428	3,300	5,182	N/A	N/A
Mandalay Bay EG	39,994	166'6" x 235'	30'	3,920	2,220	1,800	2,694	N/A	N/A
Mandalay Bay EGIJK	54,550	166'6" x 320'6"	30'	5,390	3,120	2,640	3,761	N/A	N/A
Mandalay Bay F	7,200	59'6" x 115'	30'	642	442	400	498	N/A	N/A
Mandalay Bay FH	14,849	59'6" x 235'	30'	1,466	978	600	1,018	N/A	N/A
Mandalay Bay G	20,489	166'6" x 120'	30'	1,702	1,008	800	1,376	N/A	N/A
Mandalay Bay GH	28,138	226' x 120'	30'	2,484	1,512	1,120	1,896	N/A	N/A
Mandalay Bay GHIJKL	48,165	226' x 205'6"	30'	4,116	2,542	1,950	3,365	N/A	N/A
Mandalay Bay GIJK	35,045	166'6" x 205'6"	30'	2,940	1,860	1,680	2,442	N/A	N/A
Mandalay Bay H	7,649	59'6" x 120'	30'	676	407	400	520	N/A	N/A
Mandalay Bay I	3,954	59'6" x 65'6"	30'	305	228	200	316	60	80
Mandalay Bay IJ	7,709	115'6" x 65'6"	30'	728	428	350	588	N/A	N/A
Mandalay Bay IJK	11,157	166'6" x 65'6"	30'	1,108	622	550	837	N/A	N/A
Mandalay Bay IJKL	15,369	226' x 65'6"	30'	1,534	908	750	1,153	N/A	N/A
Mandalay Bay J	3,755	56' x 65'6"	30'	364	230	180	272	60	76
Mandalay Bay JK	7,203	107' x 65'6"	30'	620	380	300	520	N/A	N/A
Mandalay Bay JKL	11,415	166'6" x 65'6"	30'	1,088	644	550	837	N/A	N/A
Mandalay Bay K	3,448	51' x 65'6"	30'	336	210	180	248	60	70
Mandalay Bay KL	7,660	110'6" x 65'6"	30'	650	380	350	564	N/A	N/A
Mandalay Bay L	4,212	59'6" x 65'6"	30'	354	250	200	316	60	82
Mandalay Foyer	50,220	540' x 93'	30'	N/A	N/A	N/A	3,348	N/A	N/A
Mandalay Bay Registration North (Office)	280	40' x 7'	30'	N/A	N/A	N/A	N/A	N/A	N/A
Mandalay Bay Registration North (Desk)	400	40' x 10'	30'	N/A	N/A	N/A	N/A	N/A	N/A
Mandalay Bay Registration South (Office)	828	46' x 18'	30'	N/A	N/A	N/A	N/A	N/A	N/A
Mandalay Bay Registration South (Desk)	410	41' x 10'	30'	N/A	N/A	N/A	N/A	N/A	N/A

Length = North to South. Width = East to West.

Classroom seating based on three people per 6' table. Capacities are subject to change based on allowances for head tables, staging, audiovisual and catering requirements.

SOUTH CONVENTION CENTER – LEVEL 2

	Square Feet	Dimensions (LxW)	Ceiling Height	Theatre	Classroom	Rounds of 10	Reception	Conference	Hollow Square
Breakers	15,138	87' x 174'	18'	1,621	906	910	1,027	N/A	N/A
Breakers A	1,260	45' x 28'	18'	130	73	70	83	36	46
Breakers AB	2,745	45' x 61'	18'	294	164	160	186	N/A	N/A
Breakers ABC	3,915	45' x 87'	18'	417	233	230	264	N/A	N/A
Breakers ABCD	5,085	45' x 113'	18'	541	302	300	343	N/A	N/A
Breakers ABCDE	6,570	45' x 146'	18'	701	392	390	444	N/A	N/A
Breakers ABCDEF	7,830	45' x 174'	18'	838	469	470	531	N/A	N/A
Breakers ABGH	5,307	87' x 61'	18'	568	317	320	360	N/A	N/A
Breakers ABCGHI	7,569	87' x 87'	18'	806	450	450	510	N/A	N/A
Breakers ABCDGHJI	9,831	87' x 113'	18'	1,046	585	590	663	N/A	N/A
Breakers ABCDEFGHIJK	12,702	87' x 146'	18'	1,355	757	760	858	N/A	N/A
Breakers AG	2,436	87' x 28'	18'	252	141	140	159	N/A	N/A
Breakers B	1,485	45' x 33'	18'	152	85	90	96	36	46
Breakers BC	2,655	45' x 59'	18'	279	156	160	177	N/A	N/A
Breakers BCD	3,825	45' x 85'	18'	403	225	230	255	N/A	N/A
Breakers BCDE	5,310	45' x 118'	18'	564	315	320	357	N/A	N/A
Breakers BCDEF	6,570	45' x 146'	18'	700	391	390	443	N/A	N/A
Breakers BCHI	5,133	87' x 59'	18'	540	302	300	342	N/A	N/A
Breakers BCDHIJ	7,395	87' x 85'	18'	778	435	440	493	N/A	N/A
Breakers BCDEHIJK	10,266	87' x 118'	18'	1,090	609	610	690	N/A	N/A
Breakers BCDEFHIJKL	12,702	87' x 146'	18'	1,353	756	760	857	N/A	N/A
Breakers BH	2,871	87' x 33'	18'	293	164	160	186	N/A	N/A
Breakers C	1,170	45' x 26'	18'	130	73	70	83	36	46
Breakers CD	2,340	45' x 52'	18'	246	138	140	156	N/A	N/A
Breakers CDE	3,825	45' x 85'	18'	407	228	230	258	N/A	N/A
Breakers CDEF	5,085	45' x 113'	18'	542	303	300	343	N/A	N/A
Breakers CDIJ	4,524	87' x 52'	18'	476	266	270	302	N/A	N/A
Breakers CDEIJK	7,395	87' x 85'	18'	788	440	440	499	N/A	N/A
Breakers CDEFIJKL	9,831	87' x 113'	18'	1,049	586	590	664	N/A	N/A
Breakers CI	2,262	87' x 26'	18'	252	141	140	159	N/A	N/A
Breakers D	1,170	45' x 26'	18'	130	73	70	83	36	46
Breakers DE	2,655	45' x 59'	18'	283	158	160	179	N/A	N/A
Breakers DEF	3,915	45' x 87'	18'	418	234	230	265	N/A	N/A
Breakers DEJK	5,133	87' x 59'	18'	547	306	310	347	N/A	N/A
Breakers DEFJKL	7,569	87' x 87'	18'	808	452	450	512	N/A	N/A
Breakers DJ	2,262	87' x 26'	18'	252	141	140	159	N/A	N/A
Breakers E	1,485	45' x 33'	18'	149	83	90	95	36	46
Breakers EF	2,745	45' x 61'	18'	294	164	160	186	N/A	N/A
Breakers EFKL	5,307	87' x 61'	18'	568	317	320	360	N/A	N/A
Breakers EK	2,871	87' x 33'	18'	288	161	160	183	N/A	N/A
Breakers F	1,260	45' x 28'	18'	135	75	80	86	36	46
Breakers FL	2,436	87' x 28'	18'	261	146	150	165	N/A	N/A
Breakers G	1,176	42' x 28'	18'	122	68	70	77	34	42
Breakers GH	2,562	42' x 61'	18'	274	153	150	174	N/A	N/A
Breakers GHI	3,654	42' x 87'	18'	389	217	220	246	N/A	N/A
Breakers GHIJ	4,746	42' x 113'	18'	505	282	280	320	N/A	N/A
Breakers GHIJK	6,132	42' x 146'	18'	654	366	370	414	N/A	N/A
Breakers GHIJKL	7,308	42' x 174'	18'	783	437	440	496	N/A	N/A
Breakers H	1,386	42' x 33'	18'	141	79	80	90	34	42
Breakers HI	2,478	42' x 59'	18'	261	146	150	165	N/A	N/A
Breakers HIJ	3,570	42' x 85'	18'	376	210	210	238	N/A	N/A
Breakers HIJK	4,956	42' x 118'	18'	526	294	290	333	N/A	N/A
Breakers HIJKL	6,132	42' x 146'	18'	652	364	360	413	N/A	N/A
Breakers I	1,092	42' x 26'	18'	122	68	60	77	34	42
Breakers IJ	2,184	42' x 52'	18'	230	128	130	146	N/A	N/A

Length = North to South. Width = East to West.

Classroom seating based on three people per 6' table. Capacities are subject to change based on allowances for head tables, staging, audiovisual and catering requirements.

SOUTH CONVENTION CENTER – LEVEL 2

	Square Feet	Dimensions (LxW)	Ceiling Height	Theatre	Classroom	Rounds of 10	Reception	Conference	Hollow Square
Breakers IJK	3,570	42' x 85'	18'	380	212	210	241	N/A	N/A
Breakers IJKL	4,746	42' x 113'	18'	506	283	280	321	N/A	N/A
Breakers J	1,092	42' x 26'	18'	122	68	60	77	34	42
Breakers JK	2,478	42' x 59'	18'	264	148	150	167	N/A	N/A
Breakers JKL	3,654	42' x 87'	18'	390	218	220	247	N/A	N/A
Breakers K	1,386	42' x 33'	18'	139	78	80	88	34	42
Breakers KL	2,562	42' x 61'	18'	274	153	150	174	N/A	N/A
Breakers L	1,176	42' x 28'	18'	126	70	70	80	34	42
Breakers Foyer	2,700	90' x 30'	N/A	N/A	N/A	N/A	180	N/A	N/A
Breakers Registration North (Office)	828	46' x 18'	12'	N/A	N/A	N/A	N/A	N/A	N/A
Breakers Registration North (Desk)	440	40' x 11'	N/A	N/A	N/A	N/A	N/A	N/A	N/A
Breakers Registration South (Office)	828	46' x 18'	12'	N/A	N/A	N/A	N/A	N/A	N/A
Breakers Registration South (Desk)	440	40' x 11'	N/A	N/A	N/A	N/A	N/A	N/A	N/A

	Square Feet	Dimensions (LxW)	Ceiling Height	Theatre	Classroom	Rounds of 10	Reception	Conference	Hollow Square
Surf	7,920	44' x 180'	18'	845	472	470	535	N/A	N/A
Surf A	1,276	44' x 29'	18'	132	74	80	84	34	43
Surf AB	2,596	44' x 59'	18'	277	155	160	175	N/A	N/A
Surf ABC	3,916	44' x 89'	18'	416	232	230	263	N/A	N/A
Surf ABCD	5,148	44' x 117'	18'	548	306	310	347	N/A	N/A
Surf ABCDE	6,468	44' x 147'	18'	687	384	380	435	N/A	N/A
Surf B	1,320	44' x 30'	18'	139	78	80	88	34	43
Surf BC	2,640	44' x 60'	18'	278	155	160	176	N/A	N/A
Surf BCD	3,872	44' x 88'	18'	417	233	230	264	N/A	N/A
Surf BCDE	5,192	44' x 118'	18'	556	311	310	352	N/A	N/A
Surf BCDEF	6,644	44' x 151'	18'	695	388	390	440	N/A	N/A
Surf C	1,320	44' x 30'	18'	139	78	80	88	34	43
Surf CD	2,552	44' x 58'	18'	278	155	160	176	N/A	N/A
Surf CDE	3,872	44' x 88'	18'	417	233	230	264	N/A	N/A
Surf CDEF	5,324	44' x 121'	18'	556	311	310	352	N/A	N/A
Surf D	1,232	44' x 28'	18'	139	78	80	88	34	43
Surf DE	2,552	44' x 58'	18'	278	155	160	176	N/A	N/A
Surf DEF	4,004	44' x 91'	18'	417	233	230	264	N/A	N/A
Surf E	1,320	44' x 30'	18'	139	78	80	88	34	43
Surf EF	2,772	44' x 63'	18'	278	155	160	176	N/A	N/A
Surf F	1,452	44' x 30'	18'	139	78	90	88	34	43
Surf Foyer	7,200	240' x 30'	N/A	N/A	N/A	N/A	480	N/A	N/A

	Square Feet	Dimensions (LxW)	Ceiling Height	Theatre	Classroom	Rounds of 10	Reception	Conference	Hollow Square
Lagoon	23,985	117' x 205'	18'	2,549	1,425	1,430	1,615	N/A	N/A
Corridor 1	840	15' x 56'	18'	N/A	N/A	N/A	N/A	N/A	N/A
Corridor 2	915	15' x 61'	18'	N/A	N/A	N/A	N/A	N/A	N/A
Corridor 3	840	15' x 56'	18'	N/A	N/A	N/A	N/A	N/A	N/A
Corridor 4	915	15' x 61'	18'	N/A	N/A	N/A	N/A	N/A	N/A
Corridor 5	840	15' x 56'	18'	N/A	N/A	N/A	N/A	N/A	N/A
Corridor 6	915	15' x 61'	18'	N/A	N/A	N/A	N/A	N/A	N/A
Lagoon A	1,848	56' x 33'	18'	212	119	120	134	44	54
Lagoon AB	4,200	56' x 75'	18'	445	249	250	282	N/A	N/A
Lagoon ABC	6,384	56' x 114'	18'	673	376	380	427	N/A	N/A
Lagoon ABCD	7,784	56' x 139'	18'	824	460	460	522	N/A	N/A
Lagoon ABCDE	10,136	56' x 181'	18'	1,073	600	600	679	N/A	N/A
Lagoon ABCDEF	11,480	56' x 205'	18'	1,220	682	680	773	N/A	N/A

Length = North to South. Width = East to West.

Classroom seating based on three people per 6' table. Capacities are subject to change based on allowances for head tables, staging, audiovisual and catering requirements.

SOUTH CONVENTION CENTER – LEVEL 2

	Square Feet	Dimensions (LxW)	Ceiling Height	Theatre	Classroom	Rounds of 10	Reception	Conference	Hollow Square
Lagoon AG	3,861	117' x 33'	18'	443	248	250	281	N/A	N/A
Lagoon ABGH	8,775	117' x 75'	18'	927	518	520	587	N/A	N/A
Lagoon ABCGHI	13,338	117' x 114'	18'	1,407	786	790	891	N/A	N/A
Lagoon ABCDGHJI	16,263	117' x 139'	18'	1,718	960	960	1,088	N/A	N/A
Lagoon ABCDEGHIJK	21,177	117' x 181'	18'	2,241	1,253	1,250	1,420	N/A	N/A
Lagoon B	1,512	56' x 27'	18'	171	96	100	108	44	54
Lagoon BC	3,696	56' x 66'	18'	392	219	220	248	N/A	N/A
Lagoon BCD	5,096	56' x 91'	18'	539	301	300	342	N/A	N/A
Lagoon BCDE	7,448	56' x 133'	18'	790	441	440	500	N/A	N/A
Lagoon BCDEF	8,792	56' x 157'	18'	936	523	520	593	N/A	N/A
Lagoon BH	3,159	117' x 27'	18'	357	200	200	226	N/A	N/A
Lagoon BCHI	7,722	117' x 66'	18'	819	458	460	519	N/A	N/A
Lagoon BCDHIJ	10,647	117' x 91'	18'	1,127	630	630	714	N/A	N/A
Lagoon BCDEHIJK	15,561	117' x 133'	18'	1,650	922	920	1,045	N/A	N/A
Lagoon BCDEFHIJKL	18,369	117' x 157'	18'	1,955	1,093	1,090	1,238	N/A	N/A
Lagoon C	1,344	56' x 24'	18'	156	87	90	99	44	54
Lagoon CD	2,744	56' x 49'	18'	290	162	160	184	N/A	N/A
Lagoon CDE	5,096	56' x 91'	18'	539	301	300	342	N/A	N/A
Lagoon CDEF	6,440	56' x 115'	18'	687	384	380	435	N/A	N/A
Lagoon CI	2,808	117' x 24'	18'	326	182	180	207	N/A	N/A
Lagoon CDIJ	5,733	117' x 49'	18'	607	339	340	384	N/A	N/A
Lagoon CDEIJK	10,647	117' x 91'	18'	1,127	630	630	714	N/A	N/A
Lagoon CDEFIJKL	13,455	117' x 115'	18'	1,435	802	800	909	N/A	N/A
Lagoon D	1,400	56' x 25'	18'	156	87	90	99	44	54
Lagoon DE	3,752	56' x 67'	18'	398	222	220	252	N/A	N/A
Lagoon DEF	5,096	56' x 91'	18'	542	303	300	343	N/A	N/A
Lagoon DJ	2,925	117' x 25'	18'	326	182	170	207	N/A	N/A
Lagoon DEJK	7,839	117' x 67'	18'	831	465	470	526	N/A	N/A
Lagoon DEFJKL	10,647	117' x 91'	18'	1,133	633	630	718	N/A	N/A
Lagoon E	1,512	56' x 27'	18'	150	84	80	95	44	54
Lagoon EF	2,856	56' x 51'	18'	308	172	172	195	N/A	N/A
Lagoon EK	3,159	117' x 27'	18'	314	175	180	199	N/A	N/A
Lagoon EFKL	5,967	117' x 51'	18'	643	360	360	408	N/A	N/A
Lagoon F	1,344	56' x 24'	18'	153	86	90	97	44	54
Lagoon FL	2,808	117' x 24'	18'	320	179	180	203	N/A	N/A
Lagoon G	2,013	61' x 33'	18'	231	129	130	146	48	54
Lagoon GH*	4,575	61' x 75'	18'	483	270	270	306	N/A	N/A
Lagoon GHI*	6,954	61' x 114'	18'	737	412	410	467	N/A	N/A
Lagoon GHIJ*	8,479	61' x 139'	18'	896	501	500	567	N/A	N/A
Lagoon GHIJK*	11,041	61' x 181'	18'	1,169	653	650	740	N/A	N/A
Lagoon GHIJKL*	12,505	61' x 205'	18'	1,329	743	740	842	N/A	N/A
Lagoon H	1,647	61' x 27'	18'	186	104	100	118	48	52
Lagoon HI*	4,026	61' x 66'	18'	427	239	240	270	N/A	N/A
Lagoon HIJ*	5,551	61' x 91'	18'	587	328	330	372	N/A	N/A
Lagoon HIJK*	8,113	61' x 133'	18'	860	481	480	545	N/A	N/A
Lagoon HIJKL*	9,577	61' x 157'	18'	1,019	570	570	646	N/A	N/A
Lagoon I	1,464	61' x 24'	18'	170	95	100	108	48	56
Lagoon IJ	2,989	61' x 49'	18'	316	177	180	200	N/A	N/A
Lagoon IJK*	5,551	61' x 91'	18'	587	328	330	372	N/A	N/A
Lagoon IJKL*	7,015	61' x 115'	18'	748	418	420	474	N/A	N/A
Lagoon J	1,525	61' x 25'	18'	170	95	100	108	48	56
Lagoon JK*	4,087	61' x 67'	18'	433	242	240	274	N/A	N/A
Lagoon JKL*	5,551	61' x 91'	18'	591	330	330	374	N/A	N/A
Lagoon K	1,647	61' x 27'	18'	164	92	90	104	48	56
Lagoon KL	3,111	61' x 51'	18'	335	187	190	212	N/A	N/A
Lagoon L	1,464	61' x 24'	18'	167	93	90	106	48	56
Lagoon Foyer West	7,200	240' x 30'	N/A	N/A	N/A	N/A	480	N/A	N/A

Length = North to South. Width = East to West.

Classroom seating based on three people per 6' table. Capacities are subject to change based on allowances for head tables, staging, audiovisual and catering requirements.

SOUTH CONVENTION CENTER – LEVEL 2

	Square Feet	Dimensions (LxW)	Ceiling Height	Theatre	Classroom	Rounds of 10	Reception	Conference	Hollow Square
Reef	6,708	86' x 78'	18'	824	461	460	522	N/A	N/A
Reef A	817	43' x 19'	18'	92	51	50	58	35	40
Reef AB	2,107	43' x 49'	18'	224	125	130	142	N/A	N/A
Reef ABC	3,354	43' x 78'	18'	385	215	220	244	N/A	N/A
Reef AD	1,634	86' x 19'	18'	252	141	140	159	N/A	N/A
Reef ABDE	4,214	86' x 49'	18'	513	287	290	325	N/A	N/A
Reef B	1,290	43' x 30'	18'	137	77	80	87	35	44
Reef BC	2,537	43' x 59'	18'	295	165	170	187	N/A	N/A
Reef BE	2,580	86' x 30'	18'	275	154	154	174	N/A	N/A
Reef BCEF	5,074	86' x 59'	18'	591	330	330	374	N/A	N/A
Reef C	1,247	43' x 29'	18'	149	83	90	94	35	44
Reef CF	2,494	86' x 29'	18'	298	166	170	188	N/A	N/A
Reef D	817	43' x 19'	18'	92	51	50	58	35	44
Reef DE	2,107	43' x 49'	18'	256	143	140	162	N/A	N/A
Reef DEF	3,354	43' x 78'	18'	412	230	230	261	N/A	N/A
Reef E	1,290	43' x 30'	18'	137	77	80	87	35	44
Reef EF	2,537	43' x 59'	18'	295	165	170	187	N/A	N/A
Reef F	1,247	43' x 29'	18'	149	83	90	94	35	44

Length = North to South. Width = East to West.

Classroom seating based on three people per 6' table. Capacities are subject to change based on allowances for head tables, staging, audiovisual and catering requirements.

	Square Feet	Dimensions (LxW)	Ceiling Height	10x10	Load Limit	Columns Centers
Shoreline Exhibit Hall	181,800	450' x 404'	30'	910	350 lbs	120' centers N/S

	Square Feet	Dimensions (LxW)	Ceiling Height	Theatre	Classroom	Rounds of 10	Reception	Conference	Hollow Square
Oceanside	69,713			6,792	3,730	3,540	4,648	N/A	N/A
Oceanside A	32,520	120' x 271'		3,540	1,952	1,740	2,168	N/A	N/A
Oceanside B	10,283	113' x 91'		852	468	490	685	N/A	N/A
Oceanside C	13,685	115' x 119'		1,248	672	660	912	N/A	N/A
Oceanside D	13,225	115' x 115'		1,152	638	650	881	N/A	N/A
Oceanside ACD	59,430			6,129	3,162	3,250	3,962	N/A	N/A
Oceanside BCD	37,193	115' x 325'		4,152	2,212	1,900	2,479	N/A	N/A
Oceanside BC	23,968	115' x 210'		2,602	1,398	1,180	1,597	N/A	N/A
Oceanside CD	26,910	115' x 234'		2,902	1,546	1,340	1,793	N/A	N/A
Oceanside E	2,929	60' x 48'10"		318	124	140	195	40	54
Oceanside F	2,916	60' x 48'7"		318	124	140	194	40	54
Oceanside G	2,929	60' x 48'10"		318	124	140	195	40	54
Foyer	27,638								

All capacities and measurements are based on Clark County Fire Department guidelines.

Classroom will be set three seats per 6' table or four seats per 8' table. Banquet seating based on ten people at 6' round tables.

Capacities will change when staging, audiovisual and catering requirements are finalized.

Estimated dimensions are subject to change until final architectural drawings are approved.

SOUTH CONVENTION CENTER - LEVEL 3

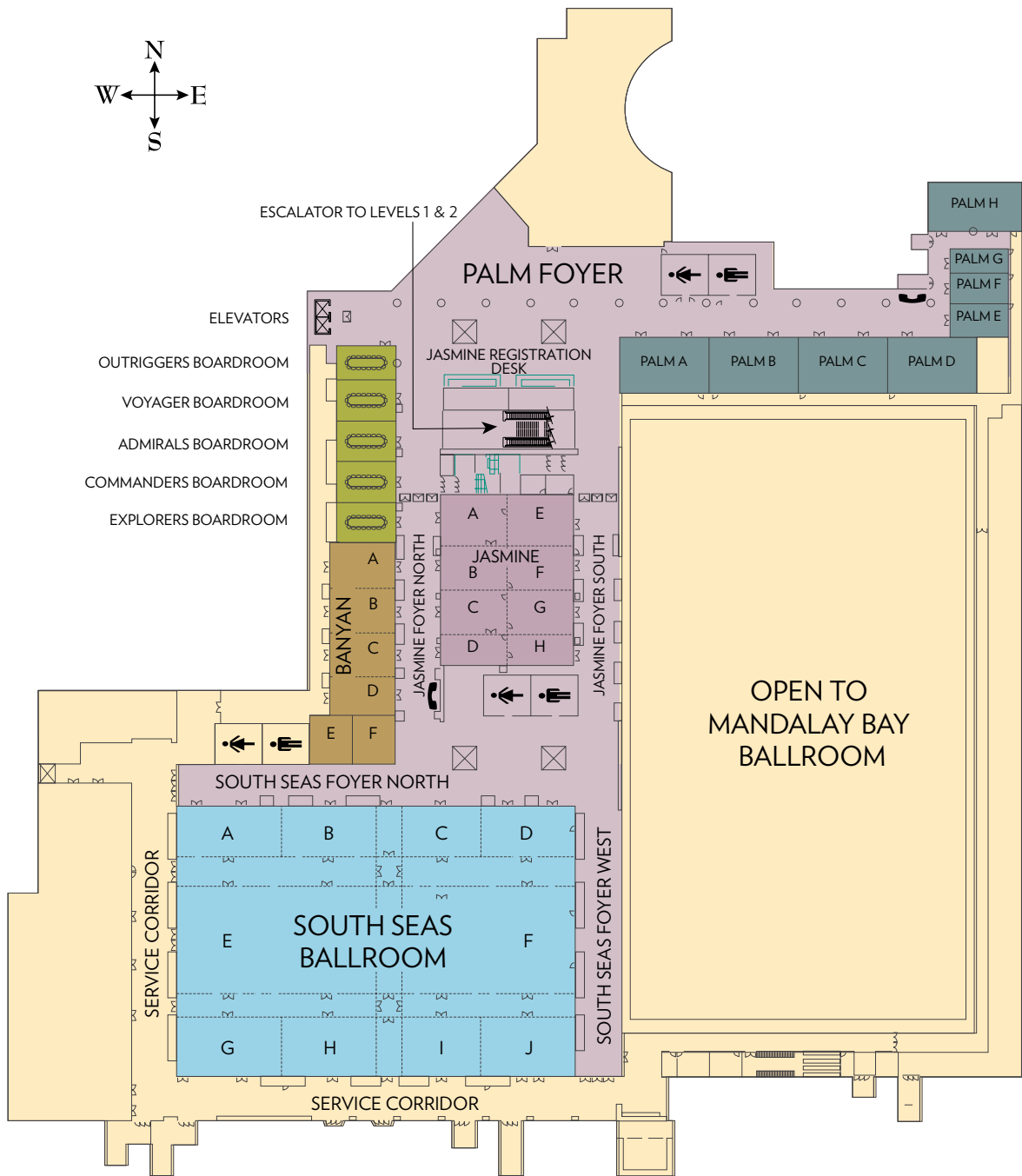

Map Legend

Men's Room 

Women's Room 

Telephones 

SOUTH CONVENTION CENTER – LEVEL 3

	Square Feet	Dimensions (LxW)	Ceiling Height	Theatre	Classroom	Rounds of 10	Reception	Conference	Hollow Square
<u>Admirals Boardroom</u>	1,204	43' x 28'	18'	N/A	N/A	N/A	N/A	20	N/A
<u>Commanders Boardroom</u>	1,204	43' x 28'	18'	N/A	N/A	N/A	N/A	20	N/A
<u>Explorers Boardroom</u>	1,204	43' x 28'	18'	N/A	N/A	N/A	N/A	20	N/A
<u>Outriggers Boardroom</u>	903	43' x 21'	18'	N/A	N/A	N/A	N/A	18	N/A
<u>Voyager Boardroom</u>	1,204	43' x 28'	18'	N/A	N/A	N/A	N/A	20	N/A

	Square Feet	Dimensions (LxW)	Ceiling Height	Theatre	Classroom	Rounds of 10	Reception	Conference	Hollow Square
<u>Jasmine</u>	9,374	86' x 109'	18'	1,113	622	620	705	N/A	N/A
Jasmine A	1,247	43' x 29'	18'	153	86	90	97	34	44
Jasmine AB	2,537	43' x 59'	18'	295	165	170	187	N/A	N/A
Jasmine ABC	3,827	43' x 89'	18'	433	242	240	274	N/A	N/A
Jasmine ABCD	4,687	43' x 109'	18'	556	311	310	352	N/A	N/A
Jasmine AE	2,494	86' x 29'	18'	307	171	170	194	N/A	N/A
Jasmine ABEF	5,074	86' x 59'	18'	591	330	330	374	N/A	N/A
Jasmine ABCEFG	7,654	86' x 89'	18'	865	484	480	548	N/A	N/A
Jasmine B	1,290	43' x 30'	18'	138	77	80	87	34	42
Jasmine BC	2,580	43' x 60'	18'	275	154	150	174	N/A	N/A
Jasmine BCD	3,440	43' x 80'	18'	366	205	210	232	N/A	N/A
Jasmine BF	2,580	86' x 30'	18'	275	154	150	174	N/A	N/A
Jasmine BCFG	5,160	86' x 60'	18'	549	307	310	348	N/A	N/A
Jasmine BCDFGH	6,880	86' x 80'	18'	733	409	410	464	N/A	N/A
Jasmine C	1,290	43' x 30'	18'	138	77	80	87	34	42
Jasmine CD	2,150	43' x 50'	18'	229	128	130	145	N/A	N/A
Jasmine CG	2,580	86' x 30'	18'	275	154	150	174	N/A	N/A
Jasmine CDGH	4,300	86' x 50'	18'	458	256	260	290	N/A	N/A
Jasmine D	860	43' x 20'	18'	92	51	50	58	34	40
Jasmine DH	1,720	86' x 20'	18'	183	102	100	116	N/A	N/A
Jasmine E	1,247	43' x 29'	18'	153	86	90	97	34	44
Jasmine EF	2,537	43' x 59'	18'	295	165	170	187	N/A	N/A
Jasmine EFG	3,827	43' x 89'	18'	433	242	240	274	N/A	N/A
Jasmine EFGH	4,687	43' x 109'	18'	556	311	310	352	N/A	N/A
Jasmine F	1,290	43' x 30'	18'	138	77	80	87	34	42
Jasmine FG	2,580	43' x 60'	18'	275	154	150	174	N/A	N/A
Jasmine FGH	3,440	43' x 80'	18'	367	205	210	233	N/A	N/A
Jasmine G	1,290	43' x 30'	18'	138	77	80	87	34	42
Jasmine GH	2,150	43' x 50'	18'	229	128	130	145	N/A	N/A
Jasmine H	860	43' x 20'	18'	128	72	70	81	34	42
Jasmine Reg Desk North (Office)	516	43' x 12'	12'	N/A	N/A	N/A	N/A	N/A	N/A
Jasmine Reg Desk North (Desk)	380	38' x 10'	N/A	N/A	N/A	N/A	N/A	N/A	N/A
Jasmine Reg Desk South (Office)	516	43' x 12'	12'	N/A	N/A	N/A	N/A	N/A	N/A
Jasmine Reg Desk South (Desk)	380	38' x 10'	N/A	N/A	N/A	N/A	N/A	N/A	N/A
Jasmine Foyer North	9,000	300' x 30'	N/A	N/A	N/A	N/A	600	N/A	N/A
Jasmine Foyer South	7,200	240' x 30'	N/A	N/A	N/A	N/A	480	N/A	N/A

Length = North to South. Width = East to West.

Classroom seating based on three people per 6' table. Capacities are subject to change based on allowances for head tables, staging, audiovisual and catering requirements.

SOUTH CONVENTION CENTER – LEVEL 3

	Square Feet	Dimensions (LxW)	Ceiling Height	Theatre	Classroom	Rounds of 10	Reception	Conference	Hollow Square
Banyan (includes A, B, C, D)	5,148	44' x 117'	18'	542	303	300	343	N/A	N/A
Banyan A	1,364	44' x 31'	18'	144	80	80	91	36	44
Banyan AB	2,684	44' x 61'	18'	283	158	160	179	N/A	N/A
Banyan ABC	4,004	44' x 91'	18'	421	236	240	267	N/A	N/A
Banyan B	1,320	44' x 30'	18'	139	78	80	88	36	44
Banyan BC	2,640	44' x 60'	18'	277	155	160	175	N/A	N/A
Banyan BCD	3,784	44' x 86'	18'	398	223	220	252	N/A	N/A
Banyan C	1,320	44' x 30'	18'	139	78	80	88	36	44
Banyan CD	2,464	44' x 56'	18'	259	145	150	164	N/A	N/A
Banyan D	1,144	44' x 26'	18'	120	67	70	76	36	42
Banyan E	896	28' x 32'	18'	98	55	60	62	22	32
Banyan F	896	28' x 32'	18'	98	55	60	62	22	32

	Square Feet	Dimensions (LxW)	Ceiling Height	Theatre	Classroom	Rounds of 10	Reception	Conference	Hollow Square
South Seas Ballroom	48,327	267' x 181'	26'	5,115	2,858	2,860	3,240	N/A	N/A
Corridor 1	2,700	135' x 20'	26'	N/A	N/A	N/A	N/A	N/A	N/A
Corridor 2	2,300	115' x 20'	26'	N/A	N/A	N/A	N/A	N/A	N/A
Corridor 3	2,160	135' x 16'	26'	N/A	N/A	N/A	N/A	N/A	N/A
Corridor 4	1,840	115' x 16'	26'	N/A	N/A	N/A	N/A	N/A	N/A
Corridor 5	1,224	17' x 72'	26'	N/A	N/A	N/A	N/A	N/A	N/A
Corridor 6	578	17' x 34'	26'	N/A	N/A	N/A	N/A	N/A	N/A
Corridor 7	663	17' x 39'	26'	N/A	N/A	N/A	N/A	N/A	N/A
South Seas A	2,448	72' x 34'	26'	261	146	150	166	54	62
South Seas AB	4,590	135' x 34'	26'	490	274	270	310	N/A	N/A
South Seas ABC	6,970	205' x 34'	26'	743	415	420	470	N/A	N/A
South Seas ABCD	9,078	267' x 34'	26'	970	542	540	614	N/A	N/A
South Seas ABE	17,010	135' x 126'	26'	1,794	1,003	1,000	1,136	N/A	N/A
South Seas ABCDEF	33,642	267' x 126'	26'	3,548	1,983	1,980	2,247	N/A	N/A
South Seas ABEGH	24,435	135' x 181'	26'	2,586	1,445	1,450	1,638	N/A	N/A
South Seas B	2,142	63' x 34'	26'	225	126	130	143	50	60
South Seas BC	4,522	133' x 34'	26'	481	269	270	305	N/A	N/A
South Seas BCD	6,630	195' x 34'	26'	708	396	400	448	N/A	N/A
South Seas C	1,802	53' x 34'	26'	200	112	110	127	44	52
South Seas CD	3,910	115' x 34'	26'	418	233	230	264	N/A	N/A
South Seas CDF	14,490	115' x 126'	26'	1,528	854	850	968	N/A	N/A
South Seas CDFIJ	20,815	115' x 181'	26'	2,419	1,352	1,350	1,532	N/A	N/A
South Seas D	2,108	62' x 34'	26'	218	122	120	138	48	56
South Seas E	9,720	135' x 72'	26'	1,023	572	570	648	N/A	N/A
South Seas EF	19,224	267' x 72'	26'	2,024	1,131	1,130	1,282	N/A	N/A
South Seas EGH	17,145	135' x 127'	26'	1,808	1,010	1,010	1,145	N/A	N/A
South Seas EFGHIJ	33,909	267' x 127'	26'	3,576	1,999	2,000	2,265	N/A	N/A
South Seas F	8,280	115' x 72'	26'	872	487	490	552	N/A	N/A
South Seas FIJ	14,605	115' x 127'	26'	1,540	861	860	976	N/A	N/A
South Seas G	2,808	72' x 39'	26'	288	161	161	182	54	66
South Seas GH	5,265	135' x 39'	26'	561	314	310	355	N/A	N/A
South Seas GHI	7,995	205' x 39'	26'	850	475	480	538	N/A	N/A
South Seas GHIJ	10,413	267' x 39'	26'	1,110	620	620	703	N/A	N/A
South Seas H	2,457	63' x 39'	26'	274	153	150	174	52	64
South Seas HI	5,187	133' x 39'	26'	551	308	310	349	N/A	N/A
South Seas HIJ	7,605	195' x 39'	26'	811	453	450	513	N/A	N/A
South Seas I	2,067	53' x 39'	26'	229	128	130	145	44	56
South Seas IJ	4,485	115' x 39'	26'	478	267	270	303	N/A	N/A
South Seas J	2,418	62' x 39'	26'	254	142	140	161	48	60
South Seas Foyer North	15,300	300' x 51'	N/A	N/A	N/A	N/A	1,033	N/A	N/A
South Seas Foyer West	5,400	180' x 30'	N/A	N/A	N/A	N/A	360	N/A	N/A

Length = North to South. Width = East to West.

Classroom seating based on three people per 6' table. Capacities are subject to change based on allowances for head tables, staging, audiovisual and catering requirements.

SOUTH CONVENTION CENTER – LEVEL 3

	Square Feet	Dimensions (L×W)	Ceiling Height	Theatre	Classroom	Rounds of 10	Reception	Conference	Hollow Square
Palm									
Palm A	2,109	57' x 37'	18'	229	128	130	145	46	58
Palm B	2,109	57' x 37'	18'	229	128	130	145	46	58
Palm C	2,109	57' x 37'	18'	229	128	130	145	46	58
Palm D	2,109	57' x 37'	18'	229	128	130	145	46	58
Palm E	836	38' x 22'	18'	93	52	50	59	30	36
Palm F	722	38' x 19'	18'	83	46	50	53	30	36
Palm G	570	38' x 15'	18'	68	38	40	43	30	34
Palm H	1,829	59' x 31'	18'	217	121	120	138	48	58
Palm Foyer	41,850	450' x 93'	N/A	N/A	N/A	N/A	2,800	N/A	N/A

Length = North to South. Width = East to West.

Classroom seating based on three people per 6' table. Capacities are subject to change based on allowances for head tables, staging, audiovisual and catering requirements.





NORTH CONVENTION CENTER





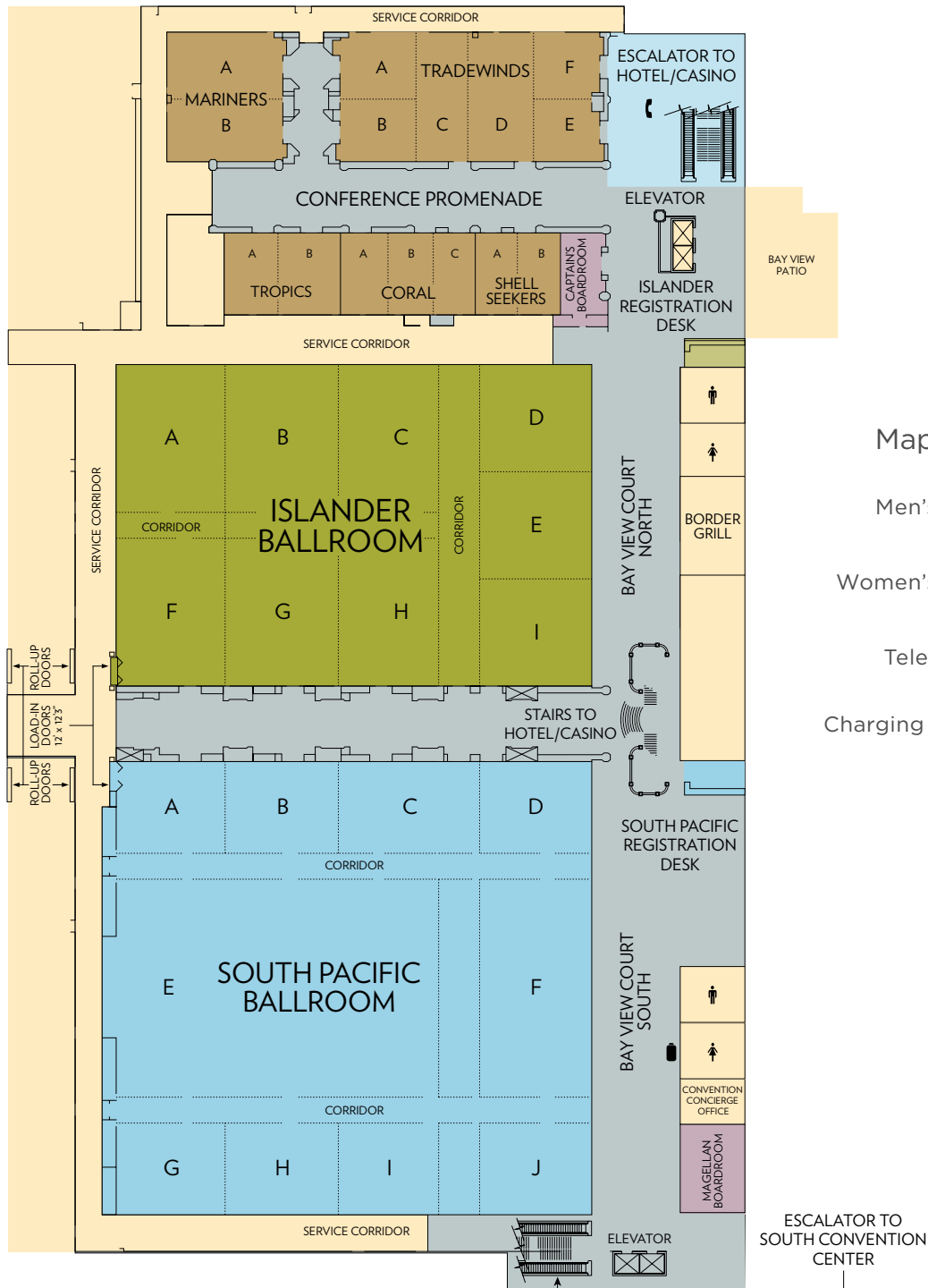

  **MANDALAY BAY | MGM RESORTS**
YOU HAVE TO BE HERE

NORTH CONVENTION CENTER



Map Legend

- Men's Room 
- Women's Room 
- Telephones 
- Charging Station 

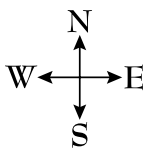

NORTH CONVENTION CENTER

	Square Feet	Dimensions (LxW)	Ceiling Height	Theatre	Classroom	Rounds of 10	Reception	Conference	Hollow Square
South Pacific Ballroom	44,496	206' x 216'	26'	4,728	2,642	2,640	2,994	N/A	N/A
Corridor 1	1,992	12' x 166'	26'	N/A	N/A	N/A	N/A	N/A	N/A
Corridor 2	600	12' x 50'	26'	N/A	N/A	N/A	N/A	N/A	N/A
Corridor 3	1,881	99' x 19'	26'	N/A	N/A	N/A	N/A	N/A	N/A
Corridor 4	1,764	42' x 19'	26'	N/A	N/A	N/A	N/A	N/A	N/A
Corridor 5	228	12' x 147'	26'	N/A	N/A	N/A	N/A	N/A	N/A
Corridor 6	600	12' x 50'	26'	N/A	N/A	N/A	N/A	N/A	N/A
Corridor 7	798	12' x 19'	26'	N/A	N/A	N/A	N/A	N/A	N/A
South Pacific A	2,050	41' x 50'	26'	217	121	120	137	36	48
South Pacific AB	4,100	41' x 100'	26'	437	244	240	277	N/A	N/A
South Pacific ABC	6,806	41' x 166'	26'	724	405	410	459	N/A	N/A
South Pacific ABCD	8,856	41' x 216'	26'	944	528	530	598	N/A	N/A
South Pacific ABCDEF	32,832	152' x 216'	26'	3,486	1,948	1,950	2,208	N/A	N/A
South Pacific ABCEGHI	34,196	206' x 166'	26'	3,632	2,030	2,032	2,300	N/A	N/A
South Pacific B	2,050	41' x 50'	26'	218	122	120	138	36	48
South Pacific BC	4,756	41' x 116'	26'	505	282	280	320	N/A	N/A
South Pacific BCD	2,706	41' x 166'	26'	724	405	410	459	N/A	N/A
South Pacific C	2,706	41' x 66'	26'	284	159	160	180	46	62
South Pacific CD	4,756	41' x 116'	26'	505	282	280	320	N/A	N/A
South Pacific D	2,050	41' x 50'	26'	218	122	120	138	36	48
South Pacific DF	7,600	152' x 50'	26'	804	451	449	508	N/A	N/A
South Pacific DFJ	10,300	206' x 50'	26'	1,089	612	606	689	N/A	N/A
South Pacific E	14,553	99' x 147'	26'	1,532	856	860	970	N/A	N/A
South Pacific EF	21,384	99' x 216'	26'	2,255	1,260	1,260	1,428	N/A	N/A
South Pacific EFGHIJ	33,048	153' x 216'	26'	3,503	1,957	1,960	2,218	N/A	N/A
South Pacific EGHI	22,491	153' x 147'	26'	2,356	1,323	1,309	1,519	N/A	N/A
South Pacific F	4,950	99' x 50'	26'	521	291	290	330	N/A	N/A
South Pacific FJ*	7,650	153' x 50'	26'	808	451	450	512	N/A	N/A
South Pacific G	2,100	42' x 50'	26'	220	123	120	139	36	48
South Pacific GH	4,200	42' x 100'	26'	443	247	250	280	N/A	N/A
South Pacific GHI	6,174	42' x 147'	26'	649	363	360	411	N/A	N/A
South Pacific GHIJ	9,072	42' x 216'	26'	956	534	530	605	N/A	N/A
South Pacific H	2,100	42' x 50'	26'	221	123	120	140	36	48
South Pacific HI	4,074	42' x 97'	26'	427	239	240	271	N/A	N/A
South Pacific HIJ	6,972	42' x 166'	26'	733	409	410	464	N/A	N/A
South Pacific I	1,974	42' x 47'	26'	204	114	120	129	36	48
South Pacific IJ	4,872	42' x 116'	26'	511	285	290	324	N/A	N/A
South Pacific J	2,100	42' x 50'	26'	221	123	120	140	36	48
South Pacific Registration (Office)	240	8' x 30'	12'	N/A	N/A	N/A	N/A	N/A	N/A
South Pacific Registration (Desk)	192	8' x 24'	N/A	N/A	N/A	N/A	N/A	N/A	N/A

	Square Feet	Dimensions (LxW)	Ceiling Height	Theatre	Classroom	Rounds of 10	Reception	Conference	Hollow Square
Islander Ballroom	31,536	146' x 216'	26'	3,351	1,873	1,870	2,123	N/A	N/A
Corridor 1	600	12' x 50'	26'	N/A	N/A	N/A	N/A	N/A	N/A
Corridor 2	600	12' x 50'	26'	N/A	N/A	N/A	N/A	N/A	N/A
Corridor 3	564	12' x 47'	26'	N/A	N/A	N/A	N/A	N/A	N/A
Corridor 4	2,774	146' x 19'	26'	N/A	N/A	N/A	N/A	N/A	N/A
Islander A	3,350	67' x 50'	26'	355	199	200	225	40	66
Islander AB	6,700	67' x 100'	26'	716	400	400	453	N/A	N/A
Islander ABC	9,849	67' x 147'	26'	1,050	587	590	665	N/A	N/A
Islander ABCFGH	21,462	146' x 147'	26'	2,278	1,273	1,270	1,443	N/A	N/A
Islander ABFG	14,600	146' x 100'	26'	1,554	868	870	984	N/A	N/A
Islander AF	7,300	146' x 50'	26'	771	431	430	488	N/A	N/A
Islander B	3,350	67' x 50'	26'	355	199	200	225	40	66
Islander BC	6,499	67' x 97'	26'	689	385	390	436	N/A	N/A
Islander BCGH*	14,162	146' x 97'	26'	1,496	836	840	947	N/A	N/A
Islander BG*	7,300	146' x 50'	26'	771	431	430	488	N/A	N/A

Length = North to South. Width = East to West.

Classroom seating based on three people per 6' table. Capacities are subject to change based on allowances for head tables, staging, audiovisual and catering requirements. *Some room combinations may limit access to other rooms.

NORTH CONVENTION CENTER

	Square Feet	Dimensions (LxW)	Ceiling Height	Theatre	Classroom	Rounds of 10	Reception	Conference	Hollow Square
Islander BCDEGHI*	24,236	146' x 166'	26'	2,571	1,437	1,470	1,629	N/A	N/A
Islander C	3,149	67' x 47'	26'	330	185	190	209	40	66
Islander CDEHI*	16,936	146' x 116'	26'	1,789	1,000	1,000	1,133	N/A	N/A
Islander CH*	6,862	146' x 47'	26'	717	401	400	454	N/A	N/A
Islander D	2,400	48' x 50'	26'	247	138	138	157	28	48
Islander DE	4,950	99' x 50'	26'	520	290	290	329	N/A	N/A
Islander DEI	7,300	146' x 50'	26'	771	431	430	488	N/A	N/A
Islander E	2,550	51' x 50'	26'	266	149	150	168	34	48
Islander EI	4,850	97' x 50'	26'	517	289	290	327	N/A	N/A
Islander F	3,350	67' x 50'	26'	353	197	200	223	40	66
Islander FG	6,700	67' x 100'	26'	716	400	400	453	N/A	N/A
Islander FGH	9,849	67' x 147'	26'	1,050	587	590	665	N/A	N/A
Islander G	3,350	67' x 50'	26'	353	197	200	223	40	66
Islander GH	6,499	67' x 97'	26'	684	382	380	433	N/A	N/A
Islander H	3,149	67' x 47'	26'	330	185	180	209	40	66
Islander I	2,350	47' x 50'	26'	249	139	140	157	28	48
Islander Registration (Office)	204	12' x 17'	12'	N/A	N/A	N/A	N/A	N/A	N/A
Islander Registration (Desk)	200	8' x 25'	N/A	N/A	N/A	N/A	N/A	N/A	N/A

	Square Feet	Dimensions (LxW)	Ceiling Height	Theatre	Classroom	Rounds of 10	Reception	Conference	Hollow Square
Mariners	3,068	59' x 52'	14'	329	184	180	208	40	60
Mariners A	1,612	31' x 52'	14'	170	95	100	108	34	44
Mariners B	1,456	28' x 52'	14'	156	87	90	99	34	44
Tradewinds	6,844	58' x 118'	14'	741	414	410	469	N/A	N/A
Tradewinds A	952	28' x 34'	14'	101	56	60	64	28	36
Tradewinds AB	1,904	56' x 34'	14'	203	114	110	129	34	48
Tradewinds ABC	3,248	56' x 58'	14'	352	196	200	221	40	65
Tradewinds ABCD	4,928	56' x 88'	14'	523	292	290	335	N/A	N/A
Tradewinds B	952	28' x 34'	14'	101	56	60	64	28	36
Tradewinds C	1,416	59' x 24'	14'	147	82	80	93	40	48
Tradewinds CD	3,186	59' x 54'	14'	335	187	190	212	N/A	N/A
Tradewinds CDEF	4,897	59' x 83'	14'	521	291	290	330	N/A	N/A
Tradewinds D	1,770	59' x 30'	14'	185	103	100	117	40	56
Tradewinds DEF	3,481	59' x 59'	14'	374	209	210	237	N/A	N/A
Tradewinds E	812	28' x 29'	14'	88	49	50	56	20	24
Tradewinds EF	1,711	59' x 29'	14'	185	103	100	117	N/A	N/A
Tradewinds F	899	31' x 29'	14'	95	53	50	60	20	24
Tropics	1,908	36' x 53'	14'	203	114	110	129	34	48
Tropics A	864	36' x 24'	14'	94	52	50	59	24	24
Tropics B	1,008	36' x 28'	14'	109	60	60	69	24	24
Coral	2,160	36' x 60'	14'	233	130	130	147	34	48
Coral A	720	36' x 20'	14'	79	44	40	50	22	24
Coral AB	1,476	36' x 41'	14'	155	87	90	98	N/A	N/A
Coral B	756	36' x 21'	14'	79	44	40	50	22	24
Coral BC	1,440	36' x 40'	14'	152	85	90	96	N/A	N/A
Coral C	684	36' x 19'	14'	72	40	40	46	22	24
Shell Seekers	1,368	36' x 38'	14'	145	81	80	92	28	36
Shell Seekers A	684	36' x 19'	14'	72	40	40	45	22	24
Shell Seekers B	684	36' x 19'	14'	72	40	40	45	22	24

	Square Feet	Dimensions (LxW)	Ceiling Height	Theatre	Classroom	Rounds of 10	Reception	Conference	Hollow Square
Captain's Boardroom	756	36' x 21'	16'	N/A	N/A	N/A	N/A	12	N/A
Magellan Boardroom	884	26' x 34'	12'	N/A	N/A	N/A	N/A	16	N/A

Length = North to South. Width = East to West.

Classroom seating based on three people per 6' table. Capacities are subject to change based on allowances for head tables, staging, audiovisual and catering requirements.



MICHELOB ULTRA ARENA



MANDALAY BAY | MGM RESORTS
YOU HAVE TO BE HERE

MICHELOB ULTRA ARENA

	Square Feet	Dimensions (LxW)	Ceiling Height	Theatre	Classroom	Rounds of 10	Reception	Conference	Hollow Square
Michelob Ultra Arena	30,218	246' x 131'	55'	12,000	1,456	1,980	2,747	N/A	N/A
Broadway	975	28' x 35'	12'	103	57	60	87	22	30
Country	760	28' x 28'	12'	80	45	50	69	16	24
Jazz	740	21' x 31'	12'	78	44	50	67	22	24
R & B	760	28' x 28'	12'	80	45	50	69	16	24
Rock n' Roll	1,030	21' x 41'	12'	108	61	60	94	28	30
Swing	975	28' x 35'	12'	103	57	60	89	22	30
Events Center Club Room A	1,142	29' x 39'	14'	120	67	70	129	28	36
Events Center Club Room B	1,431	36' x 40'	14'	151	84	80	128	28	36
Events Center Club Room C	2,929	42' x 70'	14'	308	172	170	262	46	54
Events Center Club Room D	1,431	36' x 40'	14'	151	84	80	128	28	36
Events Center Club Room E	1,142	29' x 39'	14'	120	67	70	129	28	36

Length = North to South. Width = East to West.

Classroom seating based on three people per 6' table. Capacities are subject to change based on allowances for head tables, staging, audiovisual and catering requirements.

HERE, MEETINGS ARE CURATED AND CAPTIVATING

With many options to create a unique ambiance that best suits your group, W Las Vegas is the ideal setting for guests who appreciate high-end design and ultra-personalized service.

Combining the utmost in luxury with an unexpected touch of individuality, our resort includes the relaxed Sage Room, 31 sophisticated meeting rooms, or our 64th floor restaurant and lounge with spectacular Strip views and an open-air patio. The details make all the difference.

W LAS VEGAS |  MGM RESORTS

YOU HAVE TO BE HERE



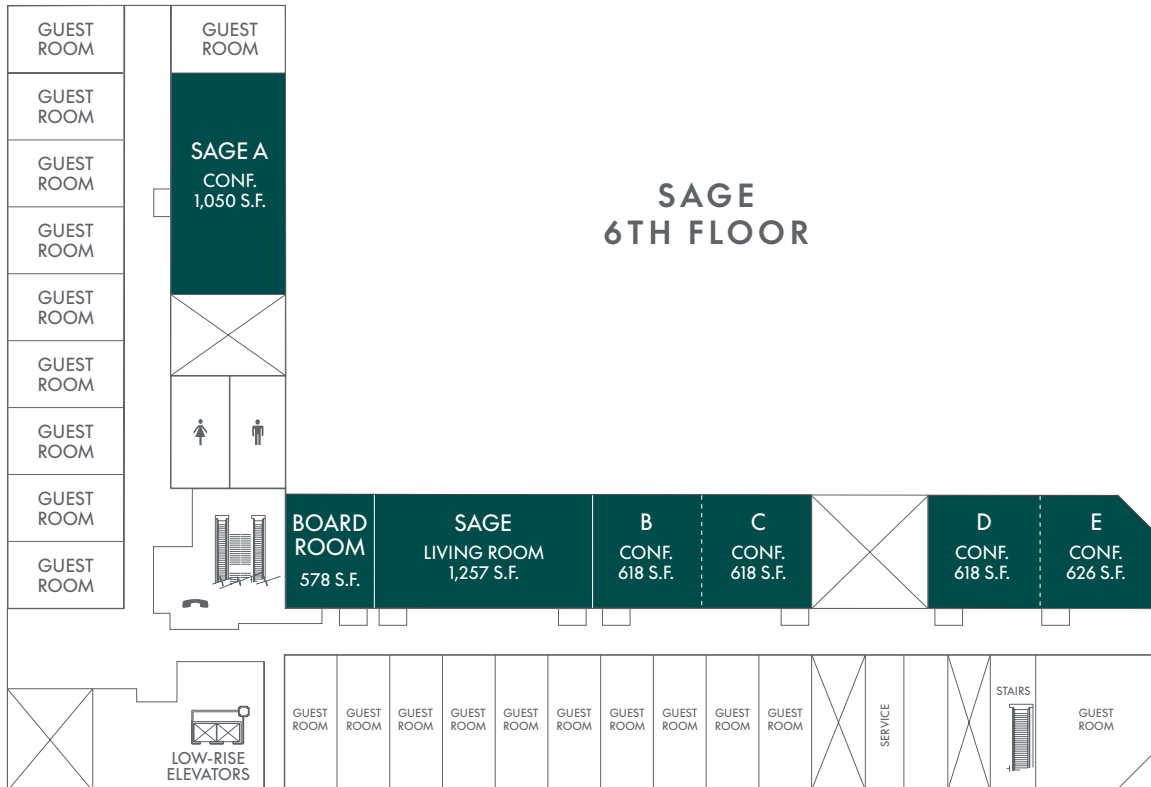
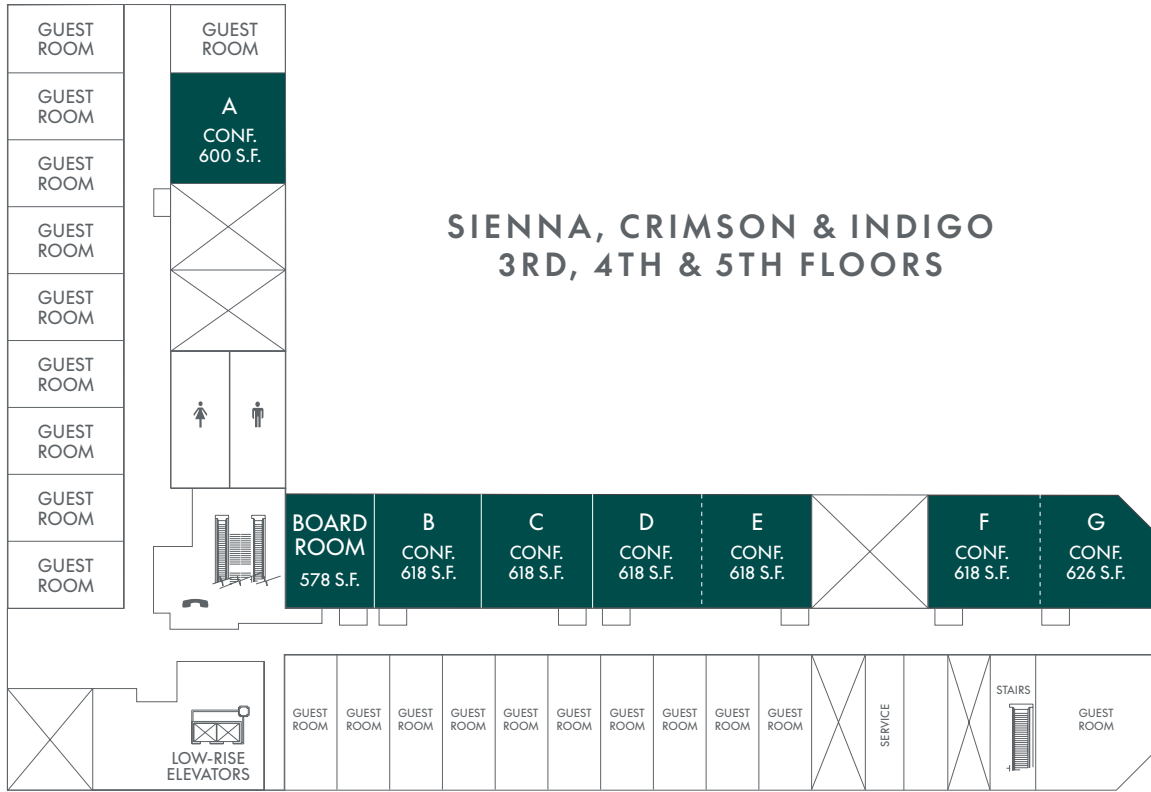

W LAS VEGAS FACILITIES

	S. F.	Dimensions (L/W)	Ceiling Height	Theater	Classroom 2x6	Classroom 3x6	Rounds of 8	Reception	Conference	U-Shape	Hollow Square
Sienna - 3rd Floor											
Sienna Boardroom	578	25'x23'	7'10"	N/A	N/A	N/A	N/A	N/A	12	N/A	N/A
Sienna A	600	25'x24'	7'10"	56	16	24	32	40	16	14	16
Sienna B	618	25'x25'	7'10"	56	16	24	32	41	16	14	16
Sienna BC	1,236	25'x50'	7'10"	130	38	57	64	82	28	26	28
Sienna C	618	25'x25'	7'10"	56	16	24	32	41	16	14	16
Sienna D	618	25'x25'	7'10"	56	16	24	32	41	16	14	16
Sienna DE	1,236	25'x49'	7'10"	130	38	57	64	80	28	26	28
Sienna E	618	25'x25'	7'10"	56	16	24	32	41	16	14	16
Sienna F	618	25'x25'	7'10"	56	16	24	32	41	16	14	16
Sienna FG	1,244	25'x51'	7'10"	130	38	57	64	82	28	26	28
Sienna G	626	25'x27'	7'10"	56	16	24	32	41	16	14	16
Crimson - 4th Floor											
Crimson Boardroom	578	25'x23'	7'10"	N/A	N/A	N/A	N/A	N/A	12	N/A	N/A
Crimson A	600	25'x24'	7'10"	56	16	24	32	40	16	14	16
Crimson B	618	25'x25'	7'10"	56	16	24	32	41	16	14	16
Crimson BC	1,236	25'x50'	7'10"	130	38	57	64	82	28	26	28
Crimson C	618	25'x25'	7'10"	56	16	24	32	41	16	14	16
Crimson D	618	25'x25'	7'10"	56	16	24	32	41	16	14	16
Crimson DE	1,236	25'x49'	7'10"	130	38	57	64	80	28	26	28
Crimson E	618	25'x25'	7'10"	56	16	24	32	41	16	14	16
Crimson F	618	25'x25'	7'10"	56	16	24	32	41	16	14	16
Crimson FG	1,244	25'x51'	7'10"	130	38	57	64	82	28	26	28
Crimson G	626	25'x27'	7'10"	56	16	24	32	41	16	14	16
Indigo - 5th Floor											
Indigo Boardroom	578	25'x23'	7'10"	N/A	N/A	N/A	N/A	N/A	12	N/A	N/A
Indigo A	600	25'x24'	7'10"	56	16	24	32	40	16	14	16
Indigo B	618	25'x25'	7'10"	56	16	24	32	41	16	14	16
Indigo BC	1,236	25'x50'	7'10"	130	38	57	64	82	28	26	28
Indigo C	618	25'x25'	7'10"	56	16	24	32	41	16	14	16
Indigo D	618	25'x25'	7'10"	56	16	24	32	41	16	14	16
Indigo DE	1,236	25'x49'	7'10"	130	38	57	64	80	28	26	28
Indigo E	618	25'x25'	7'10"	56	16	24	32	41	16	14	16
Indigo F	618	25'x25'	7'10"	56	16	24	32	41	16	14	16
Indigo FG	1,244	25'x51'	7'10"	130	38	57	64	82	28	26	28
Indigo G	626	25'x27'	7'10"	56	16	24	32	41	16	14	16
Sage - 6th Floor											
Sage Boardroom	578	25'x23'	7'10"	N/A	N/A	N/A	N/A	N/A	12	N/A	N/A
Sage A	1,050	25'x42'	7'10"	102	34	51	48	70	24	22	24
Sage Living Room	1,257	25'x50'	7'10"	130	38	57	64	82	28	26	28
Sage B	618	25'x25'	7'10"	56	16	24	32	41	16	14	16
Sage BC	1,236	25'x49'	7'10"	130	38	57	64	80	28	26	28
Sage C	618	25'x25'	7'10"	56	16	24	32	41	16	14	16
Sage D	618	25'x25'	7'10"	56	16	24	32	41	16	14	16
Sage DE	1,244	25'x51'	7'10"	130	38	57	64	82	28	26	28
Sage E	626	25'x27'	7'10"	56	16	24	32	41	16	14	16

W LAS VEGAS MEETING ROOMS



BEYOND THE CONVENTIONAL





YOU HAVE TO BE HERE