

[Skip to content](#)

Manuals+

User Manuals Simplified.



Bestway SPLASH FRAME POOLS User Manual

Home » [Bestway](#) » Bestway SPLASH FRAME POOLS User Manual 

Bestway

www.bestwaycorp.com

Visit Bestway YouTube channel 



<http://www.bestwaycorp.com>



WARNING

smooth out the bottom

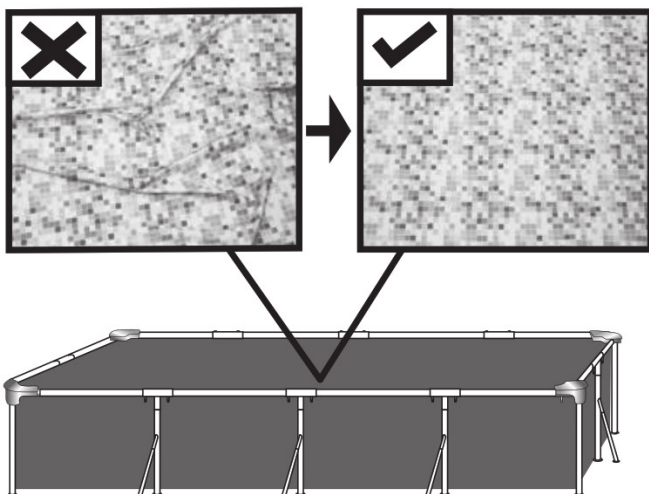

Put 1" to 2" water in the pool to cover the floor. Once the pool floor is slightly covered, gently smooth out all wrinkles. Start in the center of the pool and work your way clockwise to the outside.



www.bestwaycorp.com

SPLASH FRAME POOLS OWNER'S MANUAL

Product Description

Item No.	Dimension	Kit Type	Accessories
#56401	2.21 m x 1.50 m x 43 cm (87" x 59" x 17" /	swimming Aboveground swimming pool kit	/
#56402	2.39 m x 1.50 m x 58 an (94" x 59" x 231	Aboveground swimming pod kit	/
#56403	2.59m x 1.70 m x 61 an (102" x 67" x 24')	Aboveground swimming pod kit	/
#56404	3.00 m x 2.01 m x 66 an (118" x 7r x 2r)	Aboveground swimming pod kit	/
#56405	4.00 m x 2.11 m x 81 an (15T x83"x 32')	Aboveground swimming pool kit	/
#56411	3.00 m x 2.01 m x 66 an	Aboveground swimming pod kit	Filtration System
#56412	(118" x 79- x 26')		
#56424	4.00m x2.11 mx 81 cm	Aboveground swimming pool kit	Filtration System
k...			

WARNING

Carefully read, understand, and follow all information in this user manual before installing and using the swimming pool. These warnings, instructions, and safety guidelines address some common risks of water recreation, but they cannot cover all risks and dangers in all cases. Always use caution, common sense, and good judgment when enjoying any water activity. Retain this information for future use.

Non Swimmers safety

- Continuous, active, and vigilant supervision of weak swimmers and non-swimmers by a competent adult is required at all times (remembering that children under five are at the highest risk of drowning).
- Designate a competent adult to supervise the pool each time it is being used.
- Weak swimmers or non-swimmers should wear personal protection equipment when using the pool.
- When the pool is not in use, or unsupervised, remove all toys from the swimming pool and its surroundings to avoid attracting children to the pool.

Safety devices

- In order to prevent children from drowning, it is recommended to secure access to the pool with a protection device. In order to prevent children from climbing from the inlet and outlet valve, it is recommended to install a barrier (and secure all doors and windows, where applicable) to prevent unauthorized access to the swimming pool.
- Barriers, pool covers, pool alarms, or similar safety devices are helpful aids, but they are not substitutes for continuous and competent adult supervision.

Safety equipment

- It is recommended to keep rescue equipment (e.g. a ring buoy) by the pool.
- Keep a working phone and a list of emergency phone numbers near the pool.

Safe use of the pool

- Encourage all users especially children to learn how to swim
- Learn Basic Life Support (Cardiopulmonary Resuscitation – CPR) and refresh this knowledge regularly. This can make a life-saving difference in the event of an emergency.
- Instruct all pool users, including children, what to do in case of an emergency.
- Never dive into any shallow body of water. This can lead to serious injury or death.
- Do not use the swimming pool when using alcohol or medication that may impair your ability to safely use the pool.
- When pool covers are used, remove them completely from the water surface before entering the pool.
- Protect pool occupants from water-related illnesses by keeping the pool water treated and practicing good hygiene. Consult the water treatment guidelines in the user's manual.
- Store chemicals (e.g. water treatment, cleaning or disinfection products) out of the reach of children.
- Use the signage as outlined below. Signage is to be displayed in a prominent position within 2m of the pool.



Keep children under supervision in the aquatic environment. No diving.

- Removable ladders shall be placed on a horizontal surface.
- Irrespective of materials used for swimming pool construction, accessible surfaces have to be checked regularly to avoid injuries.
- Regularly monitor bolts and screws. Remove splinters or any sharp edges to avoid injuries.

ATTENTION: Do not leave the drained pool outside. The empty pool is liable to become deformed and/or displaced due to wind.

- If you have a filter pump, refer to the pump's manual for instructions.

WARNING! The pump cannot be used while people are inside the pool!

- If you have a ladder, refer to the ladder's manual for instructions.

WARNING! The use of a swimming pool implies compliance with the safety instructions described in the operating and maintenance guide. In order to prevent drowning or other serious injuries, pay particular attention to the possibility of unexpected access to the swimming pool by children under 5 years by securing access to it, and, during the bathing period, keep them under constant adult supervision.

Please read carefully and keep for future reference

Thank you for buying a Bestway pool. In order to ensure that you gain maximum enjoyment and safe use of your pool please follow the installation instructions along with the important safety guidelines in your owner's manual.





Installation usually takes approximately 10 minutes with 2-3 people excluding earthworks and filling. (For 2.21 m x 1.50 m x 43 cm / 87" x 59" x 17", 2.39 m x 1.50 m x 58 cm / 94" x 59" x 23" pools) Installation usually takes approximately 20 minutes with 2-3 people excluding earthworks and filling. (For 2.59 m x 1.70 m x 61 cm / 102" x 67" x 24",

3.00 m x 2.01 m x 66 cm / 118" x 79" x 26", 4.00 m x 2.11 m x 81 cm / 157" x 83" x 32" pools)

See below for part descriptions.

Components list:

NOTE: Some parts already have been installed on the pool.

<p>#01</p>  <p>X1</p>	<p>#02</p>  <p>X4</p>	<p>#03</p>  <p>X1</p>	<p>#04</p>  <p>X1</p>	<p>#05</p>  <p>X2</p>
<p>Liner</p>	<p>Underwater Adhesive Repair Patch #F1B417</p>	<p>Hose Adaptor #P6D1419</p>	<p>Drain Valve Cap #P6D1158</p>	<p>Stopper #P6D1418</p>

The below parts are for a steel frame.

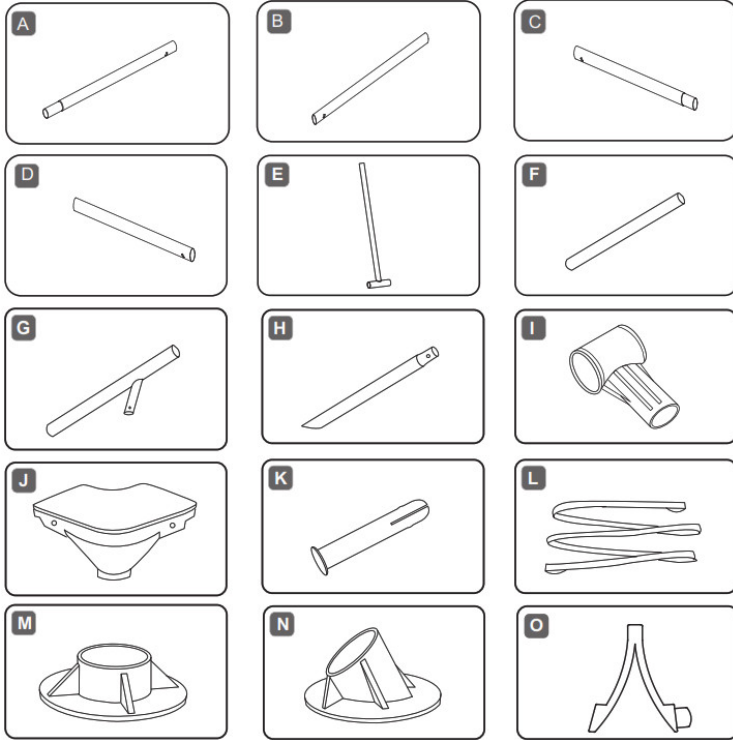

Please see faqs for additional information. Drawings not scaled to size.

(NO.)	Name	sr x 59" a 17-		94- x 59" a 23-		102" x 67- x 24'	
		Qty	Spare Part No.	Qty	Spare Part No.	Qty	Spare Part No.
1	Liner	1	56401ASS17	1	59402ASS17	1	56403ASS17
A	Top Rail A	1	P61050	2	P61055	4	P61060
ril	Top Rail B	2	P61052	2	P61057	2	P61062
C	Top Rail C	2	P61053	2	P61058	2	P61063
D	Top Rail 0	2	P61054	2	P61054	2	P61064
E	T-Support	1	I	4	P61059	6	P61065
F	Vertical Pool Leg	8	P61051	4	P61056	4	P61061
	1-Plastic Connector	4	P61015	4	P61015	6	P61015
J	Corner Seat	4	P61016	4	P61016	4	P61016
K	Connection Pin	8	P61020	8	P61020	8	P61020
PA	Footing	8	P61026	4	P61026	4	P61026

118' x 711" a 261

1571 x 83" x 321

		Qty	Spare Part No.	Qty	Spare Part No.
1	LOW	1	56404ASS17	1	56405ASS17
A	Top Rail A	4	P61067	6	P61071
8	Top Rai B	2	P61068	2	P61072
C	Top Rail C	2	P61069	2	P61073
D	Top Rail D	2	P61070	2	P61075
F	Intel Pod Leg	4	P61421	4	P61074
G	1-vertical pool leg	6	P61066	8	P61076
H	Side Support Leg	6	P61018	8	P61019
	1-Plastic Connect	6	P61015	8	P61021
J	Cornet Seat	4	P61016	4	P61022
K	Connecta, Pin	8	P61020	8	P61020
L.	Bottom long Belt	3	P6895	4	P6896
M	Footing	10	P61026	12	P61010
N	Side Support Leg Footing	6	P61017	8	P61017
0	025 Side Support spiro-loaded Po	6	P61576	8	P61576

Structure:

Before assembling your pool, please take a few minutes to check all the parts and become familiar with their position.

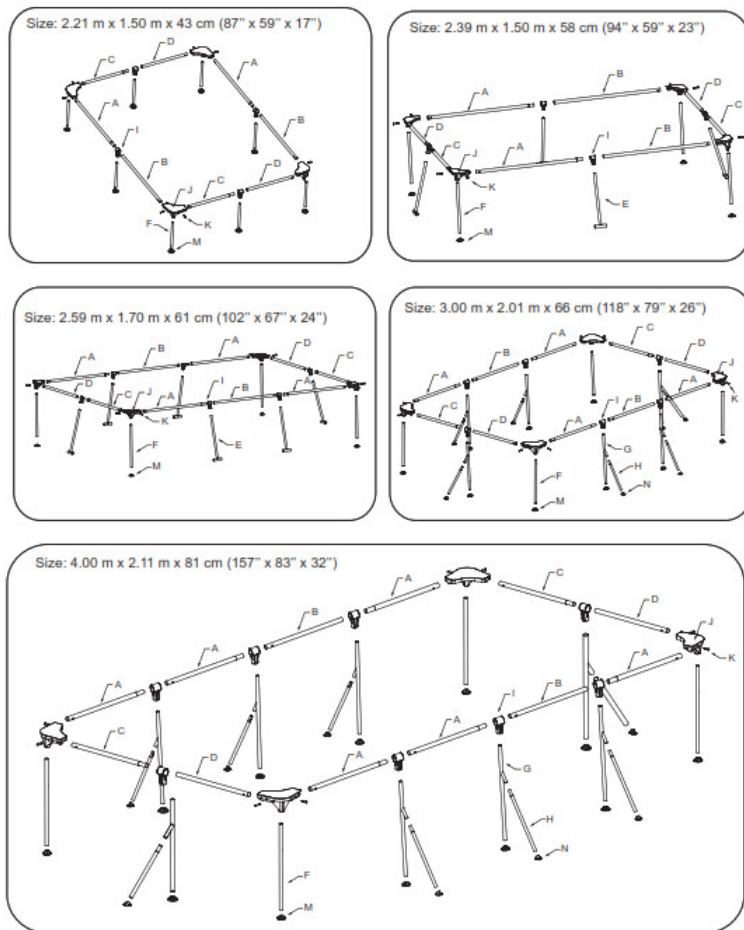

Contents [[hide](#)]

- [1 CHOOSE THE CORRECT LOCATION](#)
- [2 FILLING POOL WITH WATER](#)
- [3 POOL MAINTENANCE](#)
- [4 Frequently Asked Questions \(FAQ\)](#)
- [5 Limited BESTWAY® Manufacturer's Warranty](#)
- [6 File Downloads](#)
- [7 References](#)
- [8 Related Manuals](#)

CHOOSE THE CORRECT LOCATION

IMPORTANT: The pool must be set up on a completely flat and level surface. Please do not install the pool if the surface is inclined or sloped.
Correct conditions to set up the pool:

- The selected location has to be capable of uniformly supporting the weight for the entire time the pool is installed, moreover, the location must be flat and must be cleared of all objects and debris including stones and twigs.
 - We recommend positioning the pool away from any objects kids could use to climb into the pool. NOTE: Position the pool near an adequate drainage system to deal with overflow or to discharge the pool.
- Incorrect conditions to set up the pool:
- On the uneven ground the pool may collapse causing serious personal injury and/or damage to personal property and will void the warranty and prevent any service claims.
 - Sand should not be used to create a level base; the ground must be dug out if necessary.
 - Directly under overhead power lines or trees. Be sure the location does not contain underground utility pipes, lines or cables of any kind.
 - Do not set up the pool on driveways, decks, platforms, gravel or asphalt surfaces. The selected location should be firm enough to withstand the pressure of the water; mud, sand, soft/loose soil or tar are not suitable.
 - Grass or other vegetation under the pool will die and may cause odors and slime to develop, therefore we recommend removing all grass from the selected pool location.
 - Avoid areas prone to aggressive plant and weed species that may grow through the ground cloth or liner.

NOTE: Check with your local city council for by-laws relating to fencing, barriers, lighting and safety requirements and ensure you comply with all laws.

NOTE: If have a filter pump, refer to the pump's manual for instructions.

NOTE: The ladder must match the pool size and should to be used only for entering and exiting the pool. It is forbidden to exceed the permitted payload of the ladder. Check regularly if the ladder is properly assembled.

Installation

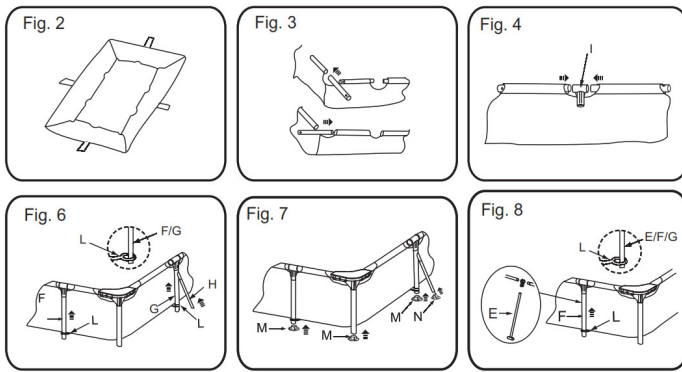

Assembly of the Frame pool can be completed without tools.

NOTE: It is important to assemble the pool in the order shown below. Install your pools according to the above illustrations.

- Layout all parts and check that you have the correct quantities as listed in the parts guide. If you are missing any part do not assemble the pool, contact our Customer Service Department for assistance.
NOTE: Vertical pool legs are packaged inside the top rails.
- If the pool was purchased with a ground cloth, spread carefully at the desired location. This pool may have been purchased with a Bestway Filter Pump, if a pump is to be used (recommended and also available separately) the pool should be located within a distance of a power outlet.
- Place the Leg Bands (L) on the ground (See Fig. 1). There are different lengths of Leg bands (L), please ensure you have used the correct sizes at the correct locations.
- Spread out the pool and put it on the Leg Bands (L). Make sure it is right side up (See Fig. 2).
Let it sit exposed to direct sunlight for 1 hour or more so the pool is more flexible during setup.
- Turn the pool so the drain valve is near the area where your plan to drain the water and pump valves are facing the outlet for the optional filter pump.
ATTENTION: Do not drag the pool on the ground in order to avoid damaging the linear on sharp objects. Bestway Inflatables will not be responsible for damage caused to the pool due to mishandling or failure to follow these instructions.
- Insert all of the top rails into the pole sleeves on the top of the pool (See Fig. 3). The combinations for top rails are different for different sizes pools, see the Structure Section for detail.
- At the middle opening of each sleeve, insert the two ends of the top rails into the Connector (I). (See Fig. 4)
NOTE: At each Connector ensure both top rails are properly inserted.
- At the corners, insert the top rails into the Corner Seats (J). Insert the Connection Pins (K) into the pre-drilled holes locking the top rails into position. (See Fig. 5)
- Insert the Vertical Pool Legs (F) into the bottom of the Corner Seats (J). (See Fig. 5)
- On the sides of the rectangle, insert the T Support (E), Vertical Pool Legs (F) or the Y-Vertical Pool Legs (G,H) into the vertical holes of the Connectors (I). (See Fig. 6, See Fig. 8)
- Connect the Side Support Legs (H) to the Y-Vertical Pool Legs (G). Ensure the spring-loaded pins lock into the pre-drilled holes. (See Fig. 6)
- On each corresponding Pool Leg located on the sides of the rectangle, put the Pool Legs (E, F or G) through the loops of the Leg Bands (L). This will keep both corresponding pool legs locked in position. (See Fig. 6, See Fig. 8)
- Attach all Footings (M&N) to the bottom of the Vertical Pool Legs (F) and the Side Support Legs (H). (See Fig. 7)
- Test the Frame to ensure all connections are secure before filling with water.
- Insert the blue stopper plug into the inlet and outlet on the inside wall of the pool.
- Ensure the drain valve is firmly closed.
- Put 1" to 2" water in the pool to cover the floor. Once the pool floor is slightly covered, gently smooth out all wrinkles. Start in the center of the pool and work your way clockwise to the outside.

FILLING POOL WITH WATER

ATTENTION: Do not leave pool unattended while filling with water

- Fill pool to drain valve.
STOP
- Turn the water off. Check that the water is not collecting on any side to ensure the pool is level. If pool is not level, drain water and re-level ground by digging out (See Fig. 10). Never attempt to move the pool with water in it, serious personal injury or damage to the pool may result.
NOTE: Your pool may contain a great deal of pressure. If your pool has any bulge or uneven side then the pool is not level, the sides may burst and the water may discharge suddenly causing serious personal injury and/or damage to property.
- If level, fill pool to lowest pump valve.
STOP
- Turn the water off. Check valves for a secure fit.
- Fill pool until water capacity is 90% (See Fig. 9), **DO NOT OVERFILL** as this could cause the pool to collapse. In times of heavy rainfall, you may need to empty some of the water to ensure the level is correct.
- Check pool for any leaks at valves or seams, check ground cloth for any evident water loss. Do not add chemicals until this has been done.

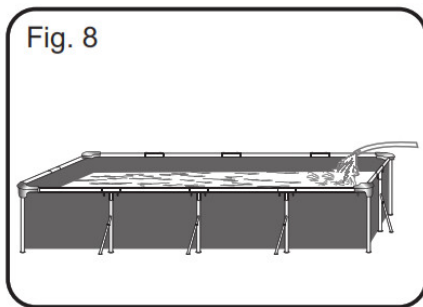

- In the event of a leak, patch your pool using the underwater adhesive repair patch provided. Refer to the FAQ's for further information.

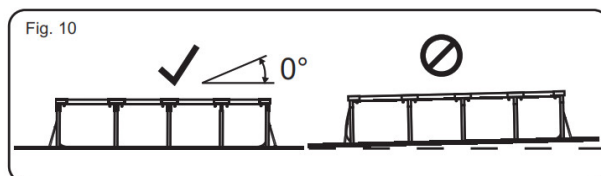
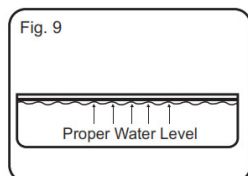

NOTE: Drawings for illustration purposes only. It May not reflect the actual product. Not to scale.

ATTENTION: Do not use a pump when pool is in use. During the season of use of the swimming pool, the filtration system must be necessarily put into service every day, enough for a long time to assure at least a complete renewal of the volume of water.

POOL MAINTENANCE

Warning: If you do not adhere to the maintenance guidelines covered herein, your health might be at risk, especially that of children. Pool water treatment is essential for the safety of the users. Using chemicals inappropriately will cause property damage and personal injury.

NOTE: The pump is used to circulate the water and to filter small particles. In order to keep your pool water clean and hygienic, you must also add chemicals.

1. It is recommended not to fill the pool with catchment water, drilling water, or drainage well water: these waters generally contain polluted organic substances including nitrates and phosphates. Filling pools with water from the public network is advised.
2. Always keep your pool clean and apply the correct pool chemicals. Unsanitary water is a serious health hazard. It is recommended to use disinfectant, flocculant, acid or alkali chemicals to treat your pool.
3. Clean the PVC liner regularly with non-abrasive brushes or a pool vacuum cleaner.
4. Throughout the season, the water filtration system must run long enough each day to clean the entire volume of water in the pool.
5. Check the filter cartridge (or sand in a sand filter) regularly and replace dirty cartridges (or sand).
6. Regularly check the screws, bolts and all the metal parts for rust. Replace if necessary.
7. If it rains, check that the water level is not higher than the specified level. If water exceeds the specified levels, drain the pool to the specified level.
8. Do not use the pump when the pool is in use.
9. Cover the pool when not in use.
10. For pool water treatment, the pH value is very important.

ATTENTION: Do not leave the drained pool outside. The following parameters ensure good quality water

Parameters	Values
Water clarity	a clear view of the pool bottom
Colour of the water	no color should be observed
Turbidity in FNU/NTU	max. 1.5 (preferably less than 0.5)
Nitrate concentration above that of fill water in mg/l	max. 20
Total organic carbon (TOC) in mg/l	max. 4.0
Redox potential against Ag/AgCl 3.5 m KCl in mV	min. 650
pH value	6.8 to 7.6
Free active chlorine (without cyanuric acid) in mg/l	0.3 to 1.5
Free chlorine used in combination with cyanuric acid in mg/l	1.0 to 3.0
Cyanuric acid in mg/l	max 100
Combined chlorine in mg/l	max 0.5 (preferably close to 0.0 mg/l)

Repair

Check pool for any leaks from valves or seams, check the ground cloth for any evident water loss.

Do not add chemicals until this has been done.

NOTE: In the event of a leak, patch your pool using the underwater adhesive repair patch provided.

Refer to the FAQ's for further information.

Dismantling

1. Unscrew the drain valve cap on the outside of the pool counterclockwise and remove it.
2. Connect the adaptor to the hose and put the other end of the hose in the area where you are going to drain your pool. (Check local regulations for drainage by-laws).
3. Screw the control ring of the hose adaptor onto the drain valve clockwise. The drain valve will be open and water will start to drain automatically. **ATTENTION:** Water flow can be controlled with the control ring.
4. When draining is finished, unscrew the control ring to close the valve.
5. Disconnect the hose.
6. Screw the cap back onto the drain valve.
7. Air dry pool.

ATTENTION: Do not leave the drained pool outside.

Storage and Winterization

1. Please remove all the accessories and spare parts of the pool and store them clean and dry.
2. Once the pool is completely dry, sprinkle with talcum powder to prevent the pool from sticking together, fold the pool carefully. If the pool is not completely dry, mold may result and will damage the pool liner.
3. Store liner and accessories in a dry place with a moderate temperature between 5°C / 41°F and 38°C / 100°F.
4. During the rainy season, pools and accessories should be stored as per the above instructions also.
5. Improper draining of the pool might cause serious personal injury and/or damage to personal property.
6. We strongly recommend the pool is disassembled during the off-season (winter months). Store in a dry location out of children's reach.

Frequently Asked Questions (FAQ)

1. What is a suitable base for the Frame Set pool?

Almost any completely flat, solid, level surface can be used. Do not use sand as a leveling material as it is prone to shifting under the pool. The ground should be dug out until it is perfectly level. Do not set up on driveways, decks, platforms, gravel or asphalt. The ground should be firm enough to withstand the weight and pressure of the water: mud, sand, soft/loose soil or tar are not suitable. A concrete base can be used but care should be taken not to drag the pool across the surface as abrasions could tear the liner. If the pool is to be set up on a lawn, it is recommended that the grass is removed from where the pool will sit as it will die and may cause odors/slime. Certain types of hardy grass can grow through the liner as can aggressive bushes/plants by the side of the pool. Ensure adjacent vegetation is cut back where necessary. Use of a ground cloth assists in protecting the base of the pool.

2. How will I know if my pool is set up on the unlevelled ground?

If your pool appears to be bulging on one side it is not set up on the level ground. It is important that you empty your pool and move the pool to a level site. If the pool is not on level ground it will place undue stress on the seams and could result in the seams bursting which will cause flooding, property damage, and potential personal injury or death. Fill your pool following the instructions in the owner's manual carefully. This will ensure that you do not waste water and the pool can be moved easily so that the ground can be leveled at an appropriate time and not after you have completely filled it with water.

3. Can I have my pool filled by a water service?

We recommend using a garden hose under low pressure for filling your pool. If it is necessary to use a water delivery service, it is best to fill the pool with one inch of water by hose and smooth wrinkles first. Use a water service that is able to regulate the flow of water to prevent damage. Ensure you stop at each step as noted in the instruction manual to ensure your pool is level. Bestway will not be held responsible for pools damaged or weakened by water delivery services.

4. What is the maximum fill height of the pool?

Fill pool until water capacity is 90% up to the bottom of the top rail of the pool. Never attempt to fill your pool beyond the base of the rail. We recommend leaving extra room to account for water displacement when occupants are inside the pool. You may have to top up the water during the season which has been lost through evaporation or normal use.

5. My pool is leaking, what do I do to fix it?

The pool does not need to be emptied to fix any holes. Self-adhesive underwater repair patches can be purchased at your local pool/hardware store. For external use, use the repair patch provided. For internal holes, clean the hole on the inside of the pool to wipe off any oils and algae. Cut a circle large enough to cover the hole and apply the patch securely onto the side in the water. Cut a second patch and apply to the outside of the pool for extra strength. If the hole is in the base of the pool use one patch only and weigh it down with a heavy object while it bonds. If you have patched the pool when it is empty we recommend you leave it at least 12 hours before filling.

6. Where can I buy filter cartridges and how often should I change them?

Filter cartridges to fit your filter pump should be available from the store where you purchased your pool. If not, most mass retailers sell filter cartridges as an accessory. If you are unable to obtain replacements please call our toll-free number and we will assist you in finding a source local to you. The cartridges should be changed every 2 weeks dependent upon use of the pool. Check the filter on a weekly basis and clean by hosing down any debris and particles. Note: Ensure your pump is disconnected from the electrical supply before checking the filter cartridge. You can also visit our website www.bestwacorp.com for cartridge purchase.

7. How many times a year should I change the water?

This is dependant on the amount of use the pool receives, and the attention paid to covering the pool and keeping chemicals properly balanced. If maintained correctly the water should last a full summer season. Please contact your local pool chemical supplier for detailed information regarding chemicals, they will be able to advise you how to best maintain the cleanliness of your water.

8. Do I need to take my pool down for the winter?

Yes, Above-ground pools may collapse under the weight of ice and snow and the PVC walls will be damaged. We recommend taking the pool down when temperatures fall below 8°C / 45°F. The pool should be stored indoors in a moderate temperature between 5°C / 41°F and 38°C / 100°F. Please store away from chemicals and rodents and out of the reach of children.

9. My pool is fading – why is that?

Excessive use of chemicals can cause the color of the inside of the liner to fade; this is similar to a swimsuit fading over time from repeated contact with chlorinated water.

10. How many years will the pool last?

There is no set time limit for the pool to last; following the instructions in the owner's manual and with proper care, maintenance and storage you can considerably increase the life of your pool. Improper set-up, use or care can result in failure of the pool.

11. Do you recommend the use of a filter pump with a Bestway pool?

Absolutely! We strongly recommend you use a filter pump which will maintain the cleanliness of the water.

12. Which are the most important functions of my filter pump?

The most important function of a filter pump is the elimination of every sort of impurity from the water with the aid of a filter cartridge and chemical products for its sterilization.

13. I can not find the vertical pool legs—why?

The vertical pool legs are packaged inside the top rails.

Limited BESTWAY® Manufacturer's Warranty

The product you have purchased comes with a limited warranty. Bestway® stands behind our quality guarantee and assures, through a replacement warranty, your product will be free from manufacturer's defects.

The following provision is only valid within the European member state countries. The legal regulation of Directive 1999/44/EC will not be affected by this BESTWAY limited warranty.

To enact a warranty claim, this form must be completed and submitted with a copy of your receipt/purchase to your local Bestway After Sales Center. Before any claims can be accepted, the Bestway After Sales Center may ask you to send a piece of the defective part to the center (e.g. a cut out of the production batch number/drain valve). Please contact your local Bestway After Sales Center before sending any documents. They will provide full instructions of what is needed for your claim.

Bestway ® is not responsible for economic loss due to water or chemical costs. Bestway ® will not replace any products deemed to have been damaged due to negligence or having been used outside of the owner's manual guidelines.

Bestway's warranty covers manufacturing defects discovered while unpacking the product or during use, within the limits of use, and is respectful of warnings and instructions are given within the user's manual. This warranty applies only to products that have not been modified by any 3rd parties. The product must be stored and handled in accordance with the technical recommendations.

The Limited Warranty is valid for the period indicated above. The warranty start date is the date of sale shown on the original receipt/purchase invoice.

Please choose the type of your pool:

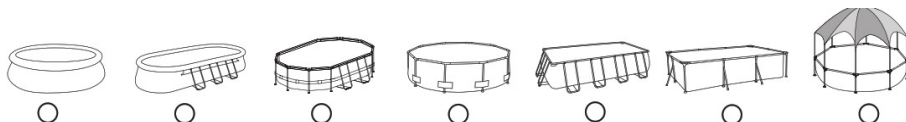

Date of purchase:.....

Customer Code Number:.....TO: Bestway Service Department Date:.....

FAX/E-MAIL/TEL: Please refer to your country according to the information found on the back cover or on our website: www.bestwaycorp.com.

Please provide your address details in full. Note: Incomplete address details will result in delayed shipments.

Bestway reserves the right to charge for re-delivery of undelivered packages where the recipient is at fault.

REQUIRED INFORMATION – PLEASE WRITE THE SHIPPING ADDRESS

Name:	Address:
Zip Code:	Retailer:
Country:	City:
Mobile:	Telephone:
Fax:	E-mail:
Please write the Batch Number and Item Code located near the drain valve	Item Code:
Batch Number:	

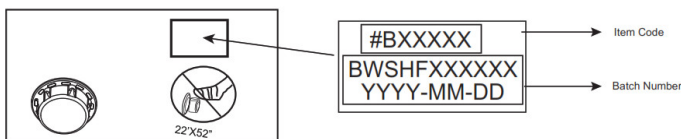

- Problem description
- Faulty welding
- Faulty upper ring
- Faulty drain valve
- Item is torn / Leaking
- Other (Please describe)
- Missing part (Please use the code for the missing part. This can be found in the owner's manual.)



IMPORTANT: ONLY THE DAMAGED PART WILL BE REPLACED, NOT THE COMPLETE SET.

Bestway reserves the right to request photographic evidence of defective parts or to require sending the item for additional testing. In order to best assist you, we request all information you provide to be complete.

FOR FAQ, MANUALS, VIDEOS OR SPARE PARTS, PLEASE VISIT OUR WEBSITE: www.bestwaycorp.com

VIDEOS ARE ALSO AVAILABLE ON OUR BESTWAY CHANNEL ON YOUTUBE: www.youtube.com/user/BestwayService

File Downloads



Bestway User Manual [Download](#) [optimized]
SPLASH FRAME POOLS [Download](#)

References

- [Bestway Global - YouTube](#)
- [Bestway](#)
- [Bestway Global - YouTube](#)
- [BESTWAY® Trademark](#)

Related Manuals

1. [Bestway Power Steel Oval Pools User Manual](#) Bestway Power Steel Oval Pools User Manual WARNING smooth out...
2. [Bestway Power Steel Rectangular Pools Owner's Manual](#) Bestway Power Steel Rectangular Pools Owner's Manual Visit Bestway YouTube...
3. [Bestway Splash-In-Shade Play Pool Owner's Manual](#) Bestway Splash-In-Shade Play Pool Owner's Manual Thank you for buying...
4. [Bestway Filter Pump \[58511E\] User Manual](#) #58511E FILTER PUMP OWNER'S MANUAL www.bestwaycorp.com/support Visit Bestway YouTube...
5. [Bestway SaluSpa Owner's Manual](#) Bestway® SaluSpa™ Owner's Manual Warning IMPORTANT SAFETY INSTRUCTIONS When using...
6. [Bestway Above Ground Swimming Pool User Manual \[POWER STEEL, STEEL PRO MAX\]](#) User Manual Bestway Above Ground Swimming Pool [POWER STEEL, STEEL...