

Mesa Heat Deflector

ASSEMBLY

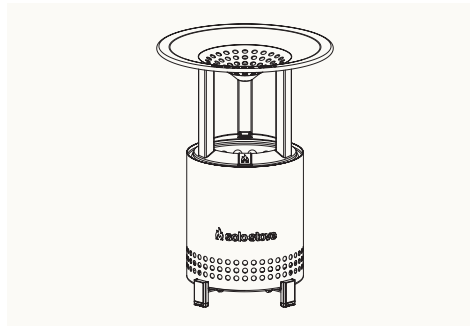
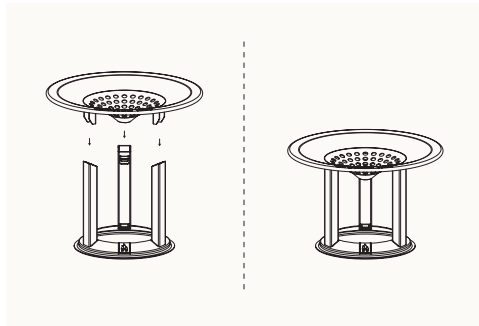
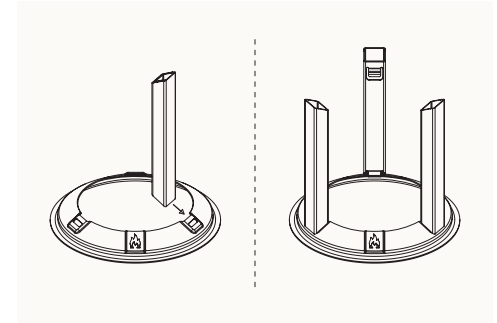
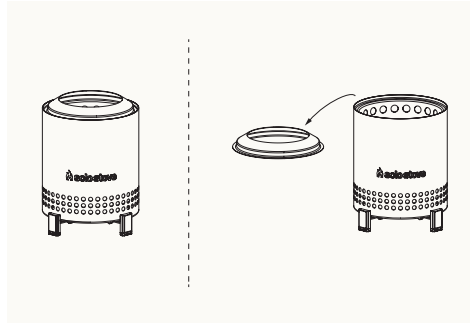
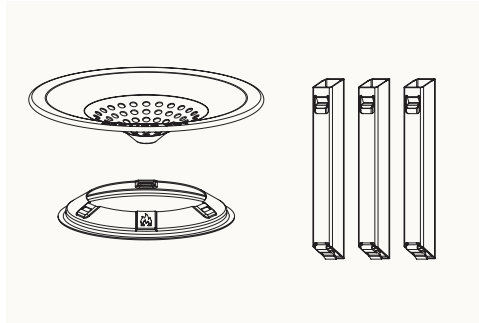

Do not use the heat deflector if the fire level is consistently near or above the level of the bottom of the cone of the deflector. High fires will reduce the effectiveness of the heat deflector.

1. START A FIRE

Light a fire using pellets or mini hardwood, according to the instructions included in the Mesa or Mesa XL packaging. Allow the fire to burn for 5-10 minutes.

2. PLACE HEAT DEFLECTOR

Gently place the heat deflector onto the Mesa using high-heat gloves. High-heat gloves should always be worn when working with and around the heat deflector. Ensure that the heat deflector base ring is firmly nested inside the outer lip of the Mesa.

3. WHILE IN USE

Heat will radiate noticeably for 2+ feet away from the fire pit. Logs can be added while the heat deflector is in place, or it can be removed to occasionally stoke and manage the fire. Do NOT place the hot heat deflector on any combustible surfaces.

SAFETY WARNINGS

Heat Deflector will be hot during use. Do not attempt to handle without high-heat gloves.

Do not attempt to pick up a hot heat deflector with sticks or fire pit tools.

Do not allow children or pets near Heat Deflector at any time when in use or while cooling.

Do not attempt to set heat deflector on a fire pit with flames above the bottom level of heat deflector.

Do not place any objects on heat deflector. Do not use the top of heat deflector as a heating or warming surface for objects.

Do not set a hot Heat Deflector on wet surfaces, such as grass. Do not use in rain or snow as it could result in property damage or injury.

4. CARE & MAINTENANCE

Soot buildup may occur on the bottom of the heat deflector. This is normal, and soot can be cleaned off with a damp cloth. Ensure the heat deflector is thoroughly cool and dry before storing.

As soon as your first use, heat deflector will show signs of patina, or discoloration. Stainless steel also has a color-changing quality under high heat, which will naturally occur with the heat deflector.

Heat deflector may experience some slight deformation as it heats and cools. This is normal and will not affect the performance of the heat deflector.

Allow to air cool when not in use. Do not rapidly cool the heat deflector (e.g. by pouring water onto the surface when hot).

Do not block the holes in the top of heat deflector, as this will reduce airflow and performance.

Do not use a damaged heat deflector. Property damage or injury could occur.

Do not use heat deflector in a manner other than specified. Property damage or severe injury could occur.

Store heat deflector in a clean, dry area when not in use.

Do not use the heat deflector in windy conditions.

Heat Deflector should only be used on a stable surface.