



SANS Autumn Sydney 2025

Sydney, NSW | 5–10 May

PROGRAM GUIDE

 +61 2 6174 4581

 anz@sans.org

 @SANSAPAC

GENERAL INFORMATION

We hope you enjoy this week of hands-on, immersive training, full of the important and immediately useful techniques that you can put to work as soon as you return to your office. Please read the following information carefully and contact us if there's anything more we can do to assist you during your course.
anz@sans.org | +61 2 6174 4581

Venue

Sydney Central Hotel

169–179 Thomas Street, Sydney, NSW 2000, Australia
Phone: (02) 9281 6888

Event Check-In | Badge & Courseware Distribution

LOCATION: Outside of Elizabeth Bay and Watson Bay

DATE/TIME: Monday, 5 May | 8:00–8:30 AM

You must check in on the first day of your course to pick up your name badge before going to class. An official photo ID is required for check in. Your name badge will be required for admission to your classroom and must be worn at all times during the event.

Break Times*

Morning Tea 10:30–10:50 AM

Lunch 12:15–1:30 PM

Afternoon Tea 3:00–3:20 PM

*Tea and coffee is available throughout the day in the breakout area outside your classroom.



COURSE SCHEDULE

Time: 9:00 AM–5:00 PM (Unless otherwise noted)
NOTE: class begin at 8:30 AM on Day 1 (Monday, 5 May)

FOR508 Advanced Incident Response, Threat Hunting & Digital Forensics™ (6-DAY COURSE)

INSTRUCTOR: Steve Anson

LOCATION: Elizabeth Bay (GROUND FLOOR)

HOTEL FLOOR PLAN

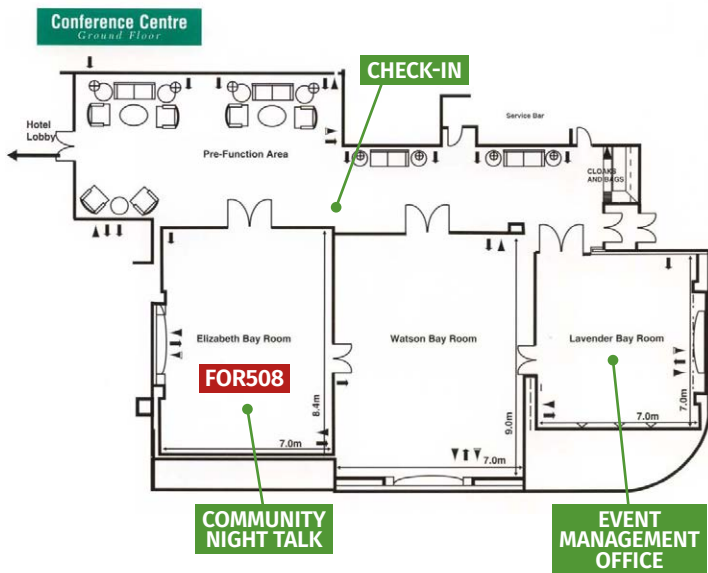

GENERAL INFORMATION

Ice Cream Day!

In SANS tradition, Friday afternoon tea will include ice cream to help celebrate a busy week!

GIAC Certification and OnDemand Bundle

Pre-purchased course bundles will be available approximately 10 days following the event, from Tuesday, 20 May.

*To receive access to your bundles, the course fees must be paid in full.

Laptop Requirements – Important!

All students should complete the following tasks prior to attending their course (at our training venue or online) on Day 1:

- Confirm your chosen attendance mode by logging into your SANS Account and selecting *My Orders* from your account dashboard. Browse to your order for Autumn Sydney 2025 and view your invoice/receipt.
- Check the payment status of your registration to ensure that payment has been made in full and contact anz@sans.org with any concerns.
- Download your electronic courseware including course books and any supplementary files such as .iso files. ***It is important that this is done in advance of your class, since download sizes are significant, and most students will not have time to complete downloads on the morning of your course.***
- Complete and check your laptop set-up using the requirements for your specific course (see below).
- All courses at Autumn Sydney 2025 require a laptop, the specification of which may differ dependent on the course taken. For specific requirements, please click the *Autumn Sydney 2025* event page, select your course, and browse to the *Laptop Requirements* section using the links below your course title.
- Given the nature of SANS classes, we recommend you do not use your regular production laptop for your class. In many courses, you will be installing new software and tools which can sometimes present risks to your system. In addition, in many hands-on labs, you may be connecting to a shared network with other attendees to attack specified targets. Although we state that students must NOT target other students' systems, and risk being ejected from the class if they do, SANS cannot be held responsible for your system if damage occurs due to unauthorised access during a workshop or lab exercise.

Photography Notice

SANS may take photos of classroom activities for marketing purposes. SANS Autumn Sydney 2025 attendees grant SANS all rights for such use without compensation, unless prohibited by law.

Feedback Forms and Course Evaluations

SANS is committed to offering the best information security training, and that means continuous course improvement. Your student feedback is a critical input to our course development and improvement efforts. Please take a moment to complete the electronic evaluation posted in your class Slack channel each day.

Your Identification Badge

To confirm you are in the right place, SANS Work-Study participants will be checking your badge for each course and event you enter. For your convenience, please wear your badge at all times.

Dietary Requirements

Please let us know in advance if you have special dietary requirements or food allergies by emailing us at anz@sans.org.

Safety and Comfort at the Event

You may wish to bring a jacket or jumper in case you need it in the climate-controlled classrooms. Some students may wish to bring a second monitor or other peripherals and though these are generally not necessary, provision has been made to allow for these BYO items in the classroom. A limited number of standing-height tables will be provided in each room for students who wish to alter their working position throughout the day.

Covid Safety

This event is setup with covid-safe precautions in place including the highest standards of cleanliness, appropriate social distancing, and the availability of hand sanitiser and masks.

Please advise a member of the SANS team if you have displayed any Covid symptoms or suspect you should not be in attendance for any reason. More information is at www.nsw.gov.au/health/covid-19

SPECIAL EVENTS

SANS Community Nights are a great way to stay in touch with your local InfoSec community and to hear the latest in technical wizardry, industry intelligence, and thought leadership from our amazing instructors.

SANS COMMUNITY NIGHT

Pass the What Now? Understanding Credential Attacks in a Windows 11 World

Register In-Person and Virtually

DATE: **Thursday, 8 May**

TIME: **5:30–6:00 PM:** Registration, drinks, and canapes
6:00–7:00 PM: Steve Anson's talk

LOCATION: **Elizabeth Bay** (GROUND FLOOR)

SPEAKER: **Steve Anson, SANS Principal Instructor**

Microsoft provides users with the convenience of single-sign-on (SSO) solutions. But the authorisation credentials upon which SSO relies have long been targeted by attackers. Pass-the-hash, pass-the-ticket, pass-the-token, and other attacks allow attackers to move freely about your network, even between your on-prem and cloud environments. Learn more about these attacks and the latest controls to mitigate their associated risk.



Scan QR code to register virtually



Extend Your Training

SANS ►
OnDemand

Add an OnDemand Bundle to your course.

Extend Your Training Experience with an OnDemand Bundle

- Four months of supplemental online review
- 24/7 online access to your course lectures, materials, quizzes, and labs
- Subject-matter-expert support to help you increase your retention of course material

OnDemand Bundle price: AUD \$1,495

sans.org/ondemand/bundles

Validate Your Training

GIAC
CERTIFICATIONS

Add a GIAC Certification attempt to your course.

Get Certified with GIAC Certifications

- Distinguish yourself as an information security leader
- 30+ GIAC cybersecurity certifications available
- Two practice exams included
- Four months of access to complete the attempt

GIAC Certifications Bundle price: AUD \$1,495

giac.org

SAVE THE DATE

Upcoming SANS Training Events

SEC530 Canberra

Canberra, ACT & Virtual

12–17 May

AUSCERT

Virtual

19–20 May

Cyber Defence Canberra

Canberra, ACT & Virtual

23 June–5 July

Melbourne

Melbourne, VIC & Virtual

18–23 August

Sydney Spring

Sydney, NSW & Virtual

22–27 September

Brisbane

Brisbane, QLD & Virtual

13–18 October

Canberra November Australia

Canberra, ACT & Virtual

10–15 November

Visit our home page for the latest information.

www.sans.org