

# Corewell Health Grand Rapids Hospitals Blodgett Hospital

## Campus Map

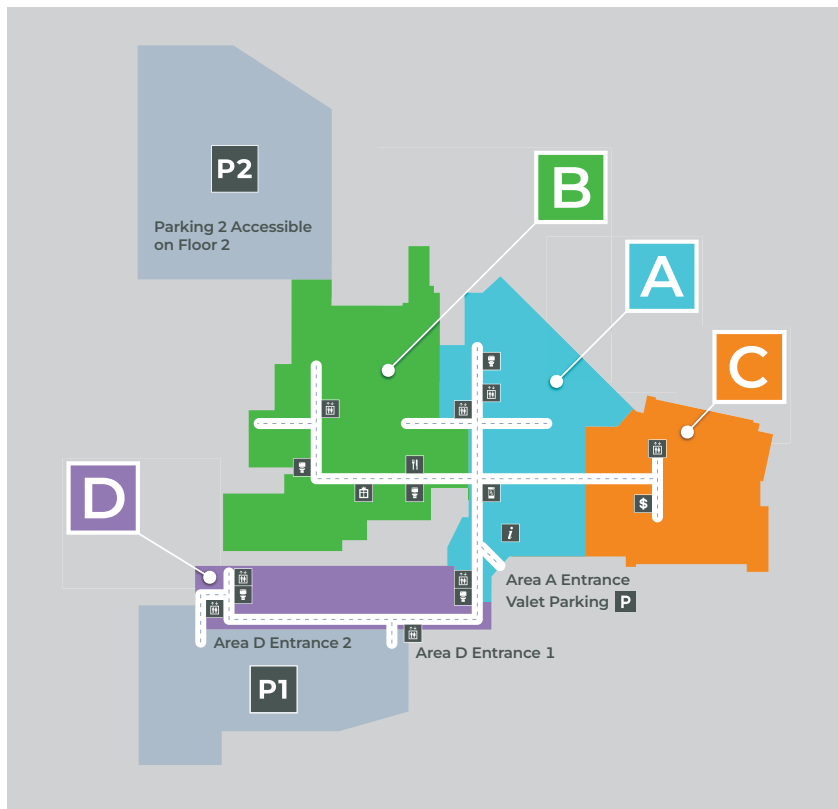



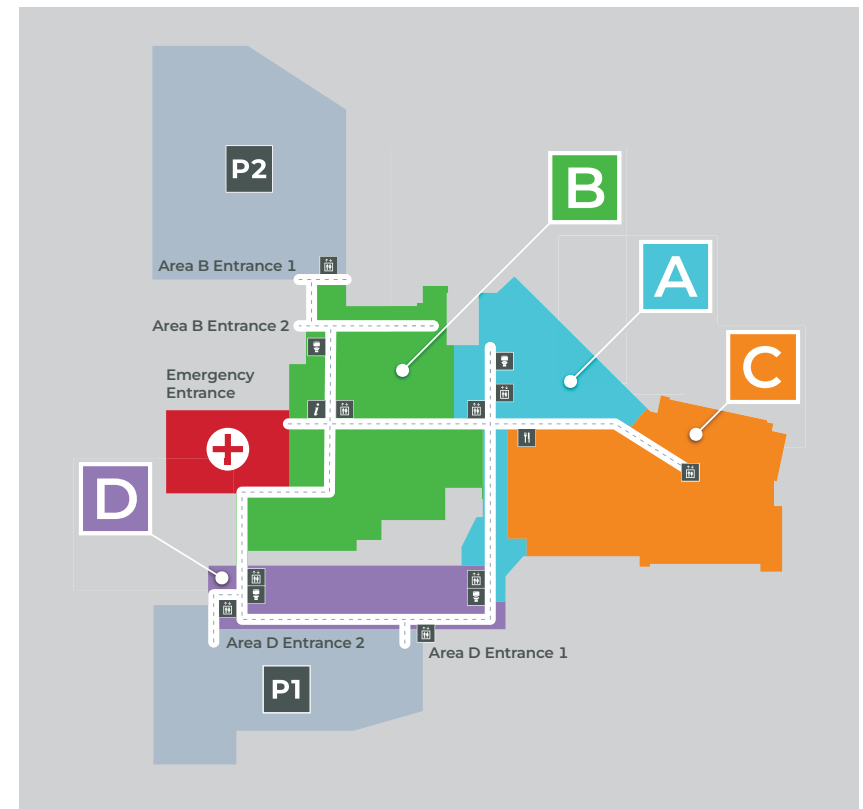

The campus is divided into color coded areas (A-D) for easier navigation. Refer to the directory on the back and follow signs to reach your destination.



**Floor 1**



**Floor 2**

Floor	Description	Floor	Description	Floor	Description
	<b>A Area A</b>		<b>B Area B</b>		<b>C Area C</b>
<b>5</b>	Select Specialty Hospital <b>(Take Elevator 2)</b>	<b>2</b>	Betty Ford Breast Care Services	<b>4</b>	4H Bariatrics/Digestive Diseases
<b>4</b>	4D Medical/Surgical	<b>2</b>	Check-In	<b>4</b>	4G Digestive Diseases
<b>4</b>	4E Medical/Surgical	<b>2</b>	Endoscopy	<b>3</b>	3G Center for Joint Replacement
<b>4</b>	4AB Rehabilitation Unit	<b>2</b>	Imaging:  CT  IR  MRI  Ultrasound  X-ray	<b>3</b>	3H Neuroscience/Spine
<b>3</b>	Joint & Spine Surgery Education			<b>2</b>	Grab & Go 
<b>3</b>	3D Medical/Surgical			<b>2</b>	Surgery
<b>3</b>	3E Orthopedics			<b>2</b>	Surgery Family Waiting
<b>3</b>	3AB Rehabilitation Unit <b>(Take Elevator 2)</b>			<b>1</b>	1H Critical Care
<b>3</b>	3E Orthopedics			<b>1</b>	1G Progressive Care
<b>2</b>	2D Rapid Treatment Unit	<b>2</b>	Infusion Therapy		
<b>1</b>	1D Acute Care of the Elderly	<b>2</b>	Interventional Radiology Clinic		<b>D Area D</b>
<b>1</b>	Discharge Lounge	<b>2</b>	Laboratory	<b>3</b>	The Spine Center, <b>Suite 300</b>
<b>1</b>	Interfaith & Meditation Room	<b>2</b>	Welcome 	<b>2</b>	General Surgery, <b>Suite 250</b>
<b>1</b>	1E Medical/Surgical	<b>1</b>	Conference Rooms	<b>2</b>	Surgical Optimization, <b>Suite 200</b>
<b>1</b>	Pharmacy 	<b>1</b>	Gift Shop 	<b>1</b>	Urology, <b>Suite 100</b>
<b>1</b>	Surgery Check-In	<b>1</b>	Market Avenue Cafeteria 		
<b>1</b>	Welcome 				
				<b>2</b>	<b>+ EMERGENCY</b>