

Compact Face-Frame Hinges

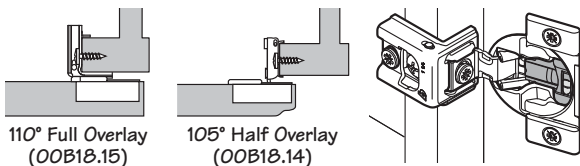

110° Full Overlay
(OOB18.15)

105° Half Overlay
(OOB18.14)

Installation

For use on standard door thicknesses from 16 mm to 24 mm (5/8" to 15/16").

Note: Be sure to follow the instructions appropriate for the hinge style you have purchased.

Recommended number of hinges:

- Doors up to 500 × 700 mm (20" × 28") – one pair per door
- Doors up to 500 × 1500 mm (20" × 60") – 3 hinges per door
- Doors up to 500 × 2000 mm (20" × 80") – 4 hinges per door

Extra-heavy doors (e.g., doors with mirrors) may require extra hinges. A 35mm drill bit is required.

Mark center of 35mm hole to be drilled 20.5mm from door edge.

Drill hole minimum depth 13mm. Drill pilot holes for #6 screws (3mm diameter) as shown in **Figure 1**. Drill a 1/8" diameter pilot hole in the face frame, as shown.

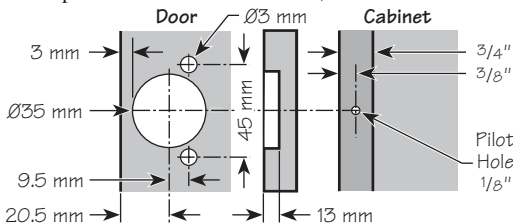

Figure 1: Hole locations.

Fasten the mounting plate to the cabinet, insert the hinge cup into the hole in the door, and then fasten the hinge cup to the door. (See **Figure 2** or **3**, according to the hinge style you have purchased.)

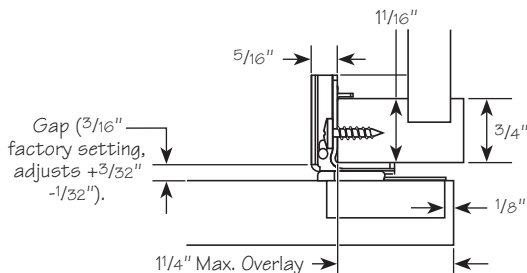

Figure 2: 110° Full-overlay hinges (OOB18.15).

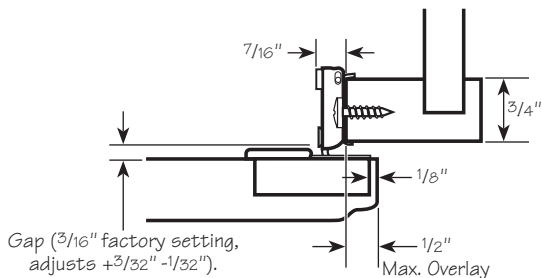

Figure 3: 105° Half-overlay hinges (OOB18.14).

Adjustments

Side Adjustment: Rotate screw #1 counterclockwise to increase the door overlay; clockwise to decrease it. Range of motion is 3 mm (1/8").

Height Adjustment: Loosen screw #2 on all hinges, adjust door position and retighten screw. Range of adjustment is 6 mm (1/4").

Depth Adjustment: Loosen screw #3 on all hinges, adjust door to desired depth, and retighten screw. Range of adjustment is 3 mm (1/8").

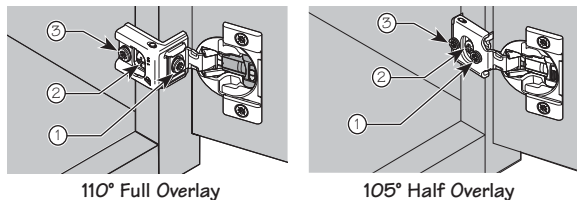

Figure 4: Hinge adjustment.

Deactivating the Soft-Close Mechanism

These hinges have a spring-loaded soft-close mechanism. For small or light doors, this can be deactivated on one or more of the hinges as necessary by sliding the switch shown in **Figure 5** up, and then closing the door. The “activated” switch position is marked with an “I”.

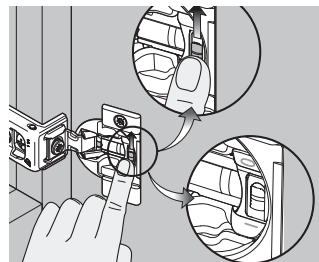

Figure 5: Deactivating the soft-close mechanism.

Complete the hinge installation by snapping the screw cover onto the mounting plate.