

Hand-Crank Chain-Saw Sharpener

(75U05.01)

The following instructions were provided by the manufacturer.

PLEASE READ BEFORE USE

Chainsaws are dangerous. Always use caution when handling. Wear gloves to prevent injury. Be sure chainsaw is turned off, unplugged if electric, and cooled down before sharpening.

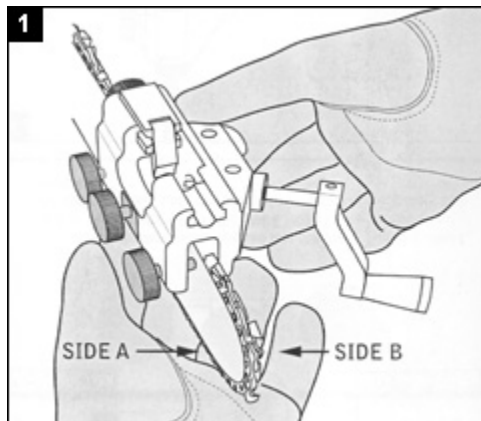
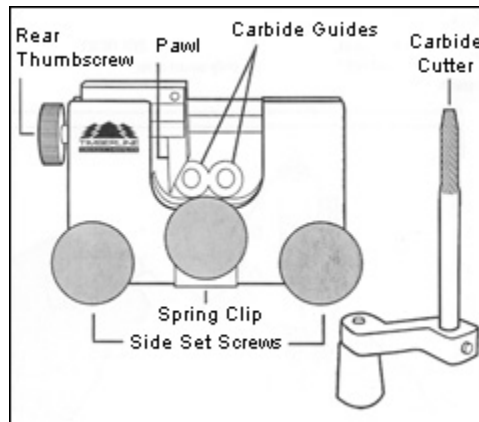

1 Place chainsaw on flat surface pointing towards you. Place tool on saw with side set screws on side A. Make sure these are loosened.

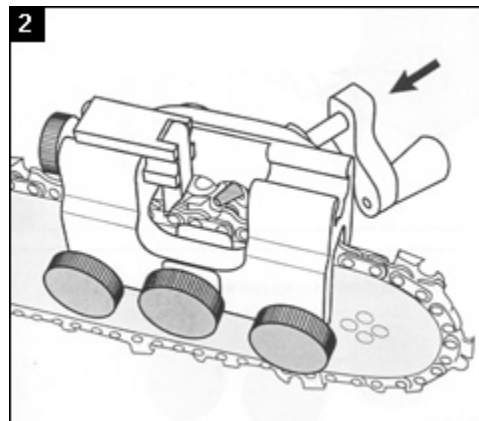

2 Insert carbide cutter into guide and align into a chain cutting tooth.

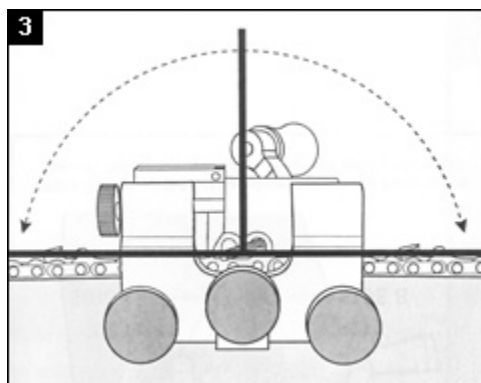

3 The carbide should now be inserted into the guide. The tool should rock on the carbide. FIND BALANCE POINT where neither end of tool touches chain. Lock this position by tightening the 2 outer side set screws.

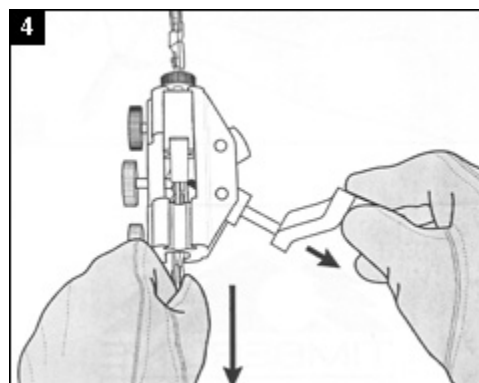

4 Pull out carbide. Pull chain forward to test that it moves freely through tool. If not, repeat step 3 and find correct balance point.

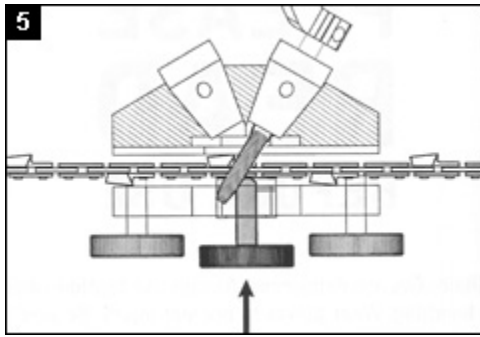

Reinsert carbide into guide and chain tooth. Tighten middle side set screw to apply *slight* side pressure via the spring clip to keep the chain vertical if needed.

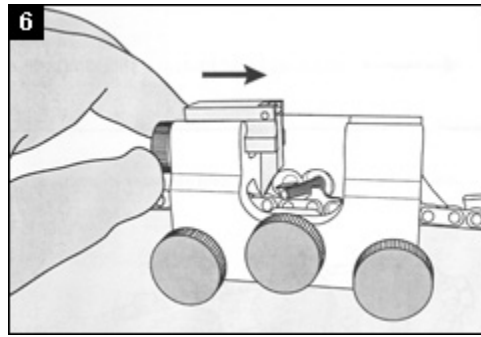

Tighten the Rear Thumbscrew until the Pawl pushes against the chain's tooth.

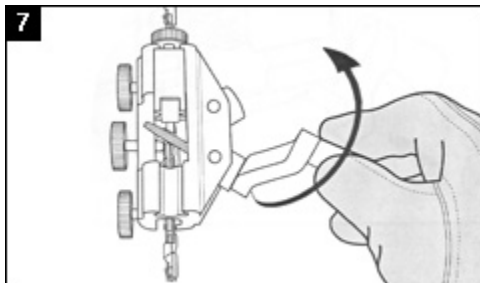

Pull carbide out and tighten rear thumbscrew approx. 1/4 turn (this adjustment controls the amount of material shaved from the chain tooth). Turn the handle and push the carbide completely into the tooth.

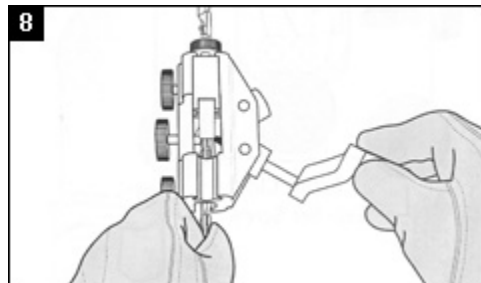

Pull carbide out and pull chain forward to sharpen the next tooth. The thumbscrew should not be adjusted again. This insures all teeth are sharpened the same amount making the entire chain uniform and precise.

* Turn the handle clockwise - NEVER COUNTERCLOCKWISE. Carbide should not bind and shave only small amount off chain's tooth.
